



PRE-RENOVATION ASBESTOS INSPECTION AND SAMPLING REPORT

**Marcia P. Coggs Human Services Center
Asset #5600
1220 W Vliet St.
Milwaukee, WI, 53205-2117.**

Prepared by:

LF Green Development, LLC
5600 W. Brown Deer Road, Suite 104
Milwaukee, Wisconsin 53223

Prepared for:

Mr. Kevin O'Brien
Env. Compliance Manager
Milwaukee County DAS-AE & ES
633 W. Wisconsin Ave. Suite 1003
Milwaukee, WI 53203

March 16, 2022

SUBMITTAL CERTIFICATION

Asbestos Inspection and Sampling Report
Marcia P. Coggs Human Services Center, Asset #5600
1220 W Vliet St.
Milwaukee, WI, 53205-2117.

I, ROBB DIEKFUSS, hereby certify that I am a licensed Asbestos Inspector as defined by the State of Wisconsin Department of Health and Family Services, Certification # AII-122796, licensed Asbestos Supervisor, Certification # ACS-122796.

Robb Diekfuss
Robb Diekfuss
Asbestos Supervisor

March 16, 2022
Date

I, SARAH GANSWINDT, hereby certify that I am a licensed Asbestos Inspector as defined by the State of Wisconsin Department of Health and Family Services, Certification # AII-103433, licensed Asbestos Supervisor, Certification # ACS-103433.

Sarah Ganswindt
Sarah Ganswindt
Asbestos Supervisor

March 16, 2022
Date

I, LINDA J. FELLEENZ, hereby certify that I am a licensed Asbestos Inspector as defined by the State of Wisconsin Department of Health and Family Services, Certification # AII-15354, licensed Asbestos Supervisor, Certification # ACS-15354, Asbestos Management Planner, Certification # AMP-15354, Lead Hazard Investigator # LHI, and Lead Risk Assessor # LRA 15354

Linda J. Fellenz
Linda J. Fellenz
Asbestos Supervisor

March 16, 2022
Date

Mr. Kevin O'Brien
Env. Compliance Manager
Milwaukee County DAS-AE & ES
633 W. Wisconsin Ave. Suite 1003
Milwaukee, WI 53203

Subject: Asbestos Inspection and Sampling Report
Marcia P. Coggs Human Services Center, Asset #5600
1220 W Vliet St.
Milwaukee, WI, 53205-2117.

From February 2-8, an asbestos inspection was conducted at 1220 W. Vliet, WI. The inspection was completed prior to the planned renovation of the building.

ASBESTOS INSPECTION:

All asbestos containing materials (ACM), which are materials containing greater than 1% asbestos, friable and non-friable materials in poor condition or on substrates that will be recycled, need to be removed prior to any renovations to the buildings. Appropriate regulations need to be followed for asbestos removal, including but not limited to: notifications to the WI Department of Health and Family Services, WI Department of Natural Resources, and compliance with OSHA regulations, as well as the use of certified contractors.

Any suspect materials that have not been sampled and analyzed that are found during the course of renovation or demolition need to be treated as asbestos until analyzed by the laboratory.

This survey was conducted in order to confirm the presence of asbestos-containing materials (ACMs). Asbestos Laboratory Results are included in Appendix B.

Materials are considered to be Regulated ACM (RACM) if the material is comprised of more than 1% asbestos fibers. Suspect materials are any material not comprised of glass, wood, or metal.

All asbestos containing materials, friable and non-friable materials in poor condition or on substrates that will be recycled, need to be removed prior to any renovation activities.

Category 1 Non-Friable materials, as defined in 40 CFR Part 61 Subpart M, include asbestos containing packing, gaskets, resilient floor coverings, and asphalt roofing products. These materials, due to their extremely low probability of fiber release when damaged, are not required to be removed prior to demolition activities if they are in good condition and not friable (40 CFR 61.145 (c)(1)(i)). However, if structures are slated for demolition by intentional burning, all ACMs must be removed prior to burning, in compliance with 40 CFR 61.145 (c)(10).

PROJECT SCOPE

This Asbestos Inspection (survey) was conducted by a Wisconsin Department of Health Services (DHS) licensed Asbestos Inspector to locate and identify ACMs used in construction.

The survey was conducted in accordance with the applicable regulations and general guidelines set forth in DHS NR 159 and EPA's Asbestos Hazardous Emergency Response Act (AHERA) and rules promulgated under 40 CFR 763, Subpart E. These guidelines are also referenced in Occupational Safety and Health Administration (OSHA), 29 CFR 1926.1101, which are designed to protect workers during demolition or renovation of buildings/structures containing ACMs.

The EPA's National Emission Standard for Asbestos, promulgated under 40 CFR Part 61 Subpart M, is also applicable when a potential of air emissions of ACMs exists during renovation and/or demolition activities.

Appropriate regulations need to be followed for asbestos removal, including but not limited to: notifications to the WI Department of Health and Family Services, WI Department of Natural Resources (WDNR), and compliance with OSHA regulations, as well as the use of certified contractors.

The project scope-of-work included the following tasks:

- Review of available construction plans and previous asbestos surveys;
- An ACM survey including the collection of bulk samples of suspect ACM using the EPA's Asbestos Hazard Emergency Response Act (AHERA) as guidance;
- Polarized Light Microscopy (PLM) Analysis of bulk samples;
- Preparation of a survey report, including methodologies, findings, conclusions, and recommendations.

SURVEY METHODS AND LABORATORY ANALYSIS

Ms. Sarah Ganswindt, (AIS #103433) and/or, Ms. Linda Fellenz (AII 15354), and/ or Mr. Robb Diekfuss (AII-122796), State of Wisconsin DHS certified Asbestos Inspectors conducted the asbestos inspection on February 2-8, 2022. DHS credentials are included in Appendix A.

The inspection was performed in general compliance with WI DHS NR 159, WI WDNR NR 447, 40 CFR 763.85-86, and other recommended EPA asbestos survey practices. The survey included a thorough visual review of the condition, location, and descriptions of any suspect ACMs.

The bulk sampling procedure utilized for the collection of samples suspected of being ACMs required the establishment of homogeneous sampling areas. A homogeneous sampling area is defined as an area of friable or non-friable material of similar type that appeared to be applied or constructed during the same general period of time. Any conditions or materials that were not readily visible and accessible were not sampled and may differ from those observed. Contractors working with in the structures should be made aware of the possibility of concealed suspect ACMs that could be found during construction activities. Any concealed materials discovered during site activities, which are suspected to contain asbestos, should be sampled and analyzed to confirm the presence of asbestos prior to disturbing such materials.

Any suspect materials that have not been sampled and analyzed that are found during the course of renovation or demolition are required to be treated as ACM until analyzed by a National Voluntary Laboratory Accreditation Program (NVLAP) certified asbestos laboratory.

Samples, locations and results are listed below:

Sample #	Description	Location	Results	Quantity
1a	Floor Tile – Tan	Cafeteria floor	None Detected	NA
1a-m	Mastic – Black	Cafeteria floor	None Detected	Same as 1a
1b	Floor Tile – Tan	Cafeteria floor	None Detected	Same as 1a
1b-m	Mastic – Black	Cafeteria floor	None Detected	Same as 1a
1c	Floor Tile – Tan	Cafeteria floor	None Detected	Same as 1a
1c-m	Mastic – Black	Cafeteria floor	None Detected	Same as 1a
2a	Insulation – Gray	Cafeteria floor adjacent to sink	None Detected	NA
2b	Insulation – Gray	Cafeteria floor adjacent to sink	None Detected	Same as 2a
2c	Insulation – Gray	Cafeteria floor adjacent to sink	None Detected	Same as 2a
3a	Floor Tile – Red	Cafeteria floor	None Detected	NA
3a-m	Mastic – Black	Cafeteria floor	None Detected	Same as 3a
3b	Floor Tile – Red	Cafeteria floor	None Detected	Same as 3a
3b-m	Mastic – Black	Cafeteria floor	None Detected	Same as 3a
3c	Floor Tile – Red	Cafeteria floor	None Detected	Same as 3a
3c-m	Mastic – Black	Cafeteria floor	None Detected	Same as 3a
4a	Insulation – Gray	Terrazzo cafeteria adjacent to sink	None Detected	NA
4b	Insulation – Gray	Terrazzo cafeteria adjacent to sink	None Detected	Same as 4a
4c	Insulation – Gray	Terrazzo cafeteria adjacent to sink	None Detected	Same as 4a
5a	Adhesive – Tan	Cafeteria base cove	None Detected	NA
5b	Adhesive – Tan	Cafeteria base cove	None Detected	Same as 5a
5c	Adhesive – Tan	Cafeteria base cove	None Detected	Same as 5a

5d	Adhesive – Tan	Cafeteria base cove	None Detected	Same as 5a
5e	Adhesive – Tan	Cafeteria base cove	None Detected	Same as 5a
6a	Ceiling Tile – Gray	Cafeteria – SW Corner	None Detected	NA
6b	Ceiling Tile – Gray	Cafeteria – SW Corner	None Detected	Same as 6a
6c	Ceiling Tile – Gray	Cafeteria – SW Corner	None Detected	Same as 6a
7a	Insulation – Black/Brown	Cafeteria – above ceiling tile black paint – SW corner	None Detected	5,300 sq. ft.
7b	Insulation – Black/Brown	Cafeteria – above ceiling tile black paint – SW corner	None Detected	Same as 7a
7c	Insulation – Black/Brown	Cafeteria – above CT black paint – SW corner	None Detected	Same as 7a
8a	Glue – Brown	Cafeteria – above ceiling tile black paint – SW corner	None Detected	NA
8b	Glue – Brown	Cafeteria – above ceiling tile black paint – SW corner	None Detected	Same as 8a
8c	Glue – Brown	Cafeteria – above ceiling tile black paint – SW corner	None Detected	Same as 8a
8d	Glue – Brown	Cafeteria – above ceiling tile black paint – SW corner	None Detected	Same as 8a
8e	Glue – Brown	Cafeteria – above ceiling tile black paint – SW corner	None Detected	Same as 8a
8f	Glue – Brown	Cafeteria – above ceiling tile black paint – SW corner	None Detected	Same as 8a
8g	Glue – Brown	Cafeteria – above ceiling tile black paint – SW corner	None Detected	Same as 8a
9a	Ceiling Tile – Gray	Cafeteria – hallway room B38A – Pin hole ceiling tile	None Detected	150 Sq. Ft.
9b	Ceiling Tile – Gray	Cafeteria – hallway room B38A – Pin hole ceiling tile	None Detected	Same as 9a
9c	Ceiling Tile – Gray	Cafeteria – hallway room B38A – Pin hole ceiling tile	None Detected	Same as 9a
10a	Ceiling Material – Black/Brown	Above ceiling tile cafeteria	None Detected	NA
10b	Ceiling Material – Black/Brown	Above ceiling tile cafeteria	None Detected	Same as 10a
10c	Ceiling Material – Black/Brown	Above ceiling tile cafeteria	None Detected	Same as 10a
11a	Texture – Black/White	Room B29 ceiling	None Detected	NA

11b	Texture – Black/White	Room B29 ceiling	None Detected	Same as 11a
11c	Texture – Black/White	Room B29 ceiling	None Detected	Same as 11a
11d	Texture – Black/White	Room B29 ceiling	None Detected	Same as 11a
11e	Texture – Black/White	Room B29 ceiling	None Detected	Same as 11a
12a	Linoleum – Gray	Ramp	None Detected	NA
12b	Linoleum – Gray	Ramp	None Detected	Same as 12a
12c	Linoleum – Gray	Ramp	None Detected	Same as 12a
13a	Glue – Tan	Room 104	None Detected	NA
13b	Glue – Tan	Room 104	None Detected	Same 13a
13c	Glue – Tan	Room 104	None Detected	Same as 13a
14a	Ceiling Tile – Silver/Grey	Drop ceiling tile	None Detected	NA
14b	Ceiling Tile – Silver/Grey	Drop ceiling tile	None Detected	Same as 14a
14c	Ceiling Tile – Silver/Grey	Drop ceiling tile	None Detected	Same as 14a
15a	Cove base – Black	Room 104	None Detected	NA
15a-g	Glue – Yellow	Room 104	None Detected	Same as 15a
15b	Cove base – Black	Room 104	None Detected	Same as 15a
15b-g	Glue – Yellow	Room 104	None Detected	Same as 15a
15c	Cove base – Black	Room 104	None Detected	Same as 15a
15c-g	Glue – Yellow	Room 104	None Detected	Same as 15a
16a	Floor Tile – Gray	Adjacent to elevator	None Detected	NA
16a-m	Mastic – Black	Adjacent to elevator	None Detected	Same as 16a
16b	Floor Tile – Gray	Adjacent to elevator	None Detected	Same as 16a
16b-m	Mastic – Black	Adjacent to elevator	None Detected	Same as 16a

16c	Floor Tile – Gray	Adjacent to elevator	None Detected	Same as 16a
16c-m	Mastic – Black	Adjacent to elevator	None Detected	Same as 16a
17a	Ceramic Tile – Beige	Men’s room	None Detected	NA
17a-g	Grout – Gray	Men’s room	None Detected	Same as 17a
17b	Ceramic Tile – Beige	Men’s room	None Detected	Same as 17a
17b-g	Grout – Gray	Men’s room	None Detected	Same as 17a
17c	Ceramic Tile – Beige	Men’s room	None Detected	Same as 17a
17c-g	Grout – Gray	Men’s room	None Detected	Same as 17a
18a	Ceramic Tile – Gray	Men’s room wall	None Detected	NA
18a-g	Grout - White	Men’s room wall	None Detected	Same as 18a
18b	Ceramic Tile – Gray	Men’s room wall	None Detected	Same as 18a
18b-g	Grout - White	Men’s room wall	None Detected	Same as 18a
18c	Ceramic Tile – Gray	Men’s room wall	None Detected	Same as 18a
18c-g	Grout - White	Men’s room wall	None Detected	Same as 18a
18d	Ceramic Tile – Gray	Men’s room wall	None Detected	Same as 18a
18d-g	Grout - White	Men’s room wall	None Detected	Same as 18a
18e	Ceramic Tile – Gray	Men’s room wall	None Detected	Same as 18a
18e-g	Grout - White	Men’s room wall	None Detected	Same as 18a
18f	Ceramic Tile – Gray	Men’s room wall	None Detected	Same as 18a
18f-g	Grout - White	Men’s room wall	None Detected	Same as 18a
19a	Cove Base – Tan/Brown	Conference room 104	None Detected	NA
19a-a	Adhesive – Gray	Conference room 104	None Detected	Same as 19a
19b	Cove Base – Tan/Brown	Conference room 104	None Detected	Same as 19a

19b-a	Adhesive – Gray	Conference room 104	None Detected	Same as 19a
19c	Cove Base – Tan/Brown	Conference room 104	None Detected	Same as 19a
19c-a	Adhesive – Gray	Conference room 104	None Detected	Same as 19a
20a	Floor Tile – Cream	Break room / Vending area	None Detected	500 sq. ft.
20a-g	Glue – Black/Brown	Break room / Vending area	None Detected	Same as 20a
20b	Floor Tile – Cream	Break room / Vending area	None Detected	Same as 20a
20b-g	Glue – Black/Brown	Break room / Vending area	None Detected	Same as 20a
20c	Floor Tile – Cream	Break room / Vending area	None Detected	Same as 20a
20c-g	Glue – Black/Brown	Break room / Vending area	None Detected	Same as 20a
21a	Floor Tile – Gray	Break room / Vending area	None Detected	NA
21a-m	Mastic – Black	Break room / Vending area	POSITIVE 5% CHRYSTILE	500 sq. ft.
21b	Floor Tile – Gray	Break room / Vending area	None Detected	500 sq. ft.
*21b-m	Mastic – Black	Break room / Vending area	POSITIVE 5% CHRYSTILE	500 sq. ft.
21c	Floor Tile – Gray	Break room / Vending area	None Detected	500 sq. ft.
*21c-m	Mastic – Black	Break room / Vending area	POSITIVE 5% CHRYSTILE	500 sq. ft.
2nd Floor				
22a	Ceiling Tile – Gray	2 nd floor	None Detected	NA
22b	Ceiling Tile – Gray	2 nd floor	None Detected	Same as 22a
22c	Ceiling Tile – Gray	2 nd floor	None Detected	Same as 22a
23a	Glue – Tan	Post	None Detected	NA
23b	Glue – Tan	Post	None Detected	Same as 23a
23c	Glue – Tan	Post	None Detected	Same as 23a

24a	Ceiling Tile – Gray	Office 200D	None Detected	NA
24b	Ceiling Tile – Gray	Office 200D	None Detected	Same as 24a
24c	Ceiling Tile – Gray	Office 200D	None Detected	Same as 24a
25a	Carpet glue/mastic	Under carpet in waiting area	None Detected	NA
25b	Carpet glue/mastic	Under carpet in waiting area	None Detected	Same as 25a
25c	Carpet glue/mastic	Under carpet in waiting area	None Detected	Same as 25a
26a	Carpet glue/mastic	Under carpet in waiting area	None Detected	NA
26b	Carpet glue/mastic	Under carpet in waiting area	None Detected	Same as 26a
26c	Carpet glue/mastic	Under carpet in waiting area	None Detected	Same as 26a
27a	Floor Tile – Brown	Adjacent to vending machine (already damaged)	None Detected	NA
27a-m	Mastic – Black	Adjacent to vending machine (already damaged)	None Detected	Same as 27a
27b	Floor Tile – Brown	Adjacent to vending machine (already damaged)	None Detected	Same as 27a
27b-m	Mastic – Black	Adjacent to vending machine (already damaged)	None Detected	Same as 27a
27c	Floor Tile – Brown	Adjacent to vending machine (already damaged)	None Detected	Same as 27a
27c-m	Mastic – Black	Adjacent to vending machine (already damaged)	None Detected	Same as 27a
28a	Floor Tile – Brown	Break room	None Detected	NA
28a-m	Mastic – Black	Break room	None Detected	Same as 28a
28b	Floor Tile – Brown	Break room	None Detected	Same as 28a
28b-m	Mastic – Black	Break room	None Detected	Same as 28a
28c	Floor Tile – Brown	Break room	None Detected	Same as 28a
28c-m	Mastic – Black	Break room	None Detected	Same as 28a
29a	Pipe insulation above ceiling tile	Small pipe run in breakroom	POSITIVE 10% AMOSITE	20'

*29b	Pipe insulation above ceiling tile	Small pipe run in breakroom	POSITIVE 10% AMOSITE	Same as 29a
*29c	Pipe insulation above ceiling tile	Small pipe run in breakroom	POSITIVE 10% AMOSITE	Same as 29a
30a	Floor Tile – Blue	Breakroom area	None Detected	NA
30a-m	Mastic – Black	Breakroom area	None Detected	Same as 30a
30b	Floor Tile – Blue	Breakroom area	None Detected	Same as 30a
30b-m	Mastic – Black	Breakroom area	None Detected	Same as 30a
30c	Floor Tile – Blue	Breakroom area	None Detected	Same as 30a
30c-m	Mastic – Black	Breakroom area	None Detected	Same as 30a
31a	Floor Tile – Orange	Orange tile in corridor 2 nd floor	None Detected	NA
31a-m	Mastic – Black	Under Orange tile in corridor 2 nd floor	None Detected	Same as 31a
31b	Floor Tile – Orange	Orange tile in corridor 2 nd floor	None Detected	Same as 31a
31b-m	Mastic – Black	Under Orange corridor	None Detected	Same as 31a
31c	Floor Tile – Orange	Orange tile in corridor 2 nd floor	None Detected	Same as 31a
31c-m	Mastic – Black	Under Orange corridor	None Detected	Same as 31a
32a	Floor Tile – White	White corridor in corridor	None Detected	NA
32a-m	Mastic – Black	White corridor	None Detected	Same as 32a
32b	Floor Tile – White	White corridor in corridor	None Detected	Same as 32a
32b-m	Mastic – Black	White corridor	None Detected	Same as 32a
32c	Floor Tile – White	By escalator (already damaged)	None Detected	Same as 32a
32c-m	Mastic – Black	By escalator (already damaged)	None Detected	Same as 32a
33a	Floor Tile – Brown	By escalator (already damaged)	None Detected	NA
33a-m	Mastic – Black	By escalator (already damaged)	None Detected	Same as 33a

33b	Floor Tile – Brown	By escalator (already damaged)	None Detected	Same as 33a
33b-m	Mastic – Black	By escalator (already damaged)	None Detected	Same as 33a
33c	Floor Tile – Brown	By escalator (already damaged)	None Detected	Same as 33a
33c-m	Mastic – Black	By escalator (already damaged)	None Detected	Same as 33a
3rd Floor				
34a	Ceiling Tile - White	304G swirl pattern	None Detected	NA
34b	Ceiling Tile - White	304G swirl pattern	None Detected	Same as 34a
34c	Ceiling Tile - White	304G swirl pattern	None Detected	Same as 34a
35a	Ceiling Tile – White	301A Swirl pattern	None Detected	NA
35b	Ceiling Tile - White	301A Swirl pattern	None Detected	Same as 35a
35c	Ceiling Tile - White	301A Swirl pattern	None Detected	Same as 35a
36a	Tile – Beige	Conference room # 305	None Detected	NA
36a-m	Mastic – Brown	Conference room # 305	None Detected	Same as 36a
36b	Tile – Beige	Conference room # 305	None Detected	Same as 36a
36b-m	Mastic – Brown	Conference room # 305	None Detected	Same as 36a
36b-c	Cementitious Material – Gray	Conference room # 305	None Detected	Same as 36a
36c	Tile – Beige	Conference room # 305	None Detected	Same as 36a
36c-m	Mastic – Brown	Conference room # 305	None Detected	Same as 36a
37a	Tile – Grey	Janitor closet wall	None Detected	NA
37a-a	Adhesive – Brown	Janitor closet wall	None Detected	Same as 37a
37a-g	Grout – Gray	Janitor closet wall	None Detected	Same as 37a
37b	Tile – Grey	Janitor closet wall	None Detected	Same as 37a
37b-a	Adhesive – Brown	Janitor closet wall	None Detected	Same as 37a

37c	Tile – Grey	Janitor closet wall	None Detected	Same as 37a
37c-c	Adhesive – Brown	Janitor closet wall	None Detected	Same as 37a
38a	Fibrous Material - White	Janitor closet	None Detected	NA
38b	Fibrous Material - White	Janitor closet	None Detected	Same as 38a
38c	Fibrous Material - White	Janitor closet	None Detected	Same as 38a
39a	Tile – Brown	By escalator	None Detected	NA
39a-m	Mastic – Gray	By escalator	None Detected	Same as 39a
39b	Tile – Brown	By escalator	None Detected	Same as 39a
39b-m	Mastic – Gray	By escalator	None Detected	Same as 39a
39c	Tile – Brown	By escalator	None Detected	Same as 39a
39c-m	Mastic – Gray	By escalator	None Detected	Same as 39a
40a	Tile – Blue	3 rd floor corridor	None Detected	NA
40a-m	Mastic – Black	3 rd floor corridor	None Detected	Same as 40a
40b	Tile – Blue	3 rd floor corridor	None Detected	Same as 40a
40b-m	Mastic – Black	3 rd floor corridor	None Detected	Same as 40a
40c	Tile – Blue	3 rd floor corridor	None Detected	Same as 40a
40c-m	Mastic – Black	3 rd floor corridor	None Detected	Same as 40a
41a	Tile – White	3 rd floor corridor	None Detected	NA
41a-m	Mastic – Black	3 rd floor corridor	None Detected	Same as 41a
41b	Tile – White	3 rd floor corridor	None Detected	Same as 41a
41b-m	Mastic – Black	3 rd floor corridor	None Detected	Same as 41a
41c	Tile – White	3 rd floor corridor	None Detected	Same as 41a
41c-m	Mastic – Black	3 rd floor corridor	None Detected	Same as 41a

42a	Tile – Red	3 rd floor corridor	None Detected	NA
42a-m	Mastic – Black	3 rd floor corridor	None Detected	Same as 42a
42b	Tile – Red	3 rd floor corridor	None Detected	Same as 42a
42b-m	Mastic – Black	3 rd floor corridor	None Detected	Same as 42a
42c	Tile – Red	3 rd floor corridor	None Detected	Same as 42a
42c-m	Mastic – Black	3 rd floor corridor	None Detected	Same as 42a
43a	Cementitious Material – Gray	302G, 302C & 302A	None Detected	NA
43b	Cementitious Material – Gray	302G, 302C & 302A	None Detected	Same as 43a
43c	Cementitious Material – Gray	302G, 302C & 302A	None Detected	Same as 43b
44a	Cementitious Material – Gray	Insulation pipe (12”-14” in diameter), one pipe running north to south in electrical room	None Detected	40 Ln. Ft.
44b	Cementitious Material – Gray	Insulation pipe (12”-14” in diameter), one pipe running north to south in electrical room	None Detected	Same as 44a
44c	Cementitious Material – Gray	Insulation pipe (12”-14” in diameter), one pipe running north to south in electrical room	None Detected	Same as 44a
45a	Cementitious Material – Gray	Lower level and basement mechanical/electrical room	None Detected	NA
45b	Cementitious Material – Gray	Lower level and basement mechanical/electrical room	None Detected	Same as 45a
45c	Cementitious Material – Gray	Lower level and basement mechanical/electrical room	None Detected	Same as 45a
46a	Cementitious Material – Gray	Lower level & basements	None Detected	NA
46b	Cementitious Material – Gray	Lower level & basements	None Detected	Same as 46a
46c	Cementitious Material – Gray	Lower level & basements	None Detected	Same as 46a
47a	Ceramic Tile – White	NE area of basement (chemical storage/lab)	None Detected	NA
47a-a	Adhesive – Yellow	NE area of basement (chemical storage/lab)	None Detected	Same as 47a
47b	Ceramic Tile – White	NE area of basement (chemical storage/lab)	None Detected	Same as 47a
47b-a	Adhesive – Yellow	NE area of basement (chemical storage/lab)	None Detected	Same as 47a
47c	Ceramic Tile – White	NE area of basement (chemical storage/lab)	None Detected	Same as 47a

47c-a	Adhesive – Yellow	NE area of basement (chemical storage/lab)	None Detected	Same as 47a
48a	Cementitious Material – Gray	Small stairwell landing between lower level sections also small utility	None Detected	NA
48a-c	Ceramic Tile – White	Small stairwell landing between lower level sections also small utility	None Detected	Same as 48a
48b	Cementitious Material – Gray	Small stairwell landing between lower level sections also small utility	None Detected	Same as 48a
48b-c	Ceramic Tile – White	Small stairwell landing between lower level sections also small utility	None Detected	Same as 48a
48c	Cementitious Material – Gray	Small stairwell landing between lower level sections also small utility	None Detected	Same as 48a
48c-c	Ceramic Tile – White	Small stairwell landing between lower level sections also small utility	None Detected	Same as 48a
49a	Cove Base – White	Small stairwell landing SE between lower level sections	None Detected	20 Ln. Ft.
49a-a	Adhesive – Tan	Small stairwell landing SE between lower level sections	None Detected	Same as 49a
49b	Cove Base – White	Small stairwell landing SE between lower level sections	None Detected	Same as 49a
49b-a	Adhesive – Tan	Small stairwell landing SE between lower level sections	None Detected	Same as 49a
49c	Cove Base – White	Small stairwell landing SE between lower level sections	None Detected	Same as 49a
49c-a	Adhesive – Tan	Small stairwell landing SE between lower level sections	None Detected	Same as 49a
50a	Tile – Tan	Lower level cafeteria	None Detected	NA
50b	Tile – Tan	Lower level cafeteria	None Detected	Same as 50a
50b-m	Mastic – Black	Lower level cafeteria	None Detected	Same as 50a
50c	Tile – Tan	Lower level cafeteria	None Detected	Same as 50a
50c-m	Mastic – Black	Lower level cafeteria	None Detected	Same as 50a
51a	Tile – White	Ceiling tile w/foil	None Detected	NA
51b	Tile – White	Ceiling tile w/foil	None Detected	Same as 51a
51c	Tile – White	Ceiling tile w/foil	None Detected	Same as 51b
Total Samples Analyzed: 245				

Notes:

- No ceiling tile in hallways

- Floor tile color white, orange & blue are homogenous in cafeteria 1st floor, 2nd floor, 3rd floor and corridor's

CONCLUSIONS:

- The building was occupied during the inspection.
- NR 447 requires all Regulated Asbestos Containing Material (RACM) be removed from structures prior to demolition or renovation.
- RACM means:
 - Friable asbestos containing material;
 - Category I non-friable ACM that has become friable;
 - Category I non-friable ACM that will be or has been subjected to sanding, grinding, cutting, or abrading; or
 - Category II non-friable ACM that has a high probability of becoming or has become crumbled, pulverized, or reduced to powder by the forces expected to act on the material in the course of demolition or renovation operations regulated by NR 447.
- Quantities are estimated and additional material may be located within walls .
- ACM was found in the mastic in the break room (Samples 21a-m, 21b-m & 21c-m). The mastic is considered Category I Non-Friable asbestos; however, it must be properly abated prior to renovations if the material will be disturbed during renovation activities.
- ACM was found above the ceiling tile in the small pipe run (Samples 29a, 29b & 29c). The pipe insulation is Friable asbestos and must be properly abated prior to renovations if the material will be disturbed during renovation activities.
- Roofing materials were not sampled to protect the integrity of the roof, and are considered positive unless they are sampled;
- If any un-sampled suspect ACM is discovered during renovation activities, they must be considered and treated as asbestos containing unless tested and determined not to contain asbestos.

Laboratory results are included in Appendix B.

Please feel free to call me at 414-254-4813 or email me at lfellenz@lfgreendevlopment.com if you have any questions or comments.

Sincerely,

Linda J. Fellenz

President
LF Green Development

Asbestos Sample Location Map

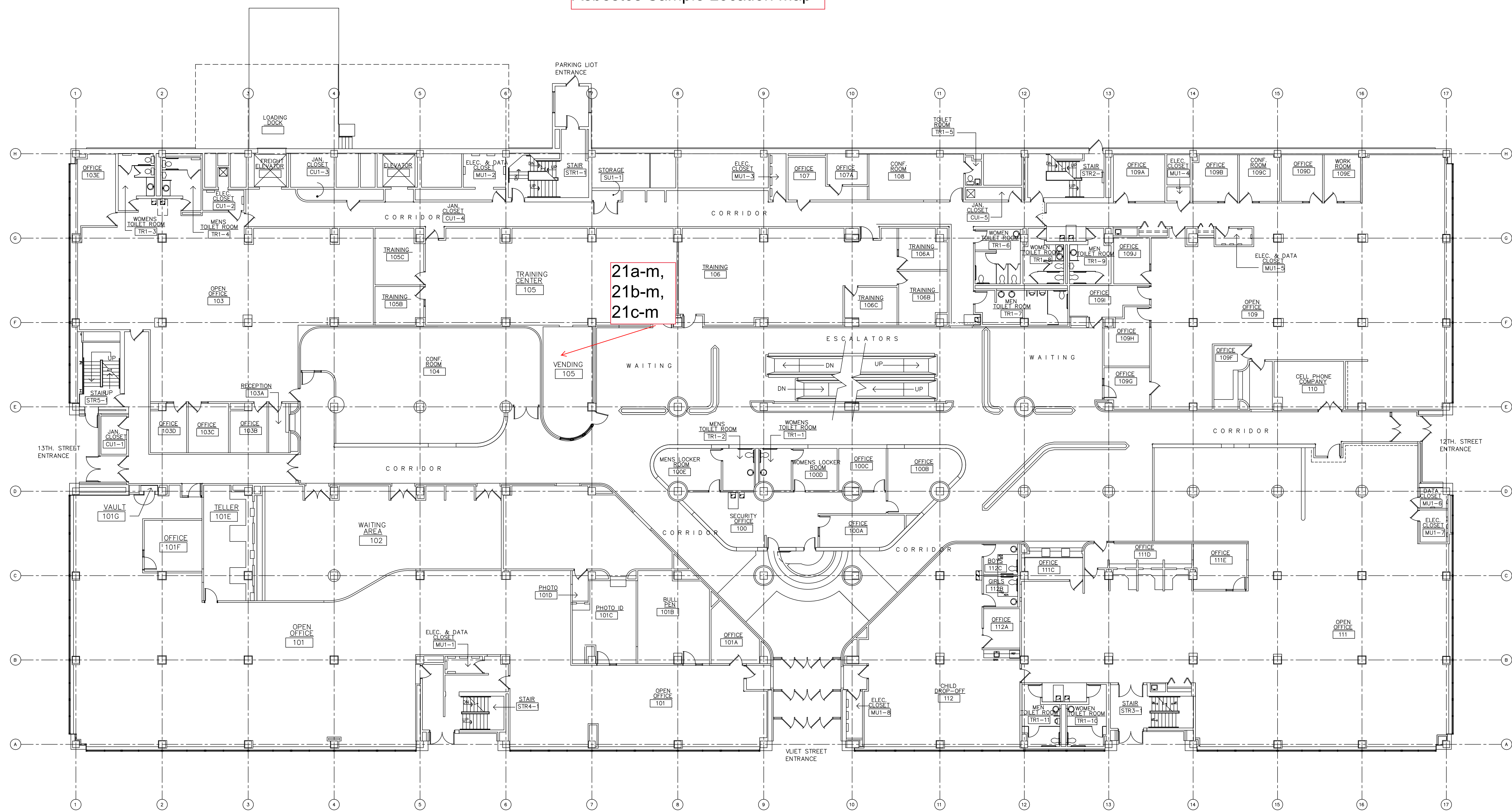

1 FINISH PLAN - FIRST FLOOR
3/32" = 1'-0"



SHEET NO. A-1	PROJECT NO.	SITE NO. 340		PROJECT MILWAUKEE COUNTY – DEPARTMENT OF HUMAN SERVICES TITLE: FINANCIAL ASSISTANCE CENTER 12th. & VULET	SCALE 3/32" = 1'-0"	DRAWN BY:	DESIGN FIRM:	DATE:	REVISION:	DRAWN BY:
		BUILDING NO. 5600								
FILE NO.	SHEET DESCRIPTION: FIRST FLOOR PLAN				MILWAUKEE COUNTY DEPARTMENT OF PARKS AND PUBLIC INFRASTRUCTURE ARCHITECTURE + ENGINEERING AND ENVIRONMENTAL SERVICES SECTION CITY CAMPUS COMPLEX 27th WEST WELLS STREET MILWAUKEE, WISCONSIN 53208					

Asbestos Sample #29 location map

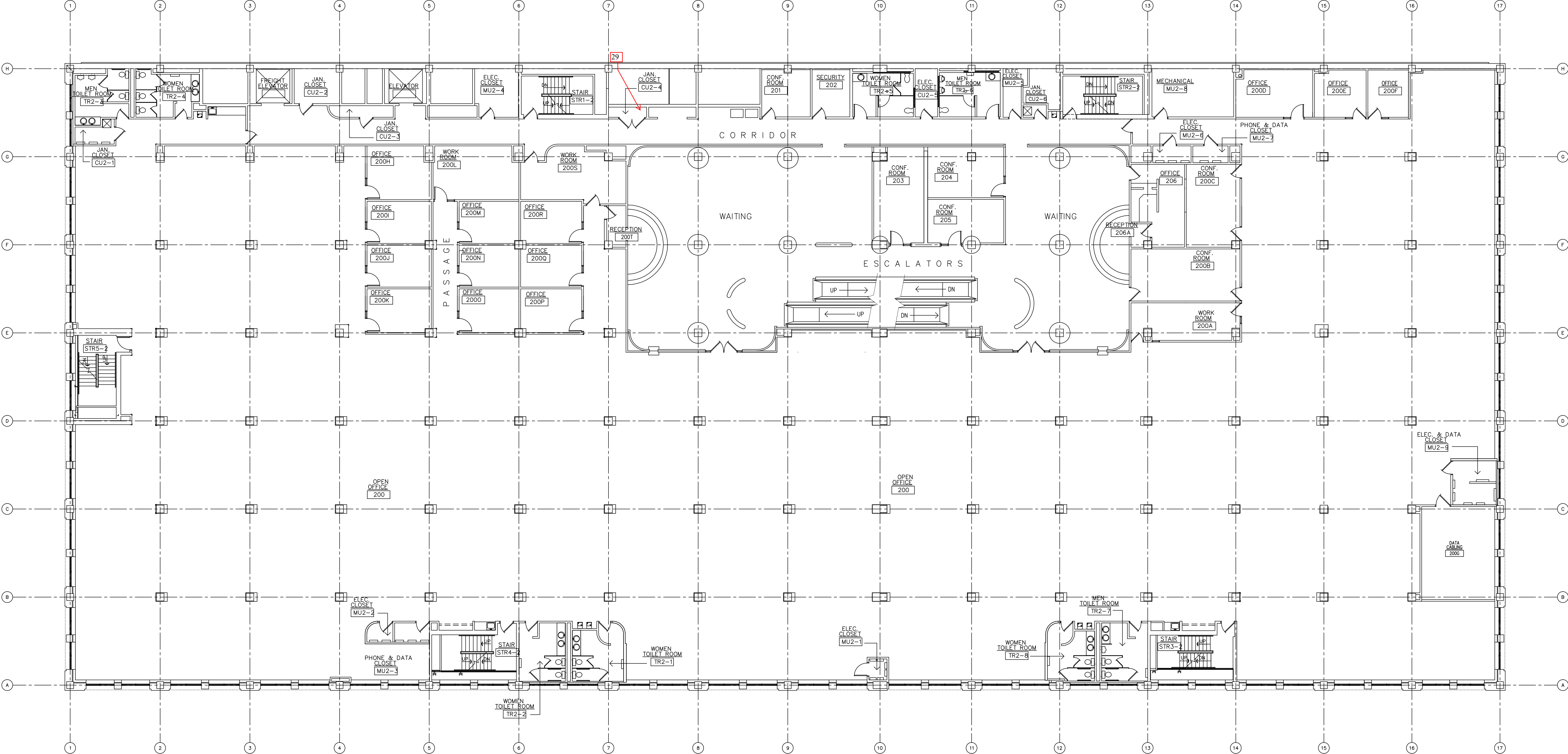

1 FINISH PLAN - SECOND FLOOR
3/32" = 1'-0"



5600 – FINANCIAL ASSISTANCE CENTER

[illegible]

APPENDIX A

LF GREEN WDHS CREDENTIALS

Company Certificate

This certifies that

LF GREEN DEVELOPMENT LLC

5600 W BROWN DEER RD STE 120
MILWAUKEE WI 53223-2346

is certified under ch. DHS 159, Wis.Adm.Code as a

Asbestos Company -- Primary

Certificate Issue Date: 11/23/2020
Expiration Date: 11/20/2022, 12:01 a.m.
Certification #: CAP-902620

Wisconsin Department of Health Services
Division of Public Health
Bureau of Environmental and Occupational Health
Asbestos & Lead Section
PO Box 2659
Madison WI 53701-2659
Phone: (608) 261-6876



Miriam Hasan
Miriam Hasan, Unit Supervisor

ASBESTOS SUPERVISOR

Issued By

STATE OF WISCONSIN

Dept. of Health Services

Sarah Ann Ganswindt

4178 Jackson Dr

Jackson WI 53037-9750



ACS-103433

Exp: 02/05/2022

160 lbs

10/07/1961

5' 07"

Training due by: 02/05/2022

**ASBESTOS INSPECTOR**

Issued By

STATE OF WISCONSIN

Dept. of Health Services

Linda Jo Fellenz

228 Superior Ave

Shoebogyan WI 53081-2956

175 lbs

5' 10"

AII-15354

Exp: 05/14/2022

07/08/1957

Training due by: 05/14/2022

**ASBESTOS MGMT. PLANNER**

Issued By

STATE OF WISCONSIN

Dept. of Health Services

Linda Jo Fellenz

228 Superior Ave

Shoebogyan WI 53081-2956

175 lbs

5' 10"

AMP-15354

Exp: 05/14/2022

07/08/1957

Training due by: 05/14/2022

APPENDIX B

LAB RESULTS – ASBESTOS



**ENVIRONMENTAL TESTING
LABORATORIES, INC.**

37575 W HURON RIVER DRIVE
ROMULUS, MICHIGAN 48174
(734) 955-6600
FAX: (734) 955-6604

To: LF Green Development, LLC
5600 W. Brown Deer Rd. Suite 104
Milwaukee, WI 53224

ETL Job: 245920

Client Project: N/A

Report Date: 2/16/2022

Attention: Linda Fellenz

Project Location: 1220 W Vliet, Milwaukee WI
Coggs Center

Lab Sample Number	Client Sample Number	Sample Type	Completed
1305328	01a	Asbestos	02/16/2022
1305329	01b	Asbestos	02/16/2022
1305330	01c	Asbestos	02/16/2022
1305331	02a	Asbestos	02/16/2022
1305332	02b	Asbestos	02/16/2022
1305333	02c	Asbestos	02/16/2022
1305334	03a	Asbestos	02/16/2022
1305335	03b	Asbestos	02/16/2022
1305336	03c	Asbestos	02/16/2022
1305337	04a	Asbestos	02/16/2022
1305338	04b	Asbestos	02/16/2022
1305339	04c	Asbestos	02/16/2022
1305340	05a	Asbestos	02/16/2022
1305341	05b	Asbestos	02/16/2022
1305342	05c	Asbestos	02/16/2022
1305343	05d	Asbestos	02/16/2022
1305344	05e	Asbestos	02/16/2022

Lab Sample Number	Client Sample Number	Sample Type	Completed
1305345	06a	Asbestos	02/16/2022
1305346	06b	Asbestos	02/16/2022
1305347	06c	Asbestos	02/16/2022
1305348	07a	Asbestos	02/16/2022
1305349	07b	Asbestos	02/16/2022
1305350	07c	Asbestos	02/16/2022
1305351	08a	Asbestos	02/16/2022
1305352	08b	Asbestos	02/16/2022
1305353	08c	Asbestos	02/16/2022
1305354	08d	Asbestos	02/16/2022
1305355	08e	Asbestos	02/16/2022
1305356	08f	Asbestos	02/16/2022
1305357	08g	Asbestos	02/16/2022
1305358	09a	Asbestos	02/16/2022
1305359	09b	Asbestos	02/16/2022
1305360	09c	Asbestos	02/16/2022
1305361	10a	Asbestos	02/16/2022
1305362	10b	Asbestos	02/16/2022
1305363	10c	Asbestos	02/16/2022
1305364	11a	Asbestos	02/16/2022
1305365	11b	Asbestos	02/16/2022
1305366	11c	Asbestos	02/16/2022
1305367	11d	Asbestos	02/16/2022
1305368	11e	Asbestos	02/16/2022
1305369	12a	Asbestos	02/16/2022
1305370	12b	Asbestos	02/16/2022

Lab Sample Number	Client Sample Number	Sample Type	Completed
1305371	12c	Asbestos	02/16/2022
1305372	13a	Asbestos	02/16/2022
1305373	13b	Asbestos	02/16/2022
1305374	13c	Asbestos	02/16/2022
1305375	14a	Asbestos	02/16/2022
1305376	14b	Asbestos	02/16/2022
1305377	14c	Asbestos	02/16/2022
1305378	15a	Asbestos	02/16/2022
1305379	15b	Asbestos	02/16/2022
1305380	15c	Asbestos	02/16/2022
1305381	16a	Asbestos	02/16/2022
1305382	16b	Asbestos	02/16/2022
1305383	16c	Asbestos	02/16/2022
1305384	17a	Asbestos	02/16/2022
1305385	17b	Asbestos	02/16/2022
1305386	17c	Asbestos	02/16/2022
1305390	18a	Asbestos	02/16/2022
1305391	18b	Asbestos	02/16/2022
1305392	18c	Asbestos	02/16/2022
1305393	18d	Asbestos	02/16/2022
1305394	18e	Asbestos	02/16/2022
1305395	18f	Asbestos	02/16/2022
1305396	19a	Asbestos	02/16/2022
1305397	19b	Asbestos	02/16/2022
1305398	19c	Asbestos	02/16/2022
1305399	20a	Asbestos	02/16/2022

Lab Sample Number	Client Sample Number	Sample Type	Completed
1305400	20b	Asbestos	02/16/2022
1305401	20c	Asbestos	02/16/2022
1305402	21a	Asbestos	02/16/2022
1305403	21b	Asbestos	02/16/2022
1305404	21c	Asbestos	02/16/2022
1305405	22a	Asbestos	02/16/2022
1305406	22b	Asbestos	02/16/2022
1305407	22c	Asbestos	02/16/2022
1305408	23a	Asbestos	02/16/2022
1305409	23b	Asbestos	02/16/2022
1305410	23c	Asbestos	02/16/2022
1305411	24a	Asbestos	02/16/2022
1305412	24b	Asbestos	02/16/2022
1305413	24c	Asbestos	02/16/2022
1305414	25a	Asbestos	02/16/2022
1305415	25b	Asbestos	02/16/2022
1305416	25c	Asbestos	02/16/2022
1305417	26a	Asbestos	02/16/2022
1305418	26b	Asbestos	02/16/2022
1305419	26c	Asbestos	02/16/2022
1305420	27a	Asbestos	02/16/2022
1305421	27b	Asbestos	02/16/2022
1305422	27c	Asbestos	02/16/2022
1305423	28a	Asbestos	02/16/2022
1305424	28b	Asbestos	02/16/2022
1305425	28c	Asbestos	02/16/2022

Lab Sample Number	Client Sample Number	Sample Type	Completed
1305426	29a	Asbestos	02/16/2022
1305427	29b	Asbestos	02/16/2022
1305428	29c	Asbestos	02/16/2022
1305429	30a	Asbestos	02/16/2022
1305430	30b	Asbestos	02/16/2022
1305431	30c	Asbestos	02/16/2022
1305432	31a	Asbestos	02/16/2022
1305433	31b	Asbestos	02/16/2022
1305434	31c	Asbestos	02/16/2022
1305435	32a	Asbestos	02/16/2022
1305436	32b	Asbestos	02/16/2022
1305437	32c	Asbestos	02/16/2022
1305438	33a	Asbestos	02/16/2022
1305439	33b	Asbestos	02/16/2022
1305440	33c	Asbestos	02/16/2022
1305441	34a	Asbestos	02/16/2022
1305442	34b	Asbestos	02/16/2022
1305443	34c	Asbestos	02/16/2022
1305444	35a	Asbestos	02/16/2022
1305445	35b	Asbestos	02/16/2022
1305446	35c	Asbestos	02/16/2022
1305447	36a	Asbestos	02/16/2022
1305448	36b	Asbestos	02/16/2022
1305449	36c	Asbestos	02/16/2022
1305450	37a	Asbestos	02/16/2022
1305451	37b	Asbestos	02/16/2022

Lab Sample Number	Client Sample Number	Sample Type	Completed
1305452	37c	Asbestos	02/16/2022
1305453	38a	Asbestos	02/16/2022
1305454	38b	Asbestos	02/16/2022
1305455	38c	Asbestos	02/16/2022
1305456	39a	Asbestos	02/16/2022
1305457	39b	Asbestos	02/16/2022
1305458	39c	Asbestos	02/16/2022
1305459	40a	Asbestos	02/16/2022
1305460	40b	Asbestos	02/16/2022
1305461	40c	Asbestos	02/16/2022
1305462	41a	Asbestos	02/16/2022
1305463	41b	Asbestos	02/16/2022
1305464	41c	Asbestos	02/16/2022
1305465	42a	Asbestos	02/16/2022
1305466	42b	Asbestos	02/16/2022
1305467	42c	Asbestos	02/16/2022
1305468	43a	Asbestos	02/16/2022
1305469	43b	Asbestos	02/16/2022
1305470	43c	Asbestos	02/16/2022
1305471	44a	Asbestos	02/16/2022
1305472	44b	Asbestos	02/16/2022
1305473	44c	Asbestos	02/16/2022
1305474	45a	Asbestos	02/16/2022
1305475	45b	Asbestos	02/16/2022
1305476	45c	Asbestos	02/16/2022
1305477	46a	Asbestos	02/16/2022

Lab Sample Number	Client Sample Number	Sample Type	Completed
1305478	46b	Asbestos	02/16/2022
1305479	46c	Asbestos	02/16/2022
1305480	47a	Asbestos	02/16/2022
1305481	47b	Asbestos	02/16/2022
1305482	47c	Asbestos	02/16/2022
1305483	48a	Asbestos	02/16/2022
1305484	48b	Asbestos	02/16/2022
1305485	48c	Asbestos	02/16/2022
1305486	49a	Asbestos	02/16/2022
1305487	49b	Asbestos	02/16/2022
1305488	49c	Asbestos	02/16/2022
1305489	50a	Asbestos	02/16/2022
1305490	50b	Asbestos	02/16/2022
1305491	50c	Asbestos	02/16/2022
1306818	51a	Asbestos	02/16/2022
1306819	51b	Asbestos	02/16/2022
1306820	51c	Asbestos	02/16/2022

Reviewed by: 
Emily Nowacki

Lab Sample Number	Client Sample Number	Sample Type	Completed
-------------------	----------------------	-------------	-----------

Polarized Light Microscopy Asbestos Analysis Report

To : LF Green Development, LLC
 5600 W. Brown Deer Rd. Suite 104
 Milwaukee, WI 53224

Location : Coggs Center
 1220 W Vliet, Milwaukee WI

ETC Job : 245920

Client Project : N/A

Date Collected : 02/02/2022

Date Received : 02/14/2022

Sample	Description	Appearance	% Fibrous	% Non-Fibrous	% Asbestos
1305328 01a	Floor Tile	Tan Non-Fibrous Homogenous	PLM 2% Cellulose	PLM 98% Other	PLM None Detected
Layer-1 Analyst: OJ Ivey Date Analyzed : 02/16/2022					
1305328 01a	Mastic	Black Non-Fibrous Homogenous	PLM 2% Cellulose	PLM 98% Other	PLM None Detected
Layer-2 Analyst: OJ Ivey Date Analyzed : 02/16/2022					
1305329 01b	Floor Tile	Tan Non-Fibrous Homogenous	PLM 3% Cellulose	PLM 97% Other	PLM None Detected
Layer-1 Analyst: OJ Ivey Date Analyzed : 02/16/2022					
1305329 01b	Mastic	Black Non-Fibrous Homogenous	PLM 1% Cellulose	PLM 99% Other	PLM None Detected
Layer-2 Analyst: OJ Ivey Date Analyzed : 02/16/2022					
1305330 01c	Floor Tile	Tan Non-Fibrous Homogenous	PLM 2% Cellulose	PLM 98% Other	PLM None Detected
Layer-1 Analyst: OJ Ivey Date Analyzed : 02/16/2022					
1305330 01c	Mastic	Black Non-Fibrous Homogenous	PLM 2% Cellulose	PLM 98% Other	PLM None Detected
Layer-2 Analyst: OJ Ivey Date Analyzed : 02/16/2022					

Polarized Light Microscopy Asbestos Analysis Report

To : LF Green Development, LLC
 5600 W. Brown Deer Rd. Suite 104
 Milwaukee, WI 53224

Location : Coggs Center
 1220 W Vliet, Milwaukee WI

ETC Job : 245920

Client Project : N/A

Date Collected : 02/02/2022

Date Received : 02/14/2022

Sample	Description	Appearance	% Fibrous	% Non-Fibrous	% Asbestos
1305331 02a	Insulation	Gray Fibrous Homogenous	PLM 10% Cellulose	PLM 90% Other	PLM None Detected

Analyst: OJ Ivey

Date Analyzed : 02/16/2022

1305332 02b	Insulation	Gray Fibrous Homogenous	PLM 10% Cellulose	PLM 90% Other	PLM None Detected
----------------	------------	-------------------------------	-------------------	---------------	-------------------

Analyst: OJ Ivey

Date Analyzed : 02/16/2022

1305333 02c	Insulation	Gray Fibrous Homogenous	PLM 12% Cellulose	PLM 88% Other	PLM None Detected
----------------	------------	-------------------------------	-------------------	---------------	-------------------

Analyst: OJ Ivey

Date Analyzed : 02/16/2022

1305334 03a	Floor Tile	Red Non-Fibrous Homogenous	PLM 4% Cellulose	PLM 96% Other	PLM None Detected
----------------	------------	----------------------------------	------------------	---------------	-------------------

Layer-1 Analyst: OJ Ivey

Date Analyzed : 02/16/2022

1305334 03a	Mastic	Black Non-Fibrous Homogenous	PLM 2% Cellulose	PLM 98% Other	PLM None Detected
----------------	--------	------------------------------------	------------------	---------------	-------------------

Layer-2 Analyst: OJ Ivey

Date Analyzed : 02/16/2022

Polarized Light Microscopy Asbestos Analysis Report

To : LF Green Development, LLC
 5600 W. Brown Deer Rd. Suite 104
 Milwaukee, WI 53224

Location : Coggs Center
 1220 W Vliet, Milwaukee WI

ETC Job : 245920

Client Project : N/A

Date Collected : 02/02/2022

Date Received : 02/14/2022

Sample	Description	Appearance	% Fibrous	% Non-Fibrous	% Asbestos
1305335 03b	Floor Tile	Red Non-Fibrous Homogenous	PLM 2% Cellulose	PLM 98% Other	PLM None Detected
Layer-1 Analyst: OJ Ivey Date Analyzed : 02/16/2022					
1305335 03b	Mastic	Black Non-Fibrous Homogenous	PLM 2% Cellulose	PLM 98% Other	PLM None Detected
Layer-2 Analyst: OJ Ivey Date Analyzed : 02/16/2022					
1305336 03c	Floor Tile	Red Non-Fibrous Homogenous	PLM 4% Cellulose	PLM 96% Other	PLM None Detected
Layer-1 Analyst: OJ Ivey Date Analyzed : 02/16/2022					
1305336 03c	Mastic	Black Non-Fibrous Homogenous	PLM 2% Cellulose	PLM 98% Other	PLM None Detected
Layer-2 Analyst: OJ Ivey Date Analyzed : 02/16/2022					
1305337 04a	Insulation	Gray Non-Fibrous Homogenous	PLM 3% Cellulose	PLM 97% Other	PLM None Detected
Analyst: OJ Ivey Date Analyzed : 02/16/2022					
1305338 04b	Insulation	Gray Non-Fibrous Homogenous	PLM 4% Cellulose	PLM 96% Other	PLM None Detected
Analyst: OJ Ivey Date Analyzed : 02/16/2022					

Polarized Light Microscopy Asbestos Analysis Report

To : LF Green Development, LLC
 5600 W. Brown Deer Rd. Suite 104
 Milwaukee, WI 53224

Location : Coggs Center
 1220 W Vliet, Milwaukee WI

ETC Job : 245920

Client Project : N/A

Date Collected : 02/02/2022

Date Received : 02/14/2022

Sample	Description	Appearance	% Fibrous	% Non-Fibrous	% Asbestos
1305339 04c	Insulation	Gray Non-Fibrous Homogenous	PLM 2% Cellulose	PLM 98% Other	PLM None Detected
Analyst: OJ Ivey Date Analyzed : 02/16/2022					
1305340 05a	Adhesive	Tan Non-Fibrous Homogenous	PLM 1% Cellulose	PLM 99% Other	PLM None Detected
Analyst: OJ Ivey Date Analyzed : 02/16/2022					
1305341 05b	Adhesive	Tan Non-Fibrous Homogenous	PLM 1% Cellulose	PLM 99% Other	PLM None Detected
Analyst: OJ Ivey Date Analyzed : 02/16/2022					
1305342 05c	Adhesive	Tan Non-Fibrous Homogenous	PLM 1% Cellulose	PLM 99% Other	PLM None Detected
Analyst: OJ Ivey Date Analyzed : 02/16/2022					
1305343 05d	Adhesive	Tan Non-Fibrous Homogenous	PLM 3% Cellulose	PLM 97% Other	PLM None Detected
Analyst: OJ Ivey Date Analyzed : 02/16/2022					
1305344 05e	Adhesive	Tan Non-Fibrous Homogenous	PLM 2% Cellulose	PLM 98% Other	PLM None Detected
Analyst: OJ Ivey Date Analyzed : 02/16/2022					

Polarized Light Microscopy Asbestos Analysis Report

To : LF Green Development, LLC
 5600 W. Brown Deer Rd. Suite 104
 Milwaukee, WI 53224

Location : Coggs Center
 1220 W Vliet, Milwaukee WI

ETC Job : 245920

Client Project : N/A

Date Collected : 02/02/2022

Date Received : 02/14/2022

Sample	Description	Appearance	% Fibrous	% Non-Fibrous	% Asbestos
1305345 06a	Ceiling Tile	Gray Fibrous Homogenous	PLM 60% Fiberglass	PLM 40% Other	PLM None Detected
Analyst: OJ Ivey Date Analyzed : 02/16/2022					
1305346 06b	Ceiling Tile	Gray Fibrous Homogenous	PLM 55% Fiberglass	PLM 45% Other	PLM None Detected
Analyst: OJ Ivey Date Analyzed : 02/16/2022					
1305347 06c	Ceiling Tile	Gray Fibrous Homogenous	PLM 45% Fiberglass	PLM 55% Other	PLM None Detected
Analyst: OJ Ivey Date Analyzed : 02/16/2022					
1305348 07a	Insulation	Black / Brown Fibrous Homogenous	PLM 98% Cellulose	PLM 2% Other	PLM None Detected
Analyst: OJ Ivey Date Analyzed : 02/16/2022					
1305349 07b	Insulation	Black / Brown Fibrous Homogenous	PLM 97% Cellulose	PLM 3% Other	PLM None Detected
Analyst: OJ Ivey Date Analyzed : 02/16/2022					
1305350 07c	Insulation	Black / Brown Fibrous Homogenous	PLM 70% Cellulose	PLM 30% Other	PLM None Detected
Analyst: OJ Ivey Date Analyzed : 02/16/2022					

Polarized Light Microscopy Asbestos Analysis Report

To : LF Green Development, LLC
 5600 W. Brown Deer Rd. Suite 104
 Milwaukee, WI 53224

Location : Coggs Center
 1220 W Vliet, Milwaukee WI

ETC Job : 245920

Client Project : N/A

Date Collected : 02/02/2022

Date Received : 02/14/2022

Sample	Description	Appearance	% Fibrous	% Non-Fibrous	% Asbestos
1305351 08a	Glue	Brown Non-Fibrous Homogenous	PLM 1% Cellulose	PLM 99% Other	PLM None Detected
Analyst: OJ Ivey Date Analyzed : 02/16/2022					
1305352 08b	Glue	Brown Non-Fibrous Homogenous	PLM 4% Cellulose	PLM 96% Other	PLM None Detected
Analyst: OJ Ivey Date Analyzed : 02/16/2022					
1305353 08c	Glue	Brown Non-Fibrous Homogenous	PLM 2% Cellulose	PLM 98% Other	PLM None Detected
Analyst: OJ Ivey Date Analyzed : 02/16/2022					
1305354 08d	Glue	Brown Non-Fibrous Homogenous	PLM 8% Cellulose	PLM 92% Other	PLM None Detected
Analyst: OJ Ivey Date Analyzed : 02/16/2022					
1305355 08e	Glue	Brown Non-Fibrous Homogenous	PLM 7% Cellulose	PLM 93% Other	PLM None Detected
Analyst: OJ Ivey Date Analyzed : 02/16/2022					
1305356 08f	Glue	Brown Non-Fibrous Homogenous	PLM 9% Cellulose	PLM 91% Other	PLM None Detected
Analyst: OJ Ivey Date Analyzed : 02/16/2022					

Polarized Light Microscopy Asbestos Analysis Report

To : LF Green Development, LLC
 5600 W. Brown Deer Rd. Suite 104
 Milwaukee, WI 53224

Location : Coggs Center
 1220 W Vliet, Milwaukee WI

ETC Job : 245920

Client Project : N/A

Date Collected : 02/02/2022

Date Received : 02/14/2022

Sample	Description	Appearance	% Fibrous	% Non-Fibrous	% Asbestos
1305357 08g	Glue	Brown Non-Fibrous Homogenous	PLM 7% Cellulose	PLM 93% Other	PLM None Detected
Analyst: OJ Ivey Date Analyzed : 02/16/2022					
1305358 09a	Ceiling Tile	Gray Fibrous Homogenous	PLM 25% Cellulose	PLM 75% Other	PLM None Detected
Analyst: OJ Ivey Date Analyzed : 02/16/2022					
1305359 09b	Ceiling Tile	Gray Fibrous Homogenous	PLM 20% Cellulose	PLM 80% Other	PLM None Detected
Analyst: OJ Ivey Date Analyzed : 02/16/2022					
1305360 09c	Ceiling Tile	Gray Fibrous Homogenous	PLM 25% Cellulose	PLM 75% Other	PLM None Detected
Analyst: OJ Ivey Date Analyzed : 02/16/2022					
1305361 10a	Ceiling Material	Black / Brown Fibrous Homogenous	PLM 95% Cellulose	PLM 5% Other	PLM None Detected
Analyst: OJ Ivey Date Analyzed : 02/16/2022					
1305362 10b	Ceiling Material	Black / Brown Fibrous Homogenous	PLM 85% Cellulose	PLM 15% Other	PLM None Detected
Analyst: OJ Ivey Date Analyzed : 02/16/2022					

Polarized Light Microscopy Asbestos Analysis Report

To : LF Green Development, LLC
 5600 W. Brown Deer Rd. Suite 104
 Milwaukee, WI 53224

Location : Coggs Center
 1220 W Vliet, Milwaukee WI

ETC Job : 245920

Client Project : N/A

Date Collected : 02/02/2022

Date Received : 02/14/2022

Sample	Description	Appearance	% Fibrous	% Non-Fibrous	% Asbestos
1305363 10c	Ceiling Material	Black / Brown Fibrous Homogenous	PLM 90% Cellulose	PLM 10% Other	PLM None Detected
Analyst: OJ Ivey Date Analyzed : 02/16/2022					
1305364 11a	Texture	Black / White Non-Fibrous Homogenous	PLM 3% Cellulose	PLM 97% Other	PLM None Detected
Analyst: OJ Ivey Date Analyzed : 02/16/2022					
1305365 11b	Texture	Black / White Non-Fibrous Homogenous	PLM 2% Cellulose	PLM 98% Other	PLM None Detected
Analyst: OJ Ivey Date Analyzed : 02/16/2022					
1305366 11c	Texture	Black / White Non-Fibrous Homogenous	PLM 5% Cellulose	PLM 95% Other	PLM None Detected
Analyst: OJ Ivey Date Analyzed : 02/16/2022					
1305367 11d	Texture	Black / White Non-Fibrous Homogenous	PLM 3% Cellulose	PLM 97% Other	PLM None Detected
Analyst: OJ Ivey Date Analyzed : 02/16/2022					
1305368 11e	Texture	Black / White Non-Fibrous Homogenous	PLM 1% Cellulose	PLM 99% Other	PLM None Detected
Analyst: OJ Ivey Date Analyzed : 02/16/2022					

Polarized Light Microscopy Asbestos Analysis Report

To : LF Green Development, LLC
 5600 W. Brown Deer Rd. Suite 104
 Milwaukee, WI 53224

Location : Coggs Center
 1220 W Vliet, Milwaukee WI

ETC Job : 245920

Client Project : N/A

Date Collected : 02/02/2022

Date Received : 02/14/2022

Sample	Description	Appearance	% Fibrous	% Non-Fibrous	% Asbestos
1305369 12a	Linoleum	Gray Non-Fibrous Homogenous	PLM 3% Cellulose	PLM 97% Other	PLM None Detected
Analyst: OJ Ivey Date Analyzed : 02/16/2022					
1305370 12b	Linoleum	Gray Non-Fibrous Homogenous	PLM 3% Cellulose	PLM 97% Other	PLM None Detected
Analyst: OJ Ivey Date Analyzed : 02/16/2022					
1305371 12c	Linoleum	Gray Non-Fibrous Homogenous	PLM 4% Cellulose	PLM 96% Other	PLM None Detected
Analyst: OJ Ivey Date Analyzed : 02/16/2022					
1305372 13a	Glue	Tan Non-Fibrous Homogenous	PLM 2% Cellulose	PLM 98% Other	PLM None Detected
Analyst: OJ Ivey Date Analyzed : 02/16/2022					
1305373 13b	Glue	Tan Non-Fibrous Homogenous	PLM 1% Cellulose	PLM 99% Other	PLM None Detected
Analyst: OJ Ivey Date Analyzed : 02/16/2022					
1305374 13c	Glue	Tan Non-Fibrous Homogenous	PLM 3% Cellulose	PLM 97% Other	PLM None Detected
Analyst: OJ Ivey Date Analyzed : 02/16/2022					

Polarized Light Microscopy Asbestos Analysis Report

To : LF Green Development, LLC
 5600 W. Brown Deer Rd. Suite 104
 Milwaukee, WI 53224

Location : Coggs Center
 1220 W Vliet, Milwaukee WI

ETC Job : 245920

Client Project : N/A

Date Collected : 02/02/2022

Date Received : 02/14/2022

Sample	Description	Appearance	% Fibrous	% Non-Fibrous	% Asbestos
1305375 14a	Ceiling Tile	Silver / Grey Fibrous Homogenous	PLM 35% Fiberglass	PLM 65% Other	PLM None Detected

Analyst: OJ Ivey

Date Analyzed : 02/16/2022

1305376 14b	Ceiling Tile	Silver / Grey Fibrous Homogenous	PLM 35% Fiberglass	PLM 65% Other	PLM None Detected
----------------	--------------	--	--------------------	---------------	-------------------

Analyst: OJ Ivey

Date Analyzed : 02/16/2022

1305377 14c	Ceiling Tile	Silver / Grey Fibrous Homogenous	PLM 40% Fiberglass	PLM 60% Other	PLM None Detected
----------------	--------------	--	--------------------	---------------	-------------------

Analyst: OJ Ivey

Date Analyzed : 02/16/2022

1305378 15a	Covebase	Black Non-Fibrous Homogenous	PLM 1% Cellulose	PLM 99% Other	PLM None Detected
----------------	----------	------------------------------------	------------------	---------------	-------------------

Layer-1 Analyst: OJ Ivey

Date Analyzed : 02/16/2022

1305378 15a	Glue	Yellow Non-Fibrous Homogenous	PLM 1% Cellulose	PLM 99% Other	PLM None Detected
----------------	------	-------------------------------------	------------------	---------------	-------------------

Layer-2 Analyst: OJ Ivey

Date Analyzed : 02/16/2022

Polarized Light Microscopy Asbestos Analysis Report

To : LF Green Development, LLC
 5600 W. Brown Deer Rd. Suite 104
 Milwaukee, WI 53224

Location : Coggs Center
 1220 W Vliet, Milwaukee WI

ETC Job : 245920

Client Project : N/A

Date Collected : 02/02/2022

Date Received : 02/14/2022

Sample	Description	Appearance	% Fibrous	% Non-Fibrous	% Asbestos
1305379 15b	Covebase	Black Non-Fibrous Homogenous	PLM 3% Cellulose	PLM 97% Other	PLM None Detected
Layer-1 Analyst: OJ Ivey Date Analyzed : 02/16/2022					
1305379 15b	Glue	Yellow Non-Fibrous Homogenous	PLM 1% Cellulose	PLM 99% Other	PLM None Detected
Layer-2 Analyst: OJ Ivey Date Analyzed : 02/16/2022					
1305380 15c	Covebase	Black Non-Fibrous Homogenous	PLM 4% Cellulose	PLM 96% Other	PLM None Detected
Layer-1 Analyst: OJ Ivey Date Analyzed : 02/16/2022					
1305380 15c	Glue	Yellow Non-Fibrous Homogenous	PLM 2% Cellulose	PLM 98% Other	PLM None Detected
Layer-2 Analyst: OJ Ivey Date Analyzed : 02/16/2022					
1305381 16a	Floor Tile	Gray Non-Fibrous Homogenous	PLM 2% Cellulose	PLM 98% Other	PLM None Detected
Layer-1 Analyst: OJ Ivey Date Analyzed : 02/16/2022					
1305381 16a	Mastic	Black Non-Fibrous Homogenous	PLM 2% Cellulose	PLM 98% Other	PLM None Detected
Layer-2 Analyst: OJ Ivey Date Analyzed : 02/16/2022					

Polarized Light Microscopy Asbestos Analysis Report

To : LF Green Development, LLC
 5600 W. Brown Deer Rd. Suite 104
 Milwaukee, WI 53224

Location : Coggs Center
 1220 W Vliet, Milwaukee WI

ETC Job : 245920

Client Project : N/A

Date Collected : 02/02/2022

Date Received : 02/14/2022

Sample	Description	Appearance	% Fibrous	% Non-Fibrous	% Asbestos
1305382 16b	Floor Tile	Gray Non-Fibrous Homogenous	PLM 2% Cellulose	PLM 98% Other	PLM None Detected
Layer-1 Analyst: OJ Ivey Date Analyzed : 02/16/2022					
1305382 16b	Mastic	Black Non-Fibrous Homogenous	PLM 2% Cellulose	PLM 98% Other	PLM None Detected
Layer-2 Analyst: OJ Ivey Date Analyzed : 02/16/2022					
1305383 16c	Floor Tile	Gray Non-Fibrous Homogenous	PLM 3% Cellulose	PLM 97% Other	PLM None Detected
Layer-1 Analyst: OJ Ivey Date Analyzed : 02/16/2022					
1305383 16c	Mastic	Black Non-Fibrous Homogenous	PLM 2% Cellulose	PLM 98% Other	PLM None Detected
Layer-2 Analyst: OJ Ivey Date Analyzed : 02/16/2022					
1305384 17a	Ceramic Tile	Beige Non-Fibrous Homogenous	PLM 1% Cellulose	PLM 99% Other	PLM None Detected
Layer-1 Analyst: OJ Ivey Date Analyzed : 02/16/2022					
1305384 17a	Grout	Gray Non-Fibrous Homogenous	PLM 8% Cellulose	PLM 92% Other	PLM None Detected
Layer-2 Analyst: OJ Ivey Date Analyzed : 02/16/2022					

Polarized Light Microscopy Asbestos Analysis Report

To : LF Green Development, LLC
5600 W. Brown Deer Rd. Suite 104
Milwaukee, WI 53224

Location : Coggs Center
1220 W Vliet, Milwaukee WI

ETC Job : 245920

Client Project : N/A

Date Collected : 02/02/2022

Date Received : 02/14/2022

Sample	Description	Appearance	% Fibrous	% Non-Fibrous	% Asbestos
1305385 17b	Ceramic Tile	Beige Non-Fibrous Homogenous	PLM 4% Cellulose	PLM 96% Other	PLM None Detected
Layer-1 Analyst: OJ Ivey Date Analyzed : 02/16/2022					
1305385 17b	Grout	Gray Non-Fibrous Homogenous	PLM 7% Cellulose	PLM 93% Other	PLM None Detected
Layer-2 Analyst: OJ Ivey Date Analyzed : 02/16/2022					
1305386 17c	Ceramic Tile	Beige Non-Fibrous Homogenous	PLM 3% Cellulose	PLM 97% Other	PLM None Detected
Layer-1 Analyst: OJ Ivey Date Analyzed : 02/16/2022					
1305386 17c	Grout	Gray Non-Fibrous Homogenous	PLM 5% Cellulose	PLM 95% Other	PLM None Detected
Layer-2 Analyst: OJ Ivey Date Analyzed : 02/16/2022					
1305390 18a	Ceramic Tile	Gray Non-Fibrous Homogenous	PLM 1% Fiberglass	PLM 99% Other	PLM None Detected
Layer-1 Analyst: OJ Ivey Date Analyzed : 02/16/2022					
1305390 18a	Grout	White Non-Fibrous Homogenous	PLM 10% Fiberglass	PLM 90% Other	PLM None Detected
Layer-2 Analyst: OJ Ivey Date Analyzed : 02/16/2022					

Polarized Light Microscopy Asbestos Analysis Report

To : LF Green Development, LLC
 5600 W. Brown Deer Rd. Suite 104
 Milwaukee, WI 53224

Location : Coggs Center
 1220 W Vliet, Milwaukee WI

ETC Job : 245920

Client Project : N/A

Date Collected : 02/02/2022

Date Received : 02/14/2022

Sample	Description	Appearance	% Fibrous	% Non-Fibrous	% Asbestos
1305391 18b	Ceramic Tile	Gray Non-Fibrous Homogenous	PLM 3% Fiberglass	PLM 97% Other	PLM None Detected
Layer-1 Analyst: OJ Ivey Date Analyzed : 02/16/2022					
1305391 18b	Grout	White Non-Fibrous Homogenous	PLM 10% Fiberglass	PLM 90% Other	PLM None Detected
Layer-2 Analyst: OJ Ivey Date Analyzed : 02/16/2022					
1305392 18c	Ceramic Tile	Gray Non-Fibrous Homogenous	PLM 2% Fiberglass	PLM 98% Other	PLM None Detected
Layer-1 Analyst: OJ Ivey Date Analyzed : 02/16/2022					
1305392 18c	Grout	White Non-Fibrous Homogenous	PLM 9% Fiberglass	PLM 91% Other	PLM None Detected
Layer-2 Analyst: OJ Ivey Date Analyzed : 02/16/2022					
1305393 18d	Ceramic Tile	Gray Non-Fibrous Homogenous	PLM 3% Fiberglass	PLM 97% Other	PLM None Detected
Layer-1 Analyst: OJ Ivey Date Analyzed : 02/16/2022					
1305393 18d	Grout	White Non-Fibrous Homogenous	PLM 8% Fiberglass	PLM 92% Other	PLM None Detected
Layer-2 Analyst: OJ Ivey Date Analyzed : 02/16/2022					

Polarized Light Microscopy Asbestos Analysis Report

To : LF Green Development, LLC
 5600 W. Brown Deer Rd. Suite 104
 Milwaukee, WI 53224

Location : Coggs Center
 1220 W Vliet, Milwaukee WI

ETC Job : 245920

Client Project : N/A

Date Collected : 02/02/2022

Date Received : 02/14/2022

Sample	Description	Appearance	% Fibrous	% Non-Fibrous	% Asbestos
1305394 18e	Ceramic Tile	Gray Non-Fibrous Homogenous	PLM 2% Fiberglass	PLM 98% Other	PLM None Detected
Layer-1 Analyst: OJ Ivey Date Analyzed : 02/16/2022					
1305394 18e	Grout	White Non-Fibrous Homogenous	PLM 8% Fiberglass	PLM 92% Other	PLM None Detected
Layer-2 Analyst: OJ Ivey Date Analyzed : 02/16/2022					
1305395 18f	Ceramic Tile	Gray Non-Fibrous Homogenous	PLM 3% Fiberglass	PLM 97% Other	PLM None Detected
Layer-1 Analyst: OJ Ivey Date Analyzed : 02/16/2022					
1305395 18f	Grout	White Non-Fibrous Homogenous	PLM 10% Fiberglass	PLM 90% Other	PLM None Detected
Layer-2 Analyst: OJ Ivey Date Analyzed : 02/16/2022					
1305396 19a	Covebase	Tan / Brown Non-Fibrous Homogenous	PLM 3% Cellulose	PLM 97% Other	PLM None Detected
Layer-1 Analyst: OJ Ivey Date Analyzed : 02/16/2022					
1305396 19a	Adhesive	Gray Non-Fibrous Homogenous	PLM 3% Cellulose	PLM 97% Other	PLM None Detected
Layer-2 Analyst: OJ Ivey Date Analyzed : 02/16/2022					

Polarized Light Microscopy Asbestos Analysis Report

To : LF Green Development, LLC
5600 W. Brown Deer Rd. Suite 104
Milwaukee, WI 53224

Location : Coggs Center
1220 W Vliet, Milwaukee WI

ETC Job : 245920

Client Project : N/A

Date Collected : 02/02/2022

Date Received : 02/14/2022

Sample	Description	Appearance	% Fibrous	% Non-Fibrous	% Asbestos
1305397 19b	Covebase	Tan / Brown Non-Fibrous Homogenous	PLM 2% Cellulose	PLM 98% Other	PLM None Detected
Layer-1 Analyst: OJ Ivey Date Analyzed : 02/16/2022					
1305397 19b	Adhesive	Gray Non-Fibrous Homogenous	PLM 2% Cellulose	PLM 98% Other	PLM None Detected
Layer-2 Analyst: OJ Ivey Date Analyzed : 02/16/2022					
1305398 19c	Covebase	Tan / Brown Non-Fibrous Homogenous	PLM 3% Cellulose	PLM 97% Other	PLM None Detected
Layer-1 Analyst: OJ Ivey Date Analyzed : 02/16/2022					
1305398 19c	Adhesive	Gray Non-Fibrous Homogenous	PLM 2% Cellulose	PLM 98% Other	PLM None Detected
Layer-2 Analyst: OJ Ivey Date Analyzed : 02/16/2022					
1305399 20a	Floor Tile	Cream Non-Fibrous Homogenous	PLM 3% Cellulose	PLM 97% Other	PLM None Detected
Layer-1 Analyst: OJ Ivey Date Analyzed : 02/16/2022					
1305399 20a	Glue	Black / Brown Non-Fibrous Homogenous	PLM 5% Cellulose	PLM 95% Other	PLM None Detected
Layer-2 Analyst: OJ Ivey Date Analyzed : 02/16/2022					

Polarized Light Microscopy Asbestos Analysis Report

To : LF Green Development, LLC
 5600 W. Brown Deer Rd. Suite 104
 Milwaukee, WI 53224

Location : Coggs Center
 1220 W Vliet, Milwaukee WI

ETC Job : 245920

Client Project : N/A

Date Collected : 02/02/2022

Date Received : 02/14/2022

Sample	Description	Appearance	% Fibrous	% Non-Fibrous	% Asbestos
1305400 20b	Floor Tile	Cream Non-Fibrous Homogenous	PLM 2% Cellulose	PLM 98% Other	PLM None Detected
Layer-1 Analyst: OJ Ivey Date Analyzed : 02/16/2022					
1305400 20b	Glue	Black / Brown Non-Fibrous Homogenous	PLM 2% Cellulose	PLM 98% Other	PLM None Detected
Layer-2 Analyst: OJ Ivey Date Analyzed : 02/16/2022					
1305401 20c	Floor Tile	Cream Non-Fibrous Homogenous	PLM 4% Cellulose	PLM 96% Other	PLM None Detected
Layer-1 Analyst: OJ Ivey Date Analyzed : 02/16/2022					
1305401 20c	Glue	Black / Brown Non-Fibrous Homogenous	PLM 2% Cellulose	PLM 98% Other	PLM None Detected
Layer-2 Analyst: OJ Ivey Date Analyzed : 02/16/2022					
1305402 21a	Floor Tile	Gray Non-Fibrous Homogenous	PLM 2% Cellulose	PLM 98% Other	PLM None Detected
Layer-1 Analyst: OJ Ivey Date Analyzed : 02/16/2022					
1305402 21a	Mastic	Black Non-Fibrous Homogenous	PLM 2% Cellulose	PLM 93% Other	PLM 5% Chrysotile
Layer-2 Analyst: OJ Ivey Date Analyzed : 02/16/2022					

Polarized Light Microscopy Asbestos Analysis Report

To : LF Green Development, LLC
 5600 W. Brown Deer Rd. Suite 104
 Milwaukee, WI 53224

Location : Coggs Center
 1220 W Vliet, Milwaukee WI

ETC Job : 245920

Client Project : N/A

Date Collected : 02/02/2022

Date Received : 02/14/2022

Sample	Description	Appearance	% Fibrous	% Non-Fibrous	% Asbestos
1305403 21b	Floor Tile	Gray Non-Fibrous Homogenous	PLM 2% Cellulose	PLM 98% Other	PLM None Detected
Layer-1 Analyst: OJ Ivey Date Analyzed : 02/16/2022					
1305403 21b		Positive Stop			
Layer-2 Analyst: OJ Ivey Date Analyzed : 02/16/2022					
Layer Not Analyzed					
1305404 21c	Floor Tile	Gray Non-Fibrous Homogenous	PLM 1% Cellulose	PLM 99% Other	PLM None Detected
Layer-1 Analyst: OJ Ivey Date Analyzed : 02/16/2022					
1305404 21c		Positive Stop			
Layer-2 Analyst: OJ Ivey Date Analyzed : 02/16/2022					
Layer Not Analyzed					
1305405 22a	Ceiling Tile	Gray Fibrous Homogenous	PLM 90% Fiberglass	PLM 10% Other	PLM None Detected
Analyst: OJ Ivey Date Analyzed : 02/16/2022					
1305406 22b	Ceiling Tile	Gray Fibrous Homogenous	PLM 90% Fiberglass	PLM 10% Other	PLM None Detected
Analyst: OJ Ivey Date Analyzed : 02/16/2022					

Polarized Light Microscopy Asbestos Analysis Report

To : LF Green Development, LLC
 5600 W. Brown Deer Rd. Suite 104
 Milwaukee, WI 53224

Location : Coggs Center
 1220 W Vliet, Milwaukee WI

ETC Job : 245920

Client Project : N/A

Date Collected : 02/02/2022

Date Received : 02/14/2022

Sample	Description	Appearance	% Fibrous	% Non-Fibrous	% Asbestos
1305407 22c	Ceiling Tile	Gray Fibrous Homogenous	PLM 91% Fiberglass	PLM 9% Other	PLM None Detected
Analyst: OJ Ivey Date Analyzed : 02/16/2022					
1305408 23a	Glue	Tan Non-Fibrous Homogenous	PLM 7% Cellulose	PLM 93% Other	PLM None Detected
Analyst: OJ Ivey Date Analyzed : 02/16/2022					
1305409 23b	Glue	Tan Non-Fibrous Homogenous	PLM 6% Cellulose	PLM 94% Other	PLM None Detected
Analyst: OJ Ivey Date Analyzed : 02/16/2022					
1305410 23c	Glue	Tan Non-Fibrous Homogenous	PLM 5% Cellulose	PLM 95% Other	PLM None Detected
Analyst: OJ Ivey Date Analyzed : 02/16/2022					
1305411 24a	Ceiling Tile	Gray Fibrous Homogenous	PLM 45% Fiberglass	PLM 55% Other	PLM None Detected
Analyst: OJ Ivey Date Analyzed : 02/16/2022					
1305412 24b	Ceiling Tile	Gray Fibrous Homogenous	PLM 45% Fiberglass	PLM 55% Other	PLM None Detected
Analyst: OJ Ivey Date Analyzed : 02/16/2022					

Polarized Light Microscopy Asbestos Analysis Report

To : LF Green Development, LLC
 5600 W. Brown Deer Rd. Suite 104
 Milwaukee, WI 53224

Location : Coggs Center
 1220 W Vliet, Milwaukee WI

ETC Job : 245920

Client Project : N/A

Date Collected : 02/02/2022

Date Received : 02/14/2022

Sample	Description	Appearance	% Fibrous	% Non-Fibrous	% Asbestos
1305413 24c	Ceiling Tile	Gray Fibrous Homogenous	PLM 45% Fiberglass	PLM 55% Other	PLM None Detected
Analyst: OJ Ivey Date Analyzed : 02/16/2022					
1305414 25a	Insulation	Tan / Yellow Non-Fibrous Homogenous	PLM 7% Cellulose	PLM 93% Other	PLM None Detected
Analyst: OJ Ivey Date Analyzed : 02/16/2022					
1305415 25b	Insulation	Tan / Yellow Non-Fibrous Homogenous	PLM 4% Cellulose	PLM 96% Other	PLM None Detected
Analyst: OJ Ivey Date Analyzed : 02/16/2022					
1305416 25c	Insulation	Tan / Yellow Non-Fibrous Homogenous	PLM 8% Cellulose	PLM 92% Other	PLM None Detected
Analyst: OJ Ivey Date Analyzed : 02/16/2022					
1305417 26a	Insulation	Beige Non-Fibrous Homogenous	PLM 4% Cellulose	PLM 96% Other	PLM None Detected
Analyst: OJ Ivey Date Analyzed : 02/16/2022					
1305418 26b	Insulation	Beige Non-Fibrous Homogenous	PLM 5% Cellulose	PLM 95% Other	PLM None Detected
Analyst: OJ Ivey Date Analyzed : 02/16/2022					

Polarized Light Microscopy Asbestos Analysis Report

To : LF Green Development, LLC
5600 W. Brown Deer Rd. Suite 104
Milwaukee, WI 53224

Location : Coggs Center
1220 W Vliet, Milwaukee WI

ETC Job : 245920

Client Project : N/A

Date Collected : 02/02/2022

Date Received : 02/14/2022

Sample	Description	Appearance	% Fibrous	% Non-Fibrous	% Asbestos
1305419 26c	Insulation	Beige Non-Fibrous Homogenous	PLM 3% Cellulose	PLM 97% Other	PLM None Detected

Analyst: OJ Ivey

Date Analyzed : 02/16/2022

1305420 27a	Floor Tile	Brown Non-Fibrous Homogenous	PLM 2% Cellulose	PLM 98% Other	PLM None Detected
----------------	------------	------------------------------------	------------------	---------------	-------------------

Layer-1 Analyst: Scott Larabell

Date Analyzed : 02/16/2022

1305420 27a	Mastic	Black Non-Fibrous Homogenous	PLM 3% Cellulose	PLM 97% Other	PLM None Detected
----------------	--------	------------------------------------	------------------	---------------	-------------------

Layer-2 Analyst: Scott Larabell

Date Analyzed : 02/16/2022

1305421 27b	Floor Tile	Brown Non-Fibrous Homogenous	PLM 2% Cellulose	PLM 98% Other	PLM None Detected
----------------	------------	------------------------------------	------------------	---------------	-------------------

Layer-1 Analyst: Scott Larabell

Date Analyzed : 02/16/2022

1305421 27b	Mastic	Black Non-Fibrous Homogenous	PLM 3% Cellulose	PLM 97% Other	PLM None Detected
----------------	--------	------------------------------------	------------------	---------------	-------------------

Layer-2 Analyst: Scott Larabell

Date Analyzed : 02/16/2022

Polarized Light Microscopy Asbestos Analysis Report

To : LF Green Development, LLC
 5600 W. Brown Deer Rd. Suite 104
 Milwaukee, WI 53224

Location : Coggs Center
 1220 W Vliet, Milwaukee WI

ETC Job : 245920

Client Project : N/A

Date Collected : 02/02/2022

Date Received : 02/14/2022

Sample	Description	Appearance	% Fibrous	% Non-Fibrous	% Asbestos
1305422 27c	Floor Tile	Brown Non-Fibrous Homogenous	PLM 2% Cellulose	PLM 98% Other	PLM None Detected
Layer-1 Analyst: Scott Larabell Date Analyzed : 02/16/2022					
1305422 27c	Mastic	Black Non-Fibrous Homogenous	PLM 2% Cellulose	PLM 98% Other	PLM None Detected
Layer-2 Analyst: Scott Larabell Date Analyzed : 02/16/2022					
1305423 28a	Floor Tile	Brown Non-Fibrous Homogenous	PLM 2% Cellulose	PLM 98% Other	PLM None Detected
Layer-1 Analyst: Scott Larabell Date Analyzed : 02/16/2022					
1305423 28a	Mastic	Black Non-Fibrous Homogenous	PLM 3% Cellulose	PLM 97% Other	PLM None Detected
Layer-2 Analyst: Scott Larabell Date Analyzed : 02/16/2022					
1305424 28b	Floor Tile	Brown Non-Fibrous Homogenous	PLM 2% Cellulose	PLM 98% Other	PLM None Detected
Layer-1 Analyst: Scott Larabell Date Analyzed : 02/16/2022					
1305424 28b	Mastic	Black Non-Fibrous Homogenous	PLM 2% Cellulose	PLM 98% Other	PLM None Detected
Layer-2 Analyst: Scott Larabell Date Analyzed : 02/16/2022					

Polarized Light Microscopy Asbestos Analysis Report

To : LF Green Development, LLC
 5600 W. Brown Deer Rd. Suite 104
 Milwaukee, WI 53224

Location : Coggs Center
 1220 W Vliet, Milwaukee WI

ETC Job : 245920

Client Project : N/A

Date Collected : 02/02/2022

Date Received : 02/14/2022

Sample	Description	Appearance	% Fibrous	% Non-Fibrous	% Asbestos
1305425 28c	Floor Tile	Brown Non-Fibrous Homogenous	PLM 2% Cellulose	PLM 98% Other	PLM None Detected
Layer-1 Analyst: Scott Larabell Date Analyzed : 02/16/2022					
1305425 28c	Mastic	Black Non-Fibrous Homogenous	PLM 2% Cellulose	PLM 98% Other	PLM None Detected
Layer-2 Analyst: Scott Larabell Date Analyzed : 02/16/2022					
1305426 29a	Ceiling Tile	White Fibrous Homogenous	PLM 20% Cellulose	PLM 70% Other	PLM 10% Amosite
Analyst: Scott Larabell Date Analyzed : 02/16/2022					
1305427 29b		Positive Stop			
Analyst: Scott Larabell Date Analyzed : 02/16/2022					
Sample Not Analyzed					
1305428 29c		Positive Stop			
Analyst: Scott Larabell Date Analyzed : 02/16/2022					
Sample Not Analyzed					

Polarized Light Microscopy Asbestos Analysis Report

To : LF Green Development, LLC
5600 W. Brown Deer Rd. Suite 104
Milwaukee, WI 53224

Location : Coggs Center
1220 W Vliet, Milwaukee WI

ETC Job : 245920
Client Project : N/A
Date Collected : 02/02/2022
Date Received : 02/14/2022

Sample	Description	Appearance	% Fibrous	% Non-Fibrous	% Asbestos
1305429 30a	Floor Tile	Blue Non-Fibrous Homogenous	PLM 2% Cellulose	PLM 98% Other	PLM None Detected
Layer-1 Analyst: Scott Larabell Date Analyzed : 02/16/2022					
1305429 30a	Mastic	Black Non-Fibrous Homogenous	PLM 3% Cellulose	PLM 97% Other	PLM None Detected
Layer-2 Analyst: Scott Larabell Date Analyzed : 02/16/2022					
1305430 30b	Floor Tile	Blue Non-Fibrous Homogenous	PLM 2% Cellulose	PLM 98% Other	PLM None Detected
Layer-1 Analyst: Scott Larabell Date Analyzed : 02/16/2022					
1305430 30b	Mastic	Black Non-Fibrous Homogenous	PLM 2% Cellulose	PLM 98% Other	PLM None Detected
Layer-2 Analyst: Scott Larabell Date Analyzed : 02/16/2022					
1305431 30c	Floor Tile	Blue Non-Fibrous Homogenous	PLM 2% Cellulose	PLM 98% Other	PLM None Detected
Layer-1 Analyst: Scott Larabell Date Analyzed : 02/16/2022					
1305431 30c	Mastic	Black Non-Fibrous Homogenous	PLM 2% Cellulose	PLM 98% Other	PLM None Detected
Layer-2 Analyst: Scott Larabell Date Analyzed : 02/16/2022					

Polarized Light Microscopy Asbestos Analysis Report

To : LF Green Development, LLC
5600 W. Brown Deer Rd. Suite 104
Milwaukee, WI 53224

Location : Coggs Center
1220 W Vliet, Milwaukee WI

ETC Job : 245920
Client Project : N/A
Date Collected : 02/02/2022
Date Received : 02/14/2022

Sample	Description	Appearance	% Fibrous	% Non-Fibrous	% Asbestos
1305432 31a	Floor Tile	Red Non-Fibrous Homogenous	PLM 2% Cellulose	PLM 98% Other	PLM None Detected
Layer-1 Analyst: Scott Larabell Date Analyzed : 02/16/2022					
1305432 31a	Mastic	Black Non-Fibrous Homogenous	PLM 3% Cellulose	PLM 97% Other	PLM None Detected
Layer-2 Analyst: Scott Larabell Date Analyzed : 02/16/2022					
1305433 31b	Floor Tile	Red Non-Fibrous Homogenous	PLM 2% Cellulose	PLM 98% Other	PLM None Detected
Layer-1 Analyst: Scott Larabell Date Analyzed : 02/16/2022					
1305433 31b	Mastic	Black Non-Fibrous Homogenous	PLM 3% Cellulose	PLM 97% Other	PLM None Detected
Layer-2 Analyst: Scott Larabell Date Analyzed : 02/16/2022					
1305434 31c	Floor Tile	Red Non-Fibrous Homogenous	PLM 2% Cellulose	PLM 98% Other	PLM None Detected
Layer-1 Analyst: Scott Larabell Date Analyzed : 02/16/2022					
1305434 31c	Mastic	Black Non-Fibrous Homogenous	PLM 3% Cellulose	PLM 97% Other	PLM None Detected
Layer-2 Analyst: Scott Larabell Date Analyzed : 02/16/2022					

Polarized Light Microscopy Asbestos Analysis Report

To : LF Green Development, LLC
5600 W. Brown Deer Rd. Suite 104
Milwaukee, WI 53224

Location : Coggs Center
1220 W Vliet, Milwaukee WI

ETC Job : 245920
Client Project : N/A
Date Collected : 02/02/2022
Date Received : 02/14/2022

Sample	Description	Appearance	% Fibrous	% Non-Fibrous	% Asbestos
1305435 32a	Floor Tile	White Non-Fibrous Homogenous	PLM 2% Cellulose	PLM 98% Other	PLM None Detected
Layer-1 Analyst: Scott Larabell Date Analyzed : 02/16/2022					
1305435 32a	Mastic	Black Non-Fibrous Homogenous	PLM 3% Cellulose	PLM 97% Other	PLM None Detected
Layer-2 Analyst: Scott Larabell Date Analyzed : 02/16/2022					
1305436 32b	Floor Tile	White Non-Fibrous Homogenous	PLM 2% Cellulose	PLM 98% Other	PLM None Detected
Layer-1 Analyst: Scott Larabell Date Analyzed : 02/16/2022					
1305436 32b	Mastic	Black Non-Fibrous Homogenous	PLM 3% Cellulose	PLM 97% Other	PLM None Detected
Layer-2 Analyst: Scott Larabell Date Analyzed : 02/16/2022					
1305437 32c	Floor Tile	White Non-Fibrous Homogenous	PLM 2% Cellulose	PLM 98% Other	PLM None Detected
Layer-1 Analyst: Scott Larabell Date Analyzed : 02/16/2022					
1305437 32c	Mastic	Black Non-Fibrous Homogenous	PLM 2% Cellulose	PLM 98% Other	PLM None Detected
Layer-2 Analyst: Scott Larabell Date Analyzed : 02/16/2022					

Polarized Light Microscopy Asbestos Analysis Report

To : LF Green Development, LLC
5600 W. Brown Deer Rd. Suite 104
Milwaukee, WI 53224

Location : Coggs Center
1220 W Vliet, Milwaukee WI

ETC Job : 245920

Client Project : N/A

Date Collected : 02/02/2022

Date Received : 02/14/2022

Sample	Description	Appearance	% Fibrous	% Non-Fibrous	% Asbestos
1305438 33a	Floor Tile	Brown Non-Fibrous Homogenous	PLM 2% Cellulose	PLM 98% Other	PLM None Detected
Layer-1 Analyst: Scott Larabell Date Analyzed : 02/16/2022					
1305438 33a	Mastic	Black Non-Fibrous Homogenous	PLM 2% Cellulose	PLM 98% Other	PLM None Detected
Layer-2 Analyst: Scott Larabell Date Analyzed : 02/16/2022					
1305439 33b	Floor Tile	Brown Non-Fibrous Homogenous	PLM 2% Cellulose	PLM 98% Other	PLM None Detected
Layer-1 Analyst: Scott Larabell Date Analyzed : 02/16/2022					
1305439 33b	Mastic	Black Non-Fibrous Homogenous	PLM 3% Cellulose	PLM 97% Other	PLM None Detected
Layer-2 Analyst: Scott Larabell Date Analyzed : 02/16/2022					
1305440 33c	Floor Tile	Brown Non-Fibrous Homogenous	PLM 2% Cellulose	PLM 98% Other	PLM None Detected
Layer-1 Analyst: Scott Larabell Date Analyzed : 02/16/2022					
1305440 33c	Mastic	Black Non-Fibrous Homogenous	PLM 3% Cellulose	PLM 97% Other	PLM None Detected
Layer-2 Analyst: Scott Larabell Date Analyzed : 02/16/2022					

Polarized Light Microscopy Asbestos Analysis Report

To : LF Green Development, LLC
 5600 W. Brown Deer Rd. Suite 104
 Milwaukee, WI 53224

Location : Coggs Center
 1220 W Vliet, Milwaukee WI

ETC Job : 245920

Client Project : N/A

Date Collected : 02/02/2022

Date Received : 02/14/2022

Sample	Description	Appearance	% Fibrous	% Non-Fibrous	% Asbestos
1305441 34a	Ceiling Tile	White Fibrous Homogenous	PLM 2% Cellulose PLM 90% Mineral wool	PLM 8% Other	PLM None Detected

Analyst: Scott Larabell
 Date Analyzed : 02/16/2022

1305442 34b	Ceiling Tile	White Fibrous Homogenous	PLM 2% Cellulose PLM 90% Mineral wool	PLM 8% Other	PLM None Detected
----------------	--------------	--------------------------------	--	--------------	-------------------

Analyst: Scott Larabell
 Date Analyzed : 02/16/2022

1305443 34c	Ceiling Tile	White Fibrous Homogenous	PLM 2% Cellulose PLM 90% Mineral wool	PLM 8% Other	PLM None Detected
----------------	--------------	--------------------------------	--	--------------	-------------------

Analyst: Scott Larabell
 Date Analyzed : 02/16/2022

1305444 35a	Ceiling Tile	White Fibrous Homogenous	PLM 2% Cellulose PLM 50% Fiberglass	PLM 48% Other	PLM None Detected
----------------	--------------	--------------------------------	--	---------------	-------------------

Analyst: Scott Larabell
 Date Analyzed : 02/16/2022

1305445 35b	Ceiling Tile	White Fibrous Homogenous	PLM 3% Cellulose PLM 50% Fiberglass	PLM 47% Other	PLM None Detected
----------------	--------------	--------------------------------	--	---------------	-------------------

Analyst: Scott Larabell
 Date Analyzed : 02/16/2022

1305446 35c	Ceiling Tile	White Fibrous Homogenous	PLM 3% Cellulose PLM 50% Fiberglass	PLM 47% Other	PLM None Detected
----------------	--------------	--------------------------------	--	---------------	-------------------

Analyst: Scott Larabell
 Date Analyzed : 02/16/2022

Polarized Light Microscopy Asbestos Analysis Report

To : LF Green Development, LLC
 5600 W. Brown Deer Rd. Suite 104
 Milwaukee, WI 53224

Location : Coggs Center
 1220 W Vliet, Milwaukee WI

ETC Job : 245920

Client Project : N/A

Date Collected : 02/02/2022

Date Received : 02/14/2022

Sample	Description	Appearance	% Fibrous	% Non-Fibrous	% Asbestos
1305447 36a	Tile	Beige Non-Fibrous Homogenous	PLM 1% Cellulose	PLM 99% Other	PLM None Detected
Layer-1 Analyst: Daniel Agnew Date Analyzed : 02/16/2022					
1305447 36a	Mastic	Brown Non-Fibrous Homogenous	PLM 1% Cellulose	PLM 99% Other	PLM None Detected
Layer-2 Analyst: Daniel Agnew Date Analyzed : 02/16/2022					
1305448 36b	Tile	Beige Non-Fibrous Homogenous	PLM 1% Cellulose	PLM 99% Other	PLM None Detected
Layer-1 Analyst: Daniel Agnew Date Analyzed : 02/16/2022					
1305448 36b	Mastic	Brown Non-Fibrous Homogenous	PLM 1% Cellulose	PLM 99% Other	PLM None Detected
Layer-2 Analyst: Daniel Agnew Date Analyzed : 02/16/2022					
1305448 36b	Cementitious Material	Gray Non-Fibrous Homogenous	PLM 1% Cellulose	PLM 99% Other	PLM None Detected
Layer-3 Analyst: Daniel Agnew Date Analyzed : 02/16/2022					

Polarized Light Microscopy Asbestos Analysis Report

To : LF Green Development, LLC
 5600 W. Brown Deer Rd. Suite 104
 Milwaukee, WI 53224

Location : Coggs Center
 1220 W Vliet, Milwaukee WI

ETC Job : 245920

Client Project : N/A

Date Collected : 02/02/2022

Date Received : 02/14/2022

Sample	Description	Appearance	% Fibrous	% Non-Fibrous	% Asbestos
1305449 36c	Tile	Beige Non-Fibrous Homogenous	PLM 1% Cellulose	PLM 99% Other	PLM None Detected
Layer-1 Analyst: Daniel Agnew Date Analyzed : 02/16/2022					
1305449 36c	Mastic	Brown Non-Fibrous Homogenous	PLM 1% Cellulose	PLM 99% Other	PLM None Detected
Layer-2 Analyst: Daniel Agnew Date Analyzed : 02/16/2022					
1305450 37a	Tile	Gray Non-Fibrous Homogenous	PLM 1% Cellulose	PLM 99% Other	PLM None Detected
Layer-1 Analyst: Daniel Agnew Date Analyzed : 02/16/2022					
1305450 37a	Adhesive	Brown Non-Fibrous Homogenous	PLM 1% Cellulose	PLM 99% Other	PLM None Detected
Layer-2 Analyst: Daniel Agnew Date Analyzed : 02/16/2022					
1305450 37a	Grout	Gray Non-Fibrous Homogenous		PLM 100% Other	PLM None Detected
Layer-3 Analyst: Daniel Agnew Date Analyzed : 02/16/2022					

Polarized Light Microscopy Asbestos Analysis Report

To : LF Green Development, LLC
5600 W. Brown Deer Rd. Suite 104
Milwaukee, WI 53224

Location : Coggs Center
1220 W Vliet, Milwaukee WI

ETC Job : 245920

Client Project : N/A

Date Collected : 02/02/2022

Date Received : 02/14/2022

Sample	Description	Appearance	% Fibrous	% Non-Fibrous	% Asbestos
1305451 37b	Tile	Gray Non-Fibrous Homogenous	PLM 1% Cellulose	PLM 99% Other	PLM None Detected
Layer-1 Analyst: Daniel Agnew Date Analyzed : 02/16/2022					

1305451 37b	Adhesive	Brown Non-Fibrous Homogenous	PLM 1% Cellulose	PLM 99% Other	PLM None Detected
Layer-2 Analyst: Daniel Agnew Date Analyzed : 02/16/2022					

1305452 37c	Tile	Gray Non-Fibrous Homogenous	PLM 1% Cellulose	PLM 99% Other	PLM None Detected
Layer-1 Analyst: Daniel Agnew Date Analyzed : 02/16/2022					

1305452 37c	Adhesive	Brown Non-Fibrous Homogenous	PLM 1% Cellulose	PLM 99% Other	PLM None Detected
Layer-2 Analyst: Daniel Agnew Date Analyzed : 02/16/2022					

1305453 38a	Fibrous Material	White Fibrous Homogenous	PLM 1% Cellulose PLM 50% Fiberglass	PLM 49% Other	PLM None Detected
Analyst: Daniel Agnew Date Analyzed : 02/16/2022					

1305454 38b	Fibrous Material	White Fibrous Homogenous	PLM 1% Cellulose PLM 50% Fiberglass	PLM 49% Other	PLM None Detected
Analyst: Daniel Agnew Date Analyzed : 02/16/2022					

Polarized Light Microscopy Asbestos Analysis Report

To : LF Green Development, LLC
 5600 W. Brown Deer Rd. Suite 104
 Milwaukee, WI 53224

Location : Coggs Center
 1220 W Vliet, Milwaukee WI

ETC Job : 245920

Client Project : N/A

Date Collected : 02/02/2022

Date Received : 02/14/2022

Sample	Description	Appearance	% Fibrous	% Non-Fibrous	% Asbestos
1305455 38c	Fibrous Material	White Fibrous Homogenous	PLM 1% Cellulose PLM 50% Fiberglass	PLM 49% Other	PLM None Detected

Analyst: Daniel Agnew
 Date Analyzed : 02/16/2022

1305456 39a	Tile	Brown Non-Fibrous Homogenous	PLM 1% Cellulose	PLM 99% Other	PLM None Detected
----------------	------	------------------------------------	------------------	---------------	-------------------

Layer-1 Analyst: Daniel Agnew
 Date Analyzed : 02/16/2022

1305456 39a	Mastic	Gray Non-Fibrous Homogenous	PLM 1% Cellulose	PLM 99% Other	PLM None Detected
----------------	--------	-----------------------------------	------------------	---------------	-------------------

Layer-2 Analyst: Daniel Agnew
 Date Analyzed : 02/16/2022

1305457 39b	Tile	Brown Non-Fibrous Homogenous	PLM 1% Cellulose	PLM 99% Other	PLM None Detected
----------------	------	------------------------------------	------------------	---------------	-------------------

Layer-1 Analyst: Daniel Agnew
 Date Analyzed : 02/16/2022

1305457 39b	Mastic	Gray Non-Fibrous Homogenous	PLM 1% Cellulose	PLM 99% Other	PLM None Detected
----------------	--------	-----------------------------------	------------------	---------------	-------------------

Layer-2 Analyst: Daniel Agnew
 Date Analyzed : 02/16/2022

Polarized Light Microscopy Asbestos Analysis Report

To : LF Green Development, LLC
 5600 W. Brown Deer Rd. Suite 104
 Milwaukee, WI 53224

Location : Coggs Center
 1220 W Vliet, Milwaukee WI

ETC Job : 245920

Client Project : N/A

Date Collected : 02/02/2022

Date Received : 02/14/2022

Sample	Description	Appearance	% Fibrous	% Non-Fibrous	% Asbestos
1305458 39c	Tile	Brown Non-Fibrous Homogenous	PLM 1% Cellulose	PLM 99% Other	PLM None Detected
Layer-1 Analyst: Daniel Agnew Date Analyzed : 02/16/2022					
1305458 39c	Mastic	Gray Non-Fibrous Homogenous	PLM 1% Cellulose	PLM 99% Other	PLM None Detected
Layer-2 Analyst: Daniel Agnew Date Analyzed : 02/16/2022					
1305459 40a	Tile	Blue Non-Fibrous Homogenous	PLM 1% Cellulose	PLM 99% Other	PLM None Detected
Layer-1 Analyst: Erin Danhausen Date Analyzed : 02/16/2022					
1305459 40a	Mastic	Black Non-Fibrous Homogenous	PLM 2% Cellulose	PLM 98% Other	PLM None Detected
Layer-2 Analyst: Erin Danhausen Date Analyzed : 02/16/2022					
1305460 40b	Tile	Blue Non-Fibrous Homogenous	PLM 1% Cellulose	PLM 99% Other	PLM None Detected
Layer-1 Analyst: Erin Danhausen Date Analyzed : 02/16/2022					
1305460 40b	Mastic	Black Non-Fibrous Homogenous	PLM 2% Cellulose	PLM 98% Other	PLM None Detected
Layer-2 Analyst: Erin Danhausen Date Analyzed : 02/16/2022					

Polarized Light Microscopy Asbestos Analysis Report

To : LF Green Development, LLC
 5600 W. Brown Deer Rd. Suite 104
 Milwaukee, WI 53224

Location : Coggs Center
 1220 W Vliet, Milwaukee WI

ETC Job : 245920

Client Project : N/A

Date Collected : 02/02/2022

Date Received : 02/14/2022

Sample	Description	Appearance	% Fibrous	% Non-Fibrous	% Asbestos
1305461 40c	Tile	Blue Non-Fibrous Homogenous	PLM 1% Cellulose	PLM 99% Other	PLM None Detected
Layer-1 Analyst: Erin Danhausen Date Analyzed : 02/16/2022					
1305461 40c	Mastic	Black Non-Fibrous Homogenous	PLM 2% Cellulose	PLM 98% Other	PLM None Detected
Layer-2 Analyst: Erin Danhausen Date Analyzed : 02/16/2022					
1305462 41a	Tile	White Non-Fibrous Homogenous	PLM 1% Cellulose	PLM 99% Other	PLM None Detected
Layer-1 Analyst: Erin Danhausen Date Analyzed : 02/16/2022					
1305462 41a	Mastic	Black Non-Fibrous Homogenous	PLM 3% Cellulose	PLM 97% Other	PLM None Detected
Layer-2 Analyst: Erin Danhausen Date Analyzed : 02/16/2022					
1305463 41b	Tile	White Non-Fibrous Homogenous	PLM 1% Cellulose	PLM 99% Other	PLM None Detected
Layer-1 Analyst: Erin Danhausen Date Analyzed : 02/16/2022					
1305463 41b	Mastic	Black Non-Fibrous Homogenous	PLM 3% Cellulose	PLM 97% Other	PLM None Detected
Layer-2 Analyst: Erin Danhausen Date Analyzed : 02/16/2022					

Polarized Light Microscopy Asbestos Analysis Report

To : LF Green Development, LLC
5600 W. Brown Deer Rd. Suite 104
Milwaukee, WI 53224

Location : Coggs Center
1220 W Vliet, Milwaukee WI

ETC Job : 245920

Client Project : N/A

Date Collected : 02/02/2022

Date Received : 02/14/2022

Sample	Description	Appearance	% Fibrous	% Non-Fibrous	% Asbestos
1305464 41c	Tile	White Non-Fibrous Homogenous	PLM 1% Cellulose	PLM 99% Other	PLM None Detected
Layer-1 Analyst: Erin Danhausen Date Analyzed : 02/16/2022					
1305464 41c	Mastic	Black Non-Fibrous Homogenous	PLM 2% Cellulose	PLM 98% Other	PLM None Detected
Layer-2 Analyst: Erin Danhausen Date Analyzed : 02/16/2022					
1305465 42a	Tile	Red Non-Fibrous Homogenous	PLM 1% Cellulose	PLM 99% Other	PLM None Detected
Layer-1 Analyst: Erin Danhausen Date Analyzed : 02/16/2022					
1305465 42a	Mastic	Black Non-Fibrous Homogenous	PLM 2% Cellulose	PLM 98% Other	PLM None Detected
Layer-2 Analyst: Erin Danhausen Date Analyzed : 02/16/2022					
1305466 42b	Tile	Red Non-Fibrous Homogenous	PLM 1% Cellulose	PLM 99% Other	PLM None Detected
Layer-1 Analyst: Erin Danhausen Date Analyzed : 02/16/2022					
1305466 42b	Mastic	Black Non-Fibrous Homogenous	PLM 2% Cellulose	PLM 98% Other	PLM None Detected
Layer-2 Analyst: Erin Danhausen Date Analyzed : 02/16/2022					

Polarized Light Microscopy Asbestos Analysis Report

To : LF Green Development, LLC
5600 W. Brown Deer Rd. Suite 104
Milwaukee, WI 53224

Location : Coggs Center
1220 W Vliet, Milwaukee WI

ETC Job : 245920

Client Project : N/A

Date Collected : 02/02/2022

Date Received : 02/14/2022

Sample	Description	Appearance	% Fibrous	% Non-Fibrous	% Asbestos
1305467 42c	Tile	Red Non-Fibrous Homogenous	PLM 1% Cellulose	PLM 99% Other	PLM None Detected
Layer-1 Analyst: Erin Danhausen Date Analyzed : 02/16/2022					
1305467 42c	Mastic	Black Non-Fibrous Homogenous	PLM 2% Cellulose	PLM 98% Other	PLM None Detected
Layer-2 Analyst: Erin Danhausen Date Analyzed : 02/16/2022					
1305468 43a	Cementitious Material	Gray Non-Fibrous Homogenous	PLM 1% Cellulose	PLM 99% Other	PLM None Detected
Layer-1 Analyst: Erin Danhausen Date Analyzed : 02/16/2022					
1305469 43b	Cementitious Material	Gray Non-Fibrous Homogenous	PLM 1% Cellulose	PLM 99% Other	PLM None Detected
Layer-1 Analyst: Erin Danhausen Date Analyzed : 02/16/2022					
1305470 43c	Cementitious Material	Gray Non-Fibrous Homogenous	PLM 1% Cellulose	PLM 99% Other	PLM None Detected
Layer-1 Analyst: Erin Danhausen Date Analyzed : 02/16/2022					
1305471 44a	Cementitious Material	Gray Non-Fibrous Homogenous	PLM 1% Cellulose	PLM 99% Other	PLM None Detected
Layer-1 Analyst: Erin Danhausen Date Analyzed : 02/16/2022					

Polarized Light Microscopy Asbestos Analysis Report

To : LF Green Development, LLC
5600 W. Brown Deer Rd. Suite 104
Milwaukee, WI 53224

Location : Coggs Center
1220 W Vliet, Milwaukee WI

ETC Job : 245920

Client Project : N/A

Date Collected : 02/02/2022

Date Received : 02/14/2022

Sample	Description	Appearance	% Fibrous	% Non-Fibrous	% Asbestos
1305472 44b	Cementitious Material	Gray Non-Fibrous Homogenous	PLM 1% Cellulose	PLM 99% Other	PLM None Detected

Layer-1 Analyst: Erin Danhausen
Date Analyzed : 02/16/2022

1305473 44c	Cementitious Material	Gray Non-Fibrous Homogenous	PLM 1% Cellulose	PLM 99% Other	PLM None Detected
----------------	-----------------------	-----------------------------------	------------------	---------------	-------------------

Layer-1 Analyst: Erin Danhausen
Date Analyzed : 02/16/2022

1305474 45a	Cementitious Material	Gray Non-Fibrous Homogenous	PLM 1% Cellulose	PLM 99% Other	PLM None Detected
----------------	-----------------------	-----------------------------------	------------------	---------------	-------------------

Layer-1 Analyst: Erin Danhausen
Date Analyzed : 02/16/2022

1305475 45b	Cementitious Material	Gray Non-Fibrous Homogenous	PLM 1% Cellulose	PLM 99% Other	PLM None Detected
----------------	-----------------------	-----------------------------------	------------------	---------------	-------------------

Layer-1 Analyst: Erin Danhausen
Date Analyzed : 02/16/2022

1305476 45c	Cementitious Material	Gray Non-Fibrous Homogenous	PLM 1% Cellulose	PLM 99% Other	PLM None Detected
----------------	-----------------------	-----------------------------------	------------------	---------------	-------------------

Layer-1 Analyst: Erin Danhausen
Date Analyzed : 02/16/2022

1305477 46a	Cementitious Material	Gray Non-Fibrous Homogenous	PLM 1% Cellulose	PLM 99% Other	PLM None Detected
----------------	-----------------------	-----------------------------------	------------------	---------------	-------------------

Layer-1 Analyst: Erin Danhausen
Date Analyzed : 02/16/2022

Polarized Light Microscopy Asbestos Analysis Report

To : LF Green Development, LLC
 5600 W. Brown Deer Rd. Suite 104
 Milwaukee, WI 53224

Location : Coggs Center
 1220 W Vliet, Milwaukee WI

ETC Job : 245920

Client Project : N/A

Date Collected : 02/02/2022

Date Received : 02/14/2022

Sample	Description	Appearance	% Fibrous	% Non-Fibrous	% Asbestos
1305478 46b	Cementitious Material	Gray Non-Fibrous Homogenous	PLM 1% Cellulose	PLM 99% Other	PLM None Detected
Layer-1 Analyst: Erin Danhausen Date Analyzed : 02/16/2022					

1305479 46c	Cementitious Material	Gray Non-Fibrous Homogenous	PLM 1% Cellulose	PLM 99% Other	PLM None Detected
Layer-1 Analyst: Erin Danhausen Date Analyzed : 02/16/2022					

1305480 47a	Ceramic Tile	White Non-Fibrous Homogenous	PLM 1% Cellulose	PLM 99% Other	PLM None Detected
Layer-1 Analyst: Erin Danhausen Date Analyzed : 02/16/2022					

1305480 47a	Adhesive	Yellow Non-Fibrous Homogenous	PLM 1% Cellulose	PLM 99% Other	PLM None Detected
Layer-2 Analyst: Erin Danhausen Date Analyzed : 02/16/2022					

1305481 47b	Ceramic Tile	White Non-Fibrous Homogenous	PLM 1% Cellulose	PLM 99% Other	PLM None Detected
Layer-1 Analyst: Erin Danhausen Date Analyzed : 02/16/2022					

1305481 47b	Adhesive	Yellow Non-Fibrous Homogenous	PLM 1% Cellulose	PLM 99% Other	PLM None Detected
Layer-2 Analyst: Erin Danhausen Date Analyzed : 02/16/2022					



Polarized Light Microscopy Asbestos Analysis Report

To : LF Green Development, LLC
5600 W. Brown Deer Rd. Suite 104
Milwaukee, WI 53224

Location : Coggs Center
1220 W Vliet, Milwaukee WI

ETC Job : 245920

Client Project : N/A

Date Collected : 02/02/2022

Date Received : 02/14/2022

Sample	Description	Appearance	% Fibrous	% Non-Fibrous	% Asbestos
1305482 47c	Ceramic Tile	White Non-Fibrous Homogenous	PLM 1% Cellulose	PLM 99% Other	PLM None Detected
Layer-1 Analyst: Erin Danhausen Date Analyzed : 02/16/2022					
1305482 47c	Adhesive	Yellow Non-Fibrous Homogenous	PLM 1% Cellulose	PLM 99% Other	PLM None Detected
Layer-2 Analyst: Erin Danhausen Date Analyzed : 02/16/2022					
1305483 48a	Cementitious Material	Gray Non-Fibrous Homogenous	PLM 1% Cellulose	PLM 99% Other	PLM None Detected
Layer-1 Analyst: Erin Danhausen Date Analyzed : 02/16/2022					
1305483 48a	Ceramic Tile	White Non-Fibrous Homogenous	PLM 1% Cellulose	PLM 99% Other	PLM None Detected
Layer-2 Analyst: Erin Danhausen Date Analyzed : 02/16/2022					
1305484 48b	Cementitious Material	Gray Non-Fibrous Homogenous	PLM 1% Cellulose	PLM 99% Other	PLM None Detected
Layer-1 Analyst: Erin Danhausen Date Analyzed : 02/16/2022					
1305484 48b	Ceramic Tile	White Non-Fibrous Homogenous	PLM 1% Cellulose	PLM 99% Other	PLM None Detected
Layer-2 Analyst: Erin Danhausen Date Analyzed : 02/16/2022					

Polarized Light Microscopy Asbestos Analysis Report

To : LF Green Development, LLC
 5600 W. Brown Deer Rd. Suite 104
 Milwaukee, WI 53224

Location : Coggs Center
 1220 W Vliet, Milwaukee WI

ETC Job : 245920

Client Project : N/A

Date Collected : 02/02/2022

Date Received : 02/14/2022

Sample	Description	Appearance	% Fibrous	% Non-Fibrous	% Asbestos
1305485 48c	Cementitious Material	Gray Non-Fibrous Homogenous	PLM 1% Cellulose	PLM 99% Other	PLM None Detected

Layer-1 Analyst: Erin Danhausen
 Date Analyzed : 02/16/2022

1305485 48c	Ceramic Tile	White Non-Fibrous Homogenous	PLM 1% Cellulose	PLM 99% Other	PLM None Detected
----------------	--------------	------------------------------------	------------------	---------------	-------------------

Layer-2 Analyst: Erin Danhausen
 Date Analyzed : 02/16/2022

1305486 49a	Covebase	White Non-Fibrous Homogenous	PLM 1% Cellulose	PLM 99% Other	PLM None Detected
----------------	----------	------------------------------------	------------------	---------------	-------------------

Layer-1 Analyst: Erin Danhausen
 Date Analyzed : 02/16/2022

1305486 49a	Adhesive	Tan Non-Fibrous Homogenous	PLM 1% Cellulose	PLM 99% Other	PLM None Detected
----------------	----------	----------------------------------	------------------	---------------	-------------------

Layer-2 Analyst: Erin Danhausen
 Date Analyzed : 02/16/2022

1305487 49b	Covebase	White Non-Fibrous Homogenous	PLM 1% Cellulose	PLM 99% Other	PLM None Detected
----------------	----------	------------------------------------	------------------	---------------	-------------------

Layer-1 Analyst: Erin Danhausen
 Date Analyzed : 02/16/2022

1305487 49b	Adhesive	Tan Non-Fibrous Homogenous	PLM 1% Cellulose	PLM 99% Other	PLM None Detected
----------------	----------	----------------------------------	------------------	---------------	-------------------

Layer-2 Analyst: Erin Danhausen
 Date Analyzed : 02/16/2022

Polarized Light Microscopy Asbestos Analysis Report

To : LF Green Development, LLC
 5600 W. Brown Deer Rd. Suite 104
 Milwaukee, WI 53224

Location : Coggs Center
 1220 W Vliet, Milwaukee WI

ETC Job : 245920

Client Project : N/A

Date Collected : 02/02/2022

Date Received : 02/14/2022

Sample	Description	Appearance	% Fibrous	% Non-Fibrous	% Asbestos
1305488 49c	Covebase	White Non-Fibrous Homogenous	PLM 1% Cellulose	PLM 99% Other	PLM None Detected
Layer-1 Analyst: Erin Danhausen Date Analyzed : 02/16/2022					
1305488 49c	Adhesive	Tan Non-Fibrous Homogenous	PLM 1% Cellulose	PLM 99% Other	PLM None Detected
Layer-2 Analyst: Erin Danhausen Date Analyzed : 02/16/2022					
1305489 50a	Tile	Tan Non-Fibrous Homogenous	PLM 1% Cellulose	PLM 99% Other	PLM None Detected
Layer-1 Analyst: Erin Danhausen Date Analyzed : 02/16/2022					
1305490 50b	Tile	Tan Non-Fibrous Homogenous	PLM 1% Cellulose	PLM 99% Other	PLM None Detected
Layer-1 Analyst: Erin Danhausen Date Analyzed : 02/16/2022					
1305490 50b	Mastic	Black Non-Fibrous Homogenous	PLM 2% Cellulose	PLM 98% Other	PLM None Detected
Layer-2 Analyst: Erin Danhausen Date Analyzed : 02/16/2022					

Polarized Light Microscopy Asbestos Analysis Report

To : LF Green Development, LLC
 5600 W. Brown Deer Rd. Suite 104
 Milwaukee, WI 53224

Location : Coggs Center
 1220 W Vliet, Milwaukee WI

ETC Job : 245920

Client Project : N/A

Date Collected : 02/02/2022

Date Received : 02/14/2022

Sample	Description	Appearance	% Fibrous	% Non-Fibrous	% Asbestos
1305491 50c	Tile	Tan Non-Fibrous Homogenous	PLM 1% Cellulose	PLM 99% Other	PLM None Detected
Layer-1 Analyst: Erin Danhausen Date Analyzed : 02/16/2022					
1305491 50c	Mastic	Black Non-Fibrous Homogenous	PLM 2% Cellulose	PLM 98% Other	PLM None Detected
Layer-2 Analyst: Erin Danhausen Date Analyzed : 02/16/2022					
1306818 51a	Tile	White Fibrous Homogenous	PLM 90% Cellulose	PLM 10% Other	PLM None Detected
Layer-1 Analyst: Erin Danhausen Date Analyzed : 02/16/2022					
1306819 51b	Tile	White Fibrous Homogenous	PLM 90% Cellulose	PLM 10% Other	PLM None Detected
Layer-1 Analyst: Erin Danhausen Date Analyzed : 02/16/2022					

Polarized Light Microscopy Asbestos Analysis Report

To : LF Green Development, LLC
5600 W. Brown Deer Rd. Suite 104
Milwaukee, WI 53224

Location : Coggs Center
1220 W Vliet, Milwaukee WI

ETC Job : 245920

Client Project : N/A

Date Collected : 02/02/2022

Date Received : 02/14/2022

Sample	Description	Appearance	% Fibrous	% Non-Fibrous	% Asbestos
1306820 51c	Tile	White Fibrous Homogenous	PLM 90% Cellulose	PLM 10% Other	PLM None Detected
Layer-1 Analyst: Erin Danhausen Date Analyzed : 02/16/2022					

Ian Moosker
Lab Supervisor/Other Signatory

Analyst:

Daniel Agnew

Daniel Agnew

E. Danhausen

Erin Danhausen

Orlando James Ivey Jr.

OJ Ivey

Scott Larabell

Scott Larabell

400 Point Count Results by EPA 600/R-93/116 PLM (denoted by "PC")
Item 198.1: PLM Methods for Identifying and Quantitating Asbestos in Bulk Samples
Item 198.6: PLM Methods for Identifying and Quantitating Asbestos in Non-Friable Organically Bound Bulk Samples
EPA 600/R-93/116: Method for Determination of Asbestos in Bulk Building Materials
EPA 600/M4-82-020: Interim Method for Determination of Asbestos in Bulk Insulation Samples
A % Asbestos result of "Trace" indicates that the analyzed material was found to contain less than 1% asbestos and would not be considered an Asbestos Containing Material (ACM).

ETL, Inc. maintains liability limited to cost of analysis. This report relates only to the samples reported and may not be reproduced without written approval by ETL, Inc. Test Method EPA 600/R-93-116 & EPA 600/M4-82/020 or NYSDOH-ELAP item 198.1 and/or 198.6 was used to analyze all samples. Matrix interference and/or resolution limits (i.e. detecting asbestos in non-friable organically bound materials) may yield false results in certain circumstances. Quantitative transmission electron microscopy (TEM) is currently the only method that can pronounce materials as non-asbestos containing. Interpretation and use of test results are the responsibility of the client. ETL, Inc. is not responsible for the accuracy of the results when requested to physically separate and analyze layered samples. Any PLM results below 10% should be re-analyzed using the EPA recommended Point Count method. Any material that has greater than 1% asbestos content is considered to be an Asbestos Containing Material (ACM). These materials are regulated by both OSHA and the EPA and must be treated accordingly. Results are related to only to samples that were tested. An estimate of uncertainty can be provided at the client's request.

ENVIRONMENTAL TESTING LABORATORIES, INC



37575 W HURON RIVER DRIVE
ROMULUS, MICHIGAN 48174
(734) 955-6600
FAX: (734) 992-2261
www.2etl.com

Asbestos / Mold Chain of Custody

Client: LF Green Development, LLC		Contact: Linda Fellenz	ETL Project #: 245920
Address: 5600 W. Brown Deer Rd., Suite 104		Phone: 414-254-4813	Project Location/Name: 1220 W. Vliet, Milwaukee, WI COGGS Center
Milwaukee, WI 53223		Fax: 414-375-4098	Client Project #:
Please Provide Results: <input type="checkbox"/> Email <input type="checkbox"/> Fax <input type="checkbox"/> Verbal <input type="checkbox"/> Other		E-mail: lfellenz@lfgreendev.com	Date Sampled: 2/2-2/9/2022

Turnaround Time (TAT): ☐ RUSH (2 hrs) ☐ Same Day ☐ 24 hrs ☒ 48 hrs ☐ 72 hrs ☐ Standard (5 days)
(If not checked, standard turnaround will be assumed) TAT Based on business days Monday-Friday

Sample Type (Check Only One)

Asbestos: Bulk (PLM) ☐ Bulk (TEM) ☐ Dust ☐ Air (PCM) ☐ Air (TEM) ☐ Mold: Tape ☐ Bulk ☐ Air-O-Cell ☐ Air (Other) ☐ Nuisance Dust ☐

Asbestos Analysis Information (Check all that Apply)

Stop at 1st Positive: Yes ☒ No ☐
(Clearly mark each homogeneous area)

Point Counting: Yes ☐ No ☐ *400 Points ☐ *1000 Points ☐

*Gravimetric Reduction ☐ *Soil or Vermiculite Analysis ☐

Point Counting Criteria:

*Additional charge and turnaround may be required

Lab ID	Sample ID	Sample Location	Material or Sample Description	Air Samples Only		
				Start	Stop	Volume
	1abc	328 329 330				
	2abc	331 332 333				
	3abc	334 335 336				
	4abc	337 338 339				
	5abcde	340 341 342 343 344				
	6ABC	345 346 347				
	7abc	348 349 350				
	8abcdefg	351 352 353 354 355 356 357				
	9abc	358 359 360				
	10abc	361 362 363				
	11abcde	364 365 366 367 368				
	12abc	369 370 371				

Relinquished (Name/Organization):	<i>Linda Fellenz</i>	Date:	2/2/2022	Time:	AM / PM
Received (Name/ETL):	<i>[Signature]</i>	Date:	2/14/22	Time:	1449 AM / PM
Stereoscopy/Sample Analysis (N):	<i>2-16-22</i>				
Special Instructions:	9/11/Am				
Remarks:					

**IN ORDER TO ENSURE RESULTS BY SPECIFIED TAT, THE LAB MUST BE EMAILED/CALLED WITH THE QUANTITY OF SAMPLES TO BE SHIPPED OR DROPPED OFF
**RUSHES ARE NOT ACCEPTED AFTER 3:00 PM AND SAME DAYS ARE NOT ACCEPTED AFTER 2:00 PM

ENVIRONMENTAL TESTING LABORATORIES, INC



37575 W HURON RIVER DRIVE
ROMULUS, MICHIGAN 48174
(734) 955-6600
FAX: (734) 992-2261
www.2etl.com

Asbestos / Mold Chain of Custody

Client: LF Green Development, LLC		Contact: Linda Fellenz	ETL Project #: 245920
Address: 5600 W. Brown Deer Rd., Suite 104		Phone: 414-254-4813	Project Location/Name: 1220 W. Vliet, Milwaukee, WI
Milwaukee, WI 53223		Fax: 414-375-4098	COGGS Center
Please Provide Results: <input type="checkbox"/> Email <input type="checkbox"/> Fax <input type="checkbox"/> Verbal <input type="checkbox"/> Other		E-mail: lfellenz@lfgreendev.com	Client Project #:
			Date Sampled: 2/2-2/9/2022

Turnaround Time (TAT): ☐ RUSH (2 hrs) ☐ Same Day ☐ 24 hrs ☐ 48 hrs ☐ 72 hrs ☐ Standard (5 days)
(If not checked, standard turnaround will be assumed) TAT Based on Business Hours Monday-Friday

Sample Type (Check Only One)

Asbestos: Bulk (PLM) ☐ Bulk (TEM) ☐ Dust ☐ Air (PCM) ☐ Air (TEM) ☐ Mold: Tape ☐ Bulk ☐ Air-O-Cell ☐ Air (Other) ☐ Nuisance Dust ☐

Asbestos Analysis Information (Check all that Apply)

Stop at 1st Positive: Yes ☐ / No ☐
(Clearly mark each homogeneous area)

Point Counting: Yes ☐ / No ☐ *400 Points ☐ *1000 Points ☐

*Gravimetric Reduction ☐ *Soil or Vermiculite Analysis ☐

Point Counting Criteria:

*Additional charge and turnaround may be required

Lab ID	Sample ID	Sample Location	Material or Sample Description	Air Samples Only		
				Start	Stop	Volume
	13 abc	372 373 374				
	14 abc	375 376 377				
	15 abc	378 379 380				
	16 abc	381 382 383				
	17 abc	384 385 386				
	18 abc	390 391 392 393 394	395			
	19 abc	396 397 398				
	20 abc	399 400 401				
	21 abc	402 403 404				
	22 abc	405 406 407				
	23 abc	408 409 410				
	24 abc	411 412 413				

Relinquished (Name/Organization): Linda Fellenz	Date: 2/2/2022	Time: 10:11 AM
Received (Name/ETL):	Date: 2-14-22	Time: 1:45 PM
Stereoscopy/Sample Analysis (H):	2-16-22 9:11 AM	
Special Instructions:	Remarks:	

**IN ORDER TO ENSURE RESULTS BY SPECIFIED TAT, THE LAB MUST BE EMAILED/CALLED WITH THE QUANTITY OF SAMPLES TO BE SHIPPED OR DROPPED OFF
**RUSHES ARE NOT ACCEPTED AFTER 3:00 PM AND SAME DAYS ARE NOT ACCEPTED AFTER 2:00 PM

ENVIRONMENTAL TESTING LABORATORIES, INC



37575 W HURON RIVER DRIVE
ROMULUS, MICHIGAN 48174
(734) 955-6600
FAX: (734) 992-2261
www.2etl.com

Asbestos / Mold Chain of Custody

Client: LF Green Development, LLC		Contact: Linda Fellenz	ETL Project #: 245930
Address: 5600 W. Brown Deer Rd., Suite 104		Phone: 414-254-4813	Project Location/Name: 1220 W. Vliet, Milwaukee, WI COGGS Center
Milwaukee, WI 53223		Fax: 414-375-4098	Client Project #:
Please Provide Results: <input type="checkbox"/> Email <input type="checkbox"/> Fax <input type="checkbox"/> Verbal <input type="checkbox"/> Other		E-mail: lfellenz@lfgreendev.com	Date Sampled: 2/2-2/9/2022

Turnaround Time (TAT): ☐ RUSH (2 hrs) ☐ Same Day ☐ 24 hrs ☐ 48 hrs ☐ 72 hrs ☐ Standard (5 days)

(If not checked, standard turnaround will be assumed) TAT Based on Business Hours Monday-Friday

Sample Type (Check Only One)

Asbestos: Bulk (PLM) ☐ Bulk (TEM) ☐ Dust ☐ Air (PCM) ☐ Air (TEM) ☐ Mold: Tape ☐ Bulk ☐ Air-O-Cell ☐ Air (Other) ☐ Nuisance Dust ☐

Asbestos Analysis Information (Check all that Apply)

Stop at 1st Positive: Yes ☒ / No ☐

(Clearly mark each homogeneous area)

Point Counting: Yes ☐ / No ☐ *400 Points ☐ *1000 Points ☐

*Gravimetric Reduction ☐ *Soil or Vermiculite Analysis ☐

Point Counting Criteria:

* Additional charge and turnaround may be required

Lab ID	Sample ID	Sample Location	Material or Sample Description	Air Samples Only		
				Start	Stop	Volume
25abc	414 415 416					
26abc	417 418 419					
27abc	420 421 422					
28abc	423 424 425					
29abc	426 427 428					
30abc	429 430 431					
31abc	432 433 434					
32abc	435 436 437					
33abc	438 439 440					
34abc	441 442 443					
35abc	444 445 446					
36abc	447 448 449					

Relinquished (Name/Organization): Linda Fellenz	Date: 2/2/2022	Time: 1:44 PM
Received (Name/ETL):	Date: 2/14/22	Time: 1:44 PM
Stereoscopic/Sample Analysis: [Signature]	Date: 2/16/22	
Special Instructions: [Signature]	Date: 9:11 AM	Remarks:

**IN ORDER TO ENSURE RESULTS BY SPECIFIED TAT, THE LAB MUST BE EMAILED/CALLED WITH THE QUANTITY OF SAMPLES TO BE SHIPPED OR DROPPED OFF

**RUSHES ARE NOT ACCEPTED AFTER 3:00 PM AND SAME DAYS ARE NOT ACCEPTED AFTER 2:00 PM

ENVIRONMENTAL TESTING LABORATORIES, INC



37575 W HURON RIVER DRIVE
ROMULUS, MICHIGAN 48174
(734) 955-6600
FAX: (734) 992-2261
www.2etl.com

Asbestos / Mold Chain of Custody

Client: LF Green Development, LLC		Contact: Linda Fellenz	ETL Project #: 245920
Address: 5600 W. Brown Deer Rd., Suite 104		Phone: 414-254-4813	Project Location/Name: 1220 W. Vliet, Milwaukee, WI COGGS Center
Milwaukee, WI 53223		Fax: 414-375-4098	Client Project #:
Please Provide Results: <input type="checkbox"/> Email <input type="checkbox"/> Fax <input type="checkbox"/> Verbal <input type="checkbox"/> Other _____		E-mail: lfellenz@lfgreendev.com	Date Sampled: 2/2-2/9/2022

Turnaround Time (TAT): ☐ RUSH (2 hrs) ☐ Same Day ☐ 24 hrs ☐ 48 hrs ☐ 72 hrs ☐ Standard (5 days)
(If not checked, standard turnaround will be assumed) TAT Based on Business Hours Monday-Friday

Sample Type (Check Only One)

Asbestos: Bulk (PLM) ☐ Bulk (TEM) ☐ Dust ☐ Air (PCM) ☐ Air (TEM) ☐ Mold: Tape ☐ Bulk ☐ Air-O-Cell ☐ Air (Other) ☐ Nuisance Dust ☐

Asbestos Analysis Information (Check all that Apply)

Stop at 1st Positive: Yes ☒ / No ☐
(Clearly mark each homogeneous area)

Point Counting: Yes ☐ / No ☐ *400 Points ☐ *1000 Points ☐

*Gravimetric Reduction ☐ *Soil or Vermiculite Analysis ☐

Point Counting Criteria:

*Additional charge and turnaround may be required

Lab ID	Sample ID	Sample Location	Material or Sample Description	Air Samples Only		
				Start	Stop	Volume
	37abc	450 451 452				
	38abc	453 454 455				
	39abc	456 457 458				
	40abc	459 460 461				
	41abc	462 463 464				
	42abc	465 466 467				
	43abc	468 469 470				
	44abc	471 472 473				
	45abc	474 475 476				
	46abc	477 478 479				
	47abc	480 481 482				
	48abc	483 484 485				

Relinquished (Name/Organization): Linda Fellenz	Date: 02/11/2022	Time: 2:14 PM
Received (Name/ETL): [Signature]	Date: 2-16-22	Time: 9:11 AM
Stereoscopical/Sample Analysis (N): [Signature]	Remarks:	

**IN ORDER TO ENSURE RESULTS BY SPECIFIED TAT, THE LAB MUST BE EMAILED/CALLED WITH THE QUANTITY OF SAMPLES TO BE SHIPPED OR DROPPED OFF
**RUSHES ARE NOT ACCEPTED AFTER 3:00 PM AND SAME DAYS ARE NOT ACCEPTED AFTER 2:00 PM

Asbestos / Mold Chain of Custody

Turnaround Time (TAT): ☐ RUSH (2 hrs) ☐ Same Day ☐ 24 hrs ☐ 48 hrs ☐ 72 hrs ☐ Standard (5 days)
(If not checked, standard turnaround will be assumed) TAT Based on Business Hours Monday-Friday

Asbestos Analysis Information (Check all that Apply)

1305

Page 1 of 5