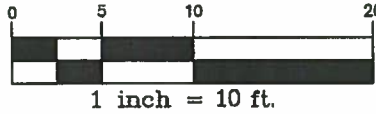

EXHIBIT "A" FOR EASEMENT

LOCATED IN PART THE NORTHEAST QUARTER OF THE NORTHEAST QUARTER OF SECTION 15, TOWNSHIP 07 NORTH, RANGE 22 EAST, CITY OF MILWAUKEE, MILWAUKEE COUNTY, WISCONSIN.



LEGEND

- SET 3/8"x12" SPIKE
- △ SET PK NAIL
- ⊙ SECTION CORNER MONUMENT OF RECORD

APPROVED FOR DESCRIPTION

[Signature]
 COUNTY DTPW
 4/16/12

EAST KENWOOD BOULEVARD

NORTH QUARTER CORNER OF SEC. 15, T07N, R22E FOUND BRASS CAP

N88° 38' 48"E
 5.00'

NORTHEAST CORNER OF SEC. 15, T07N, R22E FOUND BRASS CAP

S88° 38' 48"W
 2225.83' R.O.W.

S88° 38' 48"W
 396.61' R.O.W.

NORTH LAKE PARK ROAD

BACK OF CURB N01° 07' 40"E 80.84'

5' STRIP EASEMENT

S01° 07' 42"W 80.84'

SIDEWALK

COMMUNICATIONS MANHOLE

PK NAIL ABUTTING MANHOLE RIM

S88° 38' 48"W
 5.00'

Legal Description of Easement:

Located in part of the Northeast Quarter of the Northeast Quarter of Section 15, Township 07 North, Range 22 East, City of Milwaukee, Milwaukee County, Wisconsin, more particularly described as follows:

Commencing at the Northeast Corner of said Section 15; thence, on an assumed bearing along the north line of said Section 15, also being the south right-of-way line of East Kenwood Boulevard, South 88 degrees 38 minutes 48 seconds West a distance of 396.61 feet to the point of beginning; thence South 01 degrees 07 minutes 42 seconds West a distance of 80.84 feet; thence, parallel with said north line, South 88 degrees 38 minutes 48 seconds West a distance of 5.00 feet; thence North 01 degrees 07 minutes 40 seconds East a distance of 80.84 feet to said north line; thence, along said north line, North 88 degrees 38 minutes 48 seconds East a distance of 5.00 feet to the point of beginning.

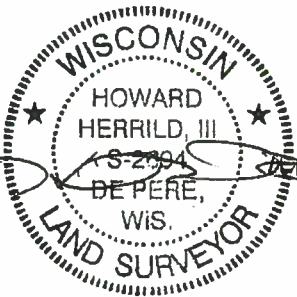

APRIL 13, 2012



1700 Industrial Drive
 Green Bay, WI 54302
 920.465.8018

NORTH LINCOLN MEMORIAL DRIVE

TW-84534