

### SURVEY NOTES

1. THE BASE SURVEY WAS PREPARED BY GRAEF IN 2022. ALL UNDERGROUND UTILITIES AND STRUCTURES HAVE BEEN SHOWN TO A REASONABLE DEGREE OF ACCURACY AND IT SHALL BE THE CONTRACTOR'S RESPONSIBILITY TO VERIFY THEIR EXACT LOCATION AND TO AVOID DAMAGE THERE TO.
2. WISCONSIN COORDINATE REFERENCE SYSTEM (WISCRS) MILWAUKEE COUNTY NAD83 (2011). VERTICAL DID A ONE POINT VERTICAL ONLY CALIBRATION TO R.B.M. A RAIL ROAD SPIKE AT THE E. 1/4 CORNER SECT. 02-05-22. REDUCED THE NVD29 ELEVATION (663.902') OF THE FIRE HYDRANT BY 0.18' (663.722') PER DATA SHEET TO GET TO NAVD88(2012), WISCONSIN GEOID 18.
3. DIGGERS HOTLINE PLANNING PRINT TICKET #20222205406, 20222205448, 20222205493, 20222205611 & 20222205690 NON-RESPONDERS: AT&T CITY OF SOUTH MILWAUKEE EVERSTREAM

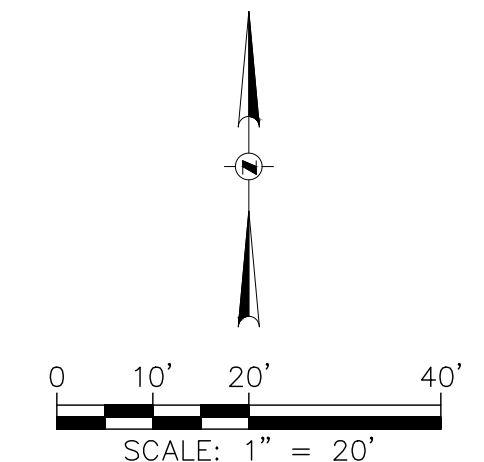

### LEGEND

- ▲ TRAVERSE POINT
- BM BENCH MARK
- POWER POLE
- ⊠ LIGHT POLE
- FLAG POLE
- MANHOLE
- ⊞ STORM INLET
- ⊙ WV WATER VALVE
- ⊙ WMH WATER MANHOLE
- ⊙ GV GAS VALVE
- ⊙ FH FIRE HYDRANT
- ⊠ ELECTRIC TRANSFORMER
- ⊠ CONTROL BOX
- GATE GATE POST
- TILE DRAIN TILE
- ⊙ DECIDUOUS TREE
- ⊙ BUSH
- ⊙ SIGN
- ⊠ EL. R. ELECTRIC RISER
- ⊠ E.M. ELECTRIC METER
- ⊠ STUMP
- EDGE OF WOODS
- - - CHAIN LINK FENCE
- - - GUARD RAIL
- - - BURIED ELECTRIC LINE
- - - OVERHEAD ELECTRIC LINE
- - - BURIED GAS MAIN
- - - BURIED TELEPHONE LINE
- - - BURIED WATER MAIN

### CONTROL POINTS

CP-1 3/8" REBAR W/YELLOW GRAEF CAP N. 257,035.42 E. 616,027.62 EL. 650.13'	CP-2 3/8" REBAR W/YELLOW GRAEF CAP N. 257,351.08 E. 615,593.20 EL. 648.13'
CP-3 3/8" REBAR W/YELLOW GRAEF CAP N. 255,683.71 E. 616,739.97 EL. 676.18'	CP-4 3/8" REBAR W/YELLOW GRAEF CAP N. 256,047.15 E. 616,436.04 EL. 675.38'
CP-5 CUT CROSS N. 256,915.77 E. 617,381.23 EL. 640.94'	CP-6 CUT CROSS N. 257,195.92 E. 617,533.46 EL. 640.21'
CP-7 3/8" REBAR W/YELLOW GRAEF CAP N. 256,982.21 E. 617,943.02 EL. 636.15'	CP-8 MAG NAIL N. 256,785.39 E. 617,864.30 EL. 636.93'
CP-9 MAG NAIL N. 256,815.96 E. 617,533.32 EL. 639.29'	

### BENCHMARKS

RBM	FOUND R.R. SPIKE IN NORTHEAST FACE OF POWER POLE #69-7116. ELEVATION = 655.22'
BM #1	FOUND CHISELED "x" IN E'LY FLANGE BOLT OF S. 15TH ST. AND BEECH ST. ELEVATION = 663.72'
BM #2	NORTH BOLT OF FLAG POLE CONC. BASE AT SOUTH END OF "JOHN GALEWSKI FIELD" JUST WEST OF THE PRESS BOX. ELEVATION = 648.01' (SHOWN)
BM #3	GEAR SPIKE AT GRADE IN SOUTHWEST FACE OF LIGHT POLE ON THE WEST SIDE OF OAK CREEK PARKWAY, 4TH POLE NORTH OF BEECH ST. ELEVATION = 647.68' (SHOWN)
BM #4	GEAR SPIKE IN POWER POLE #03-13554 AT EAST END OF PINE ST. SECOND POLE SOUTH OF PINE ST. ON THE WEST SIDE OF ALLEY. ELEVATION = 678.58' (SHOWN)
BM #5	SOUTHWEST BOLT (TAG BOLT) OF FIRE HYDRANT AT SOUTHEAST CORNER OF STUDENT PARKING LOT, AT MAIN PED. ENTRANCE INTO FOOTBALL FIELD. ELEVATION = 642.10' (SHOWN)
BM #6	CUT BOX IN NORTH SIDE OF CONC. BASE FOR EAST SUPPORT COLUMN FOR SOUTH MILWAUKEE FOOTBALL SCORE BOARD. ELEVATION = 637.73' (SHOWN)

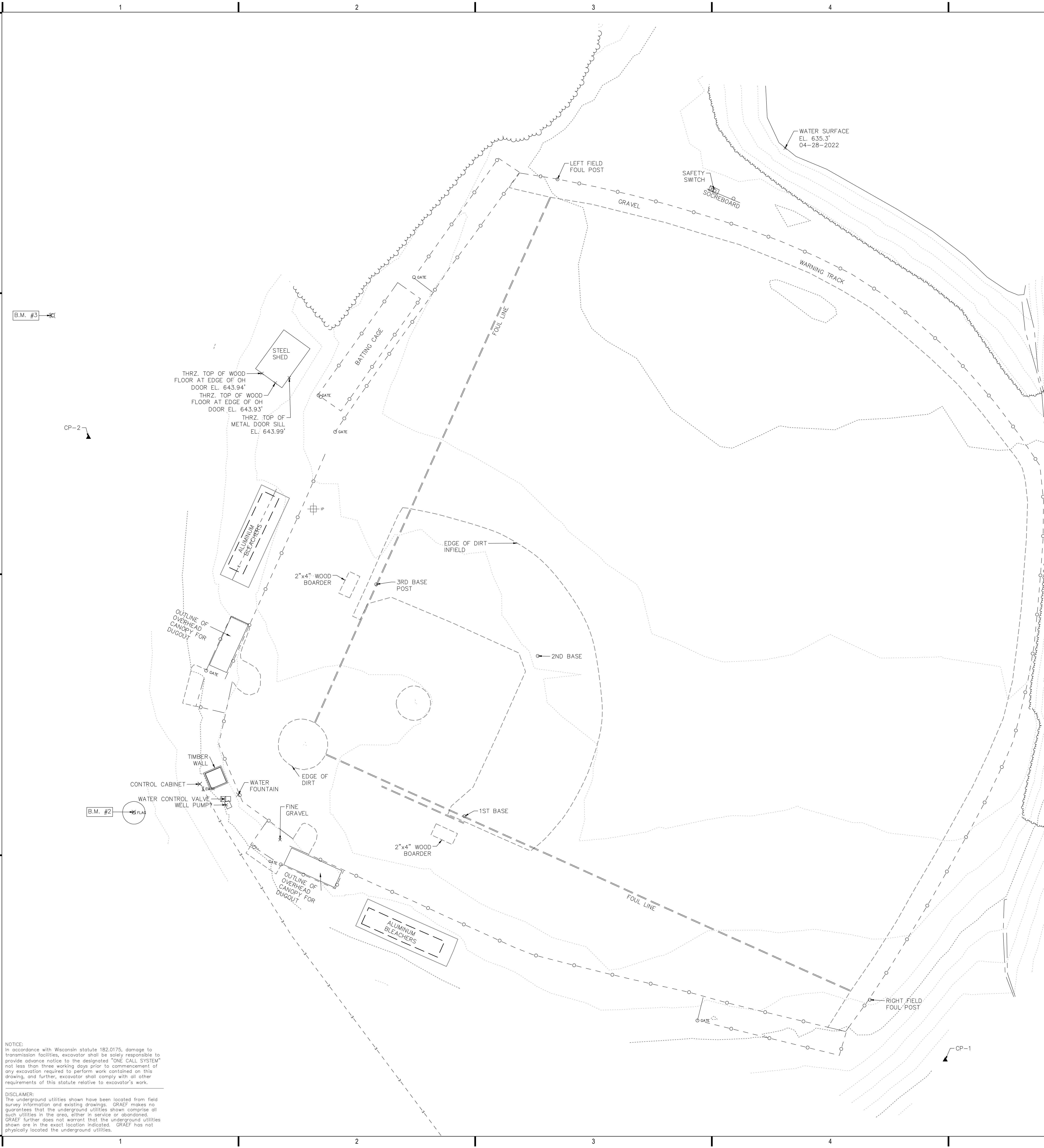

**NOTICE:**  
In accordance with Wisconsin statute 182.0175, damage to transmission facilities, excavator shall be solely responsible to provide advance notice to the designated "ONE CALL SYSTEM" not less than three working days prior to commencement of any excavation required to perform work contained on this drawing, and further, excavator shall comply with all other requirements of this statute relative to excavator's work.

**DISCLAIMER:**  
The underground utilities shown have been located from field survey information and existing drawings. GRAEF makes no guarantee that the underground utilities shown comprise all such utilities in the area, either in service or abandoned. GRAEF further does not warrant that the underground utilities shown are in the exact location indicated. GRAEF has not physically located the underground utilities.

**PROJECT TITLE:**  
SOUTH MILWAUKEE HIGH SCHOOL  
ATHLETIC FIELD IMPROVEMENTS

801 15TH AVENUE  
SOUTH MILWAUKEE, WI 53172

NO.	DATE	REVISIONS	BY

CONSTRUCTION DOCUMENTS

**PROJECT INFORMATION:**

PROJECT NUMBER: 2021-0492  
DATE: 10-14-2022  
DRAWN BY: MDS  
CHECKED BY: BRJ  
APPROVED BY: JFP  
SCALE: AS SHOWN

**SHEET TITLE:**  
EXISTING CONDITIONS PLAN -  
BASEBALL FIELD

**SHEET NUMBER:**

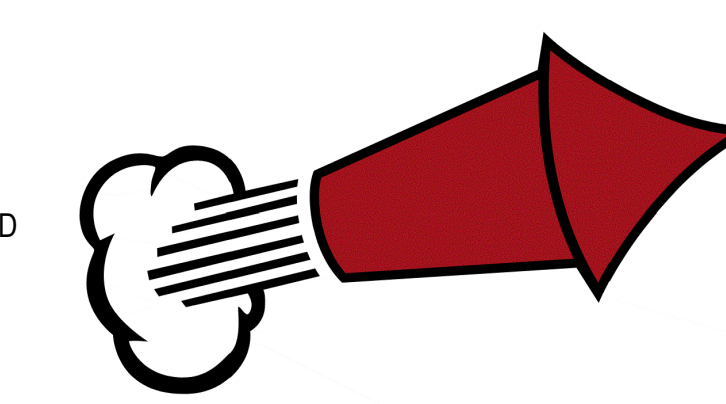

### GENERAL NOTES

1. THE BASE SURVEY WAS PREPARED BY GRAEF IN 2022. ALL UNDERGROUND UTILITIES AND STRUCTURES HAVE BEEN SHOWN TO A REASONABLE DEGREE OF ACCURACY AND IT SHALL BE THE CONTRACTOR'S RESPONSIBILITY TO VERIFY THEIR EXACT LOCATION AND TO AVOID DAMAGE THERETO.
2. REFER TO SHEET C100 AND C101 FOR BENCHMARKS, DATUM, AND TOPOGRAPHIC ELEMENTS.
3. CONTRACTOR SHALL VERIFY LOCATION OF WORK AND REPORT ANY DISCREPANCIES TO THE ENGINEER PRIOR TO COMMENCING WORK.

### LEGEND

- STONE CONSTRUCTION ENTRANCE
- SILT FENCE
- INLET PROTECTION

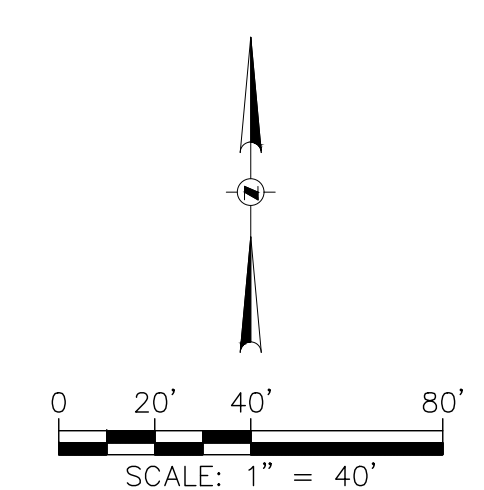

### REMOVAL NOTES

1. SEE SHEET C200 FOR REMOVAL NOTES.

### EROSION CONTROL NOTES

1. SEE SHEET C200 FOR REMOVAL NOTES.

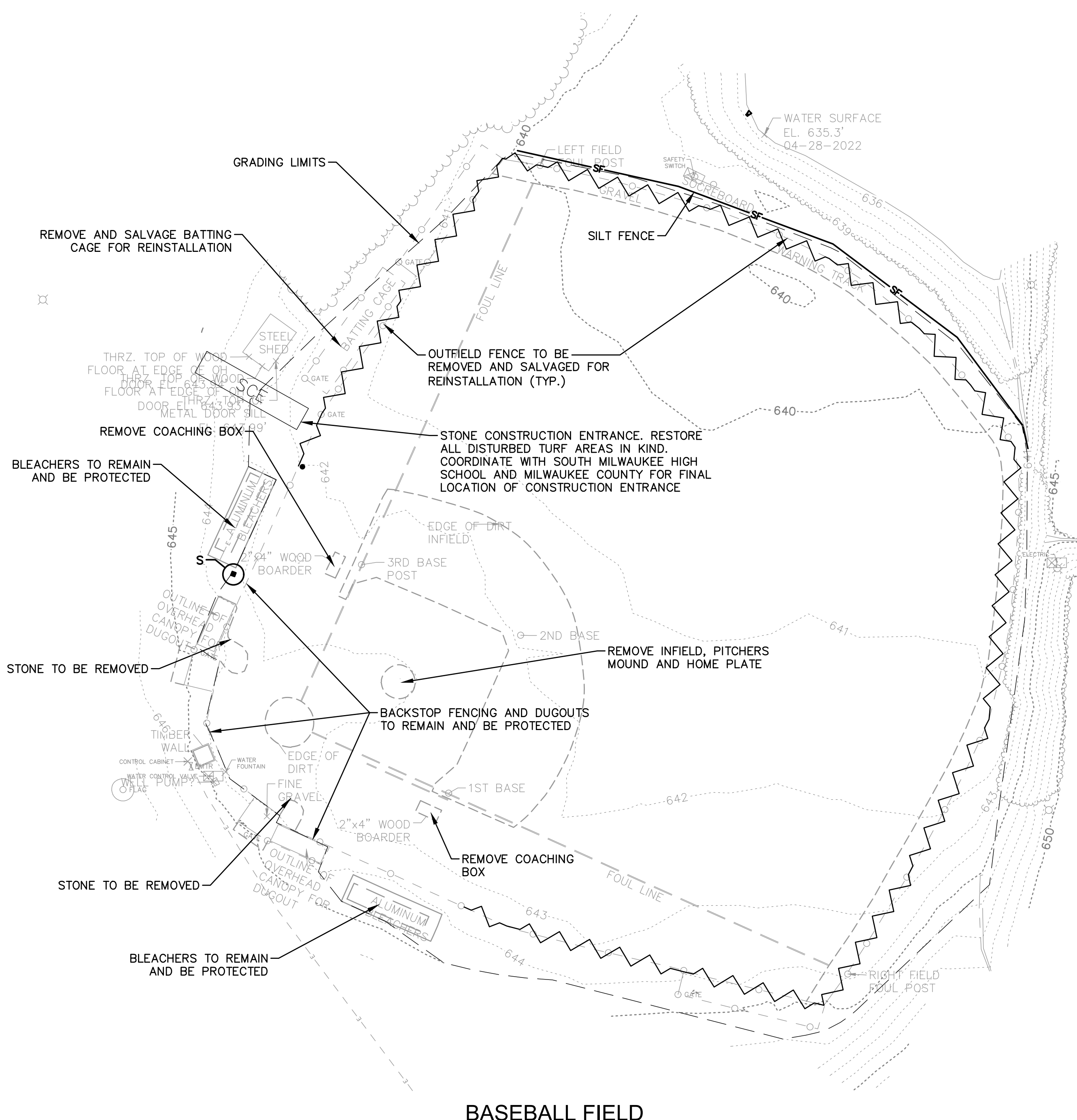

**BASEBALL FIELD**

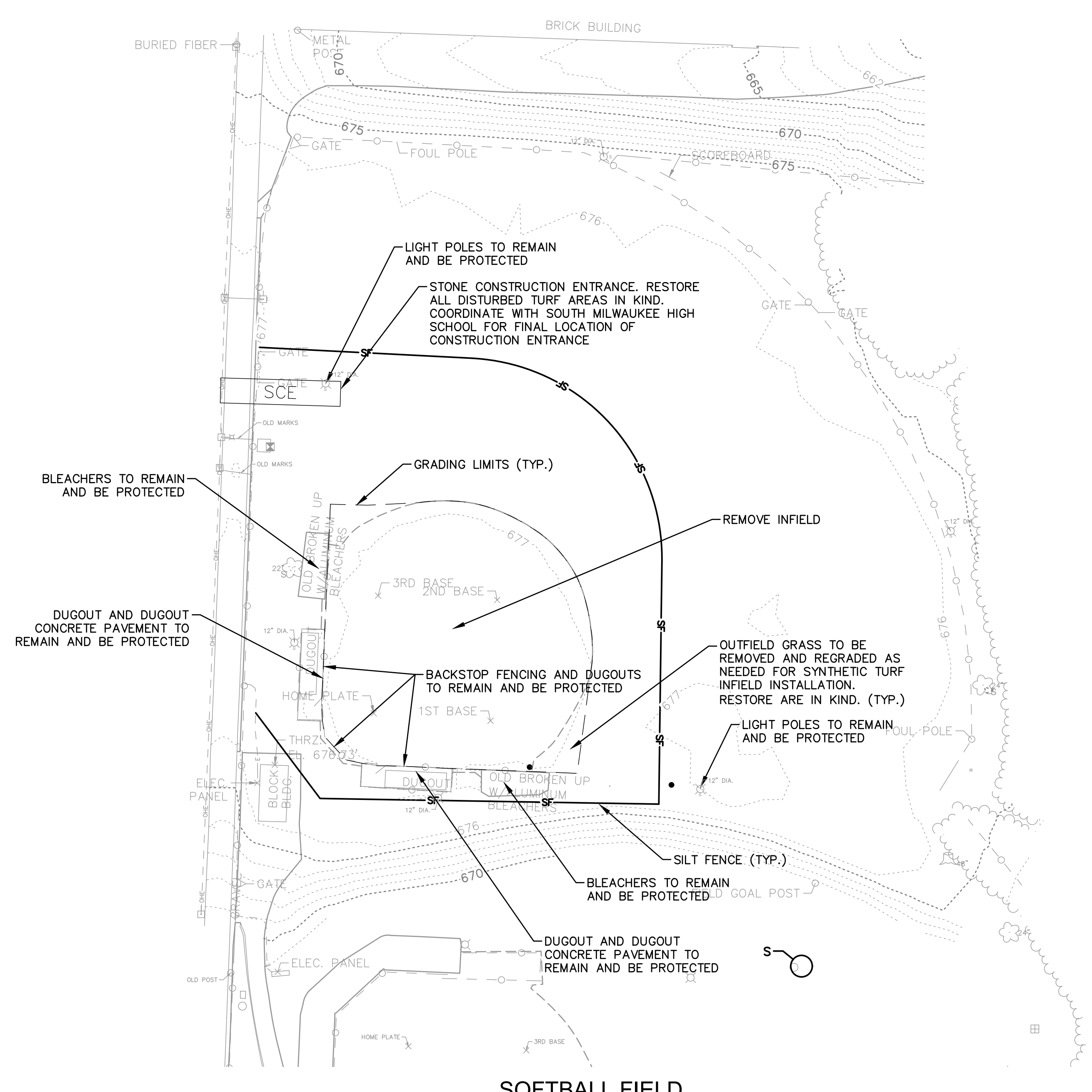

**SOFTBALL FIELD**

**NOTICE:**  
In accordance with Wisconsin statute 182.0175, damage to transmission facilities, excavator shall be solely responsible to provide advance notice to the designated "ONE CALL SYSTEM" not less than three working days prior to commencement of any excavation required to perform work contained on this drawing, and further, excavator shall comply with all other requirements of this statute relative to excavator's work.

**DISCLAIMER:**  
The underground utilities shown have been located from field survey information and existing drawings. GRAEF makes no guarantee that the underground utilities shown comprise all such utilities in the area, either in service or abandoned. GRAEF further does not warrant that the underground utilities shown are in the exact location indicated. GRAEF has not physically located the underground utilities.

**PROJECT TITLE:**  
SOUTH MILWAUKEE HIGH SCHOOL  
ATHLETIC FIELD IMPROVEMENTS

801 15TH AVENUE  
SOUTH MILWAUKEE, WI 53172

NO.	DATE	REVISIONS	BY

CONSTRUCTION DOCUMENTS

**PROJECT INFORMATION:**

PROJECT NUMBER: 2021-0492  
DATE: 10-14-2022  
DRAWN BY: MDS  
CHECKED BY: BRL  
APPROVED BY: JFP  
SCALE: AS SHOWN

**SHEET TITLE:**  
DEMOLITION & EROSION CONTROL  
PLAN

**SHEET NUMBER:**

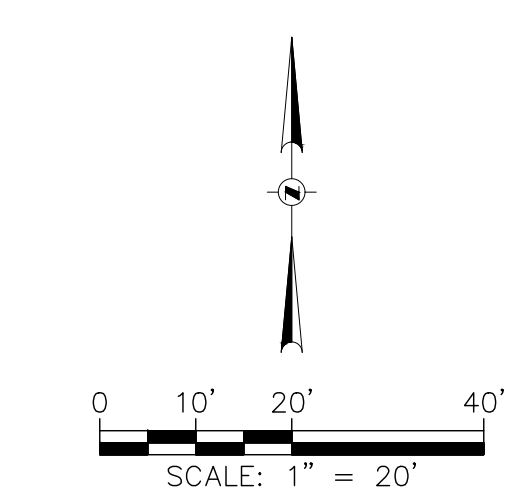
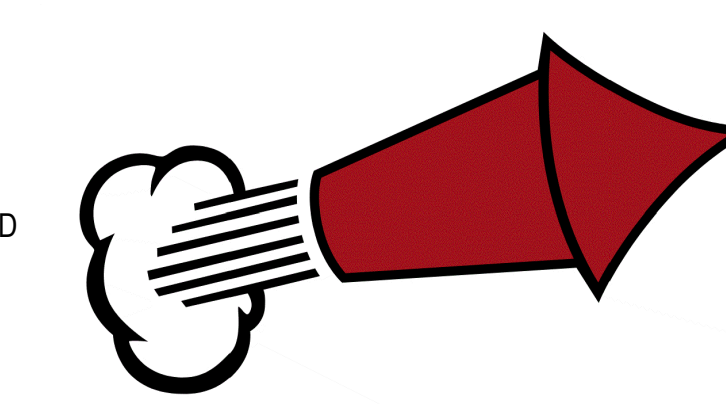

### LEGEND

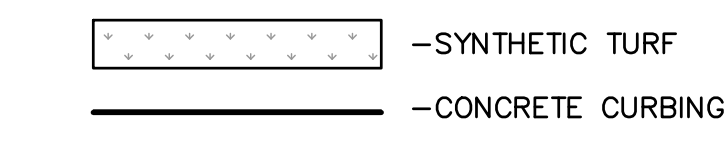

### GENERAL NOTES

1. THE BASE SURVEY WAS PREPARED BY GRAEF IN 2022. ALL UNDERGROUND UTILITIES AND STRUCTURES HAVE BEEN SHOWN TO A REASONABLE DEGREE OF ACCURACY AND IT SHALL BE THE CONTRACTOR'S RESPONSIBILITY TO VERIFY THEIR EXACT LOCATION AND TO AVOID DAMAGE THERETO.
2. REFER TO SHEET C100 FOR BENCHMARKS, DATUM, AND TOPOGRAPHIC ELEMENTS.
3. CONTRACTOR SHALL VERIFY LOCATION OF WORK AND REPORT ANY DISCREPANCIES TO THE ENGINEER PRIOR TO COMMENCING WORK.

### LAYOUT NOTES

1. THE BUILDING OUTLINES SHOWN ARE FOR REFERENCE PURPOSES ONLY AND SHALL NOT BE USED FOR STAKING PURPOSES. THE CONTRACTOR SHALL COORDINATE WITH THE ARCHITECT AND STRUCTURAL ENGINEER ON THE STAKING OF THE BUILDING.
2. ALL DIMENSIONS SHOWN ARE TO THE EDGE OF PAVEMENT OR FACE OF CURB WHERE CONCRETE CURB IS SHOWN.
3. ALL DISTURBED LANDSCAPED AREAS SHALL BE SEEDED AS SPECIFIED.
4. CONTRACTOR SHALL SUBMIT A CONCRETE JOINTING PLAN TO THE ENGINEER FOR REVIEW AND APPROVAL PRIOR TO COMMENCING CONSTRUCTION. JOINTING PLAN SHALL INDICATE: POUR SEQUENCE, LOCATION OF CONSTRUCTION, ISOLATION, CONTRACTION JOINTS, AND TYPE OF REINFORCEMENT.
5. UTILITY STRUCTURES LOCATED UNDERNEATH THE SYNTHETIC TURF FIELD SHALL BE RECESSED SUCH THAT THE FRAME AND GRATE RIM ELEVATION IS FLUSH WITH THE STONE SUBGRADE. SYNTHETIC TURF SHALL BE INSTALLED OVER THE TOP OF THE FRAME AND GRATE IN A MANNER THAT ALLOWS ACCESS TO THE STRUCTURES AND IN A MANNER APPROVED BY THE SYNTHETIC TURF MANUFACTURER. THE LOCATION OF THESE STRUCTURES SHALL BE MARKED WITH A 2" DIA. BLACK CIRCLE ON THE SYNTHETIC TURF.

PROJECT TITLE:  
SOUTH MILWAUKEE HIGH SCHOOL  
ATHLETIC FIELD IMPROVEMENTS

801 15TH AVENUE  
SOUTH MILWAUKEE, WI 53172

NO.		DATE		REVISIONS		ISSUE:	
						BY	

CONSTRUCTION DOCUMENTS

### PROJECT INFORMATION:

PROJECT NUMBER: 2021-0492  
DATE: 10-14-2022  
DRAWN BY: MDS  
CHECKED BY: BRL  
APPROVED BY: JFP  
SCALE: AS SHOWN

### SHEET TITLE:

SITE LAYOUT PLAN - BASEBALL  
FIELD

### SHEET NUMBER:

# C302

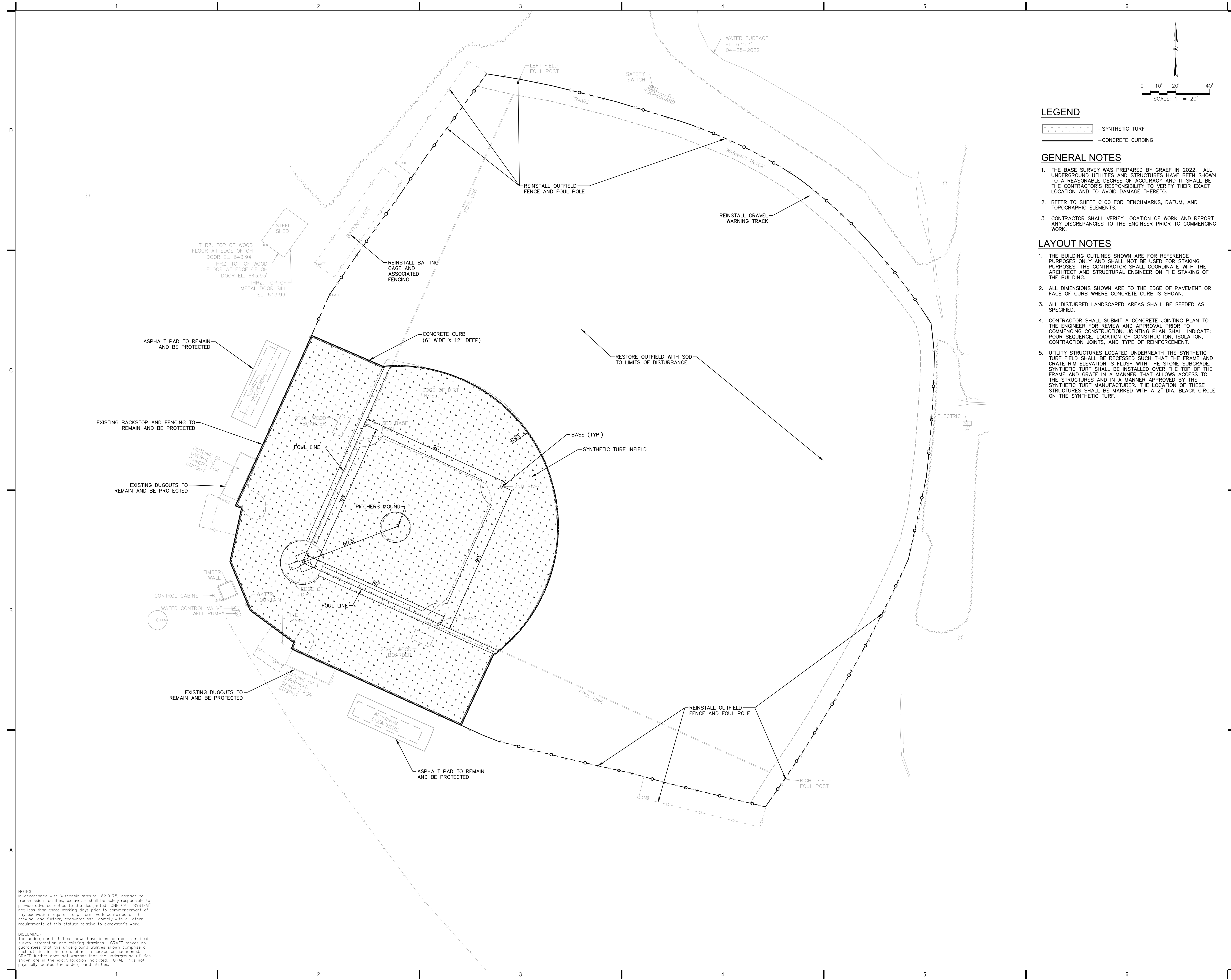

**NOTICE:**  
In accordance with Wisconsin statute 182.0175, damage to transmission facilities, excavator shall be solely responsible to provide advance notice to the designated "ONE CALL SYSTEM" not less than three working days prior to commencement of any excavation required to perform work contained on this drawing, and further, excavator shall comply with all other requirements of this statute relative to excavator's work.

**DISCLAIMER:**  
The underground utilities shown have been located from field survey information and existing drawings. GRAEF makes no guarantee that the underground utilities shown comprise all such utilities in the area, either in service or abandoned. GRAEF further does not warrant that the underground utilities shown are in the exact location indicated. GRAEF has not physically located the underground utilities.

X:\MIL\2021\20210492\Design\Civil\00\_C\_0302\_Site Layout Plan\_492 9/27/2022 2:42 PM

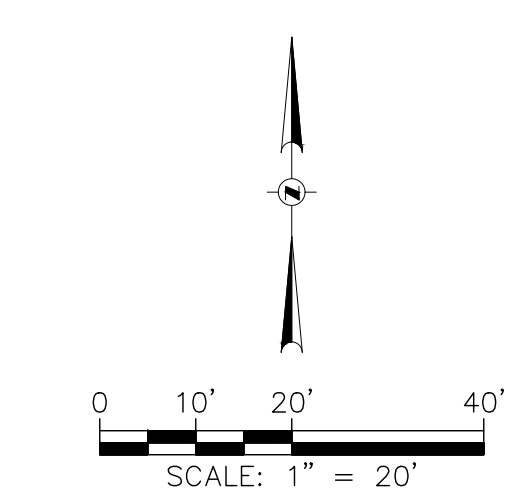
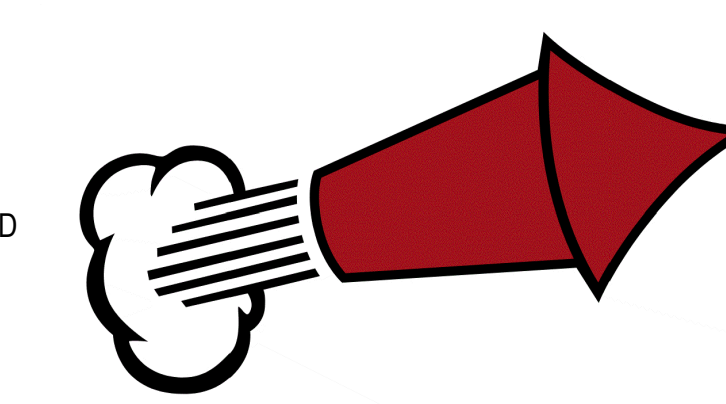

### LEGEND

- EXISTING CONTOUR
- PROPOSED CONTOUR
- CATCH BASIN
- PROPOSED STORM SEWER
- PROPOSED UNDERDRAIN

### GENERAL NOTES

1. THE BASE SURVEY WAS PREPARED BY GRAEF IN 2022. ALL UNDERGROUND UTILITIES AND STRUCTURES HAVE BEEN SHOWN TO A REASONABLE DEGREE OF ACCURACY AND IT SHALL BE THE CONTRACTOR'S RESPONSIBILITY TO VERIFY THEIR EXACT LOCATION AND TO AVOID DAMAGE THERETO.
2. REFER TO SHEET C100 FOR BENCHMARKS, DATUM, AND TOPOGRAPHIC ELEMENTS.
3. CONTRACTOR SHALL VERIFY LOCATION OF WORK AND REPORT ANY DISCREPANCIES TO THE ENGINEER PRIOR TO COMMENCING WORK.

### GRADING NOTES

1. ADA REGULATIONS REQUIRE A MAXIMUM SLOPE OF 1:20 (5%) ALONG THE LENGTH OF THE ACCESSIBLE ROUTE AND A MAXIMUM SLOPE OF 1:50 (2%) ACROSS THE WIDTH OF THE ACCESSIBLE ROUTE. ADA REGULATIONS REQUIRE A MAXIMUM SLOPE OF 1:50 (2%) IN ALL DIRECTIONS WITHIN AN ADA PARKING STALL AND ADJACENT UNLOADING ZONE.
2. UTILITY STRUCTURES LOCATED UNDERNEATH THE SYNTHETIC TURF FIELD SHALL BE RECESSED SUCH THAT THE FRAME AND GRATE RIM ELEVATION IS FLUSH WITH THE STONE SUBGRADE. SYNTHETIC TURF SHALL BE INSTALLED OVER THE TOP OF THE FRAME AND GRATE IN A MANNER THAT ALLOWS ACCESS TO THE STRUCTURES AND IN A MANNER APPROVED BY THE SYNTHETIC TURF MANUFACTURER. THE LOCATION OF THESE STRUCTURES SHALL BE MARKED WITH A 2" DIA. BLACK CIRCLE ON THE SYNTHETIC TURF.

### UTILITY NOTES

1. CONTRACTOR SHALL VERIFY ELEVATION OF EXISTING INVERTS PRIOR TO INSTALLATION OF PROPOSED UTILITIES.
2. BUILDING LATERALS SHALL BE CONSTRUCTED IN ACCORDANCE WITH LOCAL AND STATE PLUMBING CODES. SITE UTILITY CONTRACTOR SHALL STUB LATERAL TO 5 FEET OUTSIDE BUILDING. SEE INTERIOR PLUMBING PLANS FOR CONTINUATION OF PIPING INTO BUILDING BY BUILDING PLUMBING CONTRACTOR IN ACCORDANCE WITH STANDARD SPECIFICATIONS FOR SEWER AND WATER CONSTRUCTION IN WISCONSIN, LATEST EDITION.
3. CONTRACTOR SHALL CENTER ONE FULL LENGTH OF WATER PIPE ON SEWER AT WATER MAIN CROSSINGS, THAT BOTH JOINTS WILL BE AS FAR FROM SEWER AS POSSIBLE.
4. GENERAL CONTRACTOR SHALL COORDINATE WITH LOCAL GAS, TELEPHONE, AND ELECTRICAL UTILITIES FOR EXACT LOCATION, SIZE AND DEPTH OF NEW SERVICE.
5. CONTRACTOR SHALL PROVIDE DRAIN TILE AT ALL PROPOSED CATCH BASINS.
6. RIM ELEVATIONS IN CURB AND GUTTER ARE FLANGE GRADES.
7. PIPE LENGTHS AND INVERTS ARE TO CENTER OF STRUCTURES.
8. CRUSHED STONE BACKFILL SHALL BE USED UNDER AND WITHIN 5' OF ALL PAVED AREAS.

### PROJECT TITLE:

SOUTH MILWAUKEE HIGH SCHOOL  
ATHLETIC FIELD IMPROVEMENTS

801 15TH AVENUE  
SOUTH MILWAUKEE, WI 53172

### ISSUE:

NO.	DATE	REVISIONS	BY

CONSTRUCTION DOCUMENTS

### PROJECT INFORMATION:

PROJECT NUMBER: 2021-0492  
DATE: 10-14-2022  
DRAWN BY: MDS  
CHECKED BY: BRL  
APPROVED BY: JFP  
SCALE: AS SHOWN

### SHEET TITLE:

SITE GRADING & UTILITY PLAN -  
BASEBALL FIELD

### SHEET NUMBER:

# C402

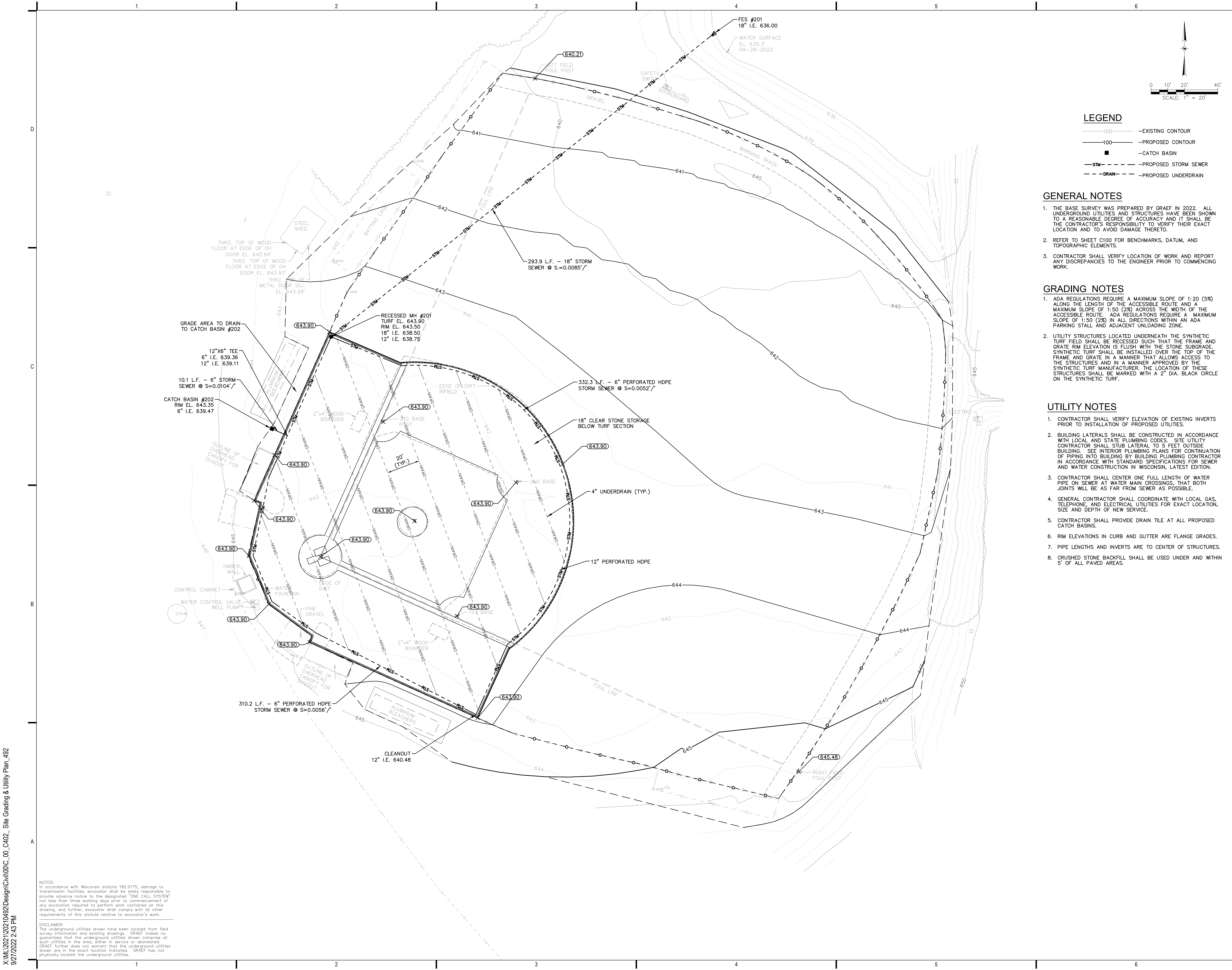

X:\MIL\2021\20210492\Design\Civil\00\_C\_402\_Site Grading & Utility Plan\_492 9/27/2022 2:43 PM

**NOTICE:**  
In accordance with Wisconsin statute 182.0175, damage to transmission facilities, excavator shall be solely responsible to provide advance notice to the designated "ONE CALL SYSTEM" not less than three working days prior to commencement of any excavation required to perform work contained on this drawing, and further, excavator shall comply with all other requirements of this statute relative to excavator's work.

**DISCLAIMER:**  
The underground utilities shown have been located from field survey information and existing drawings. GRAEF makes no guarantee that the underground utilities shown comprise all such utilities in the area, either in service or abandoned. GRAEF further does not warrant that the underground utilities shown are in the exact location indicated. GRAEF has not physically located the underground utilities.

**SPECIFICATIONS**

**INFORMATION FROM 02 41 14 – UTILITY ABANDONMENT AND REMOVAL**

WORK SHALL COMPLY WITH:

STANDARD SPECIFICATIONS FOR SEWER AND WATER CONSTRUCTION IN WISCONSIN, SIXTH EDITION, DECEMBER 22, 2003, WITH ADDENDUM NO. 2, APRIL 22, 2008, (SSSW).

STATE OF WISCONSIN DEPARTMENT OF TRANSPORTATION: STANDARD SPECIFICATIONS FOR HIGHWAY AND STRUCTURE CONSTRUCTION, CURRENT EDITION. (WISDOT)

**REGULATORY REQUIREMENTS**

CONFORM TO FOLLOWING CODES AS APPLICABLE TO ABANDONMENT AND REMOVAL WORK OF THIS PROJECT:  
STATE OF WISCONSIN ADMINISTRATIVE CODE, DEPARTMENT OF SAFETY AND PROFESSIONAL SERVICES, CHAPTER SPS 381 – DEFINITIONS AND STANDARDS, CHAPTER SPS 382 – DESIGN, CONSTRUCTION, INSTALLATION, SUPERVISION, AND INSPECTION OF PLUMBING, AND CHAPTER SPS 384 – PLUMBING PRODUCTS, AND LOCAL CODE IF MORE STRINGENT FOR MATERIALS AND INSTALLATION OF THE WORK OF THIS SECTION.

**INFORMATION FROM 02 41 15 – UTILITY REMOVAL**

WORK SHALL COMPLY WITH:

STANDARD SPECIFICATIONS FOR SEWER AND WATER CONSTRUCTION IN WISCONSIN, SIXTH EDITION, DECEMBER 22, 2003, WITH ADDENDUM NO. 2, APRIL 22, 2008 (SSSW).

STATE OF WISCONSIN DEPARTMENT OF TRANSPORTATION: STANDARD SPECIFICATIONS FOR HIGHWAY AND STRUCTURE CONSTRUCTION, CURRENT EDITION. (WISDOT)

CITY OF HARTFORD: ORDINANCE FOR CONSTRUCTION SITE EROSION CONTROL.

**REGULATORY REQUIREMENTS**

CONFORM TO FOLLOWING CODES AS APPLICABLE TO REMOVAL WORK OF THIS PROJECT:

STANDARD SPECIFICATIONS FOR SEWER AND WATER CONSTRUCTION IN WISCONSIN, STATE OF WISCONSIN ADMINISTRATIVE CODE, DEPARTMENT OF SAFETY AND PROFESSIONAL SERVICES, CHAPTER SPS 381 – DEFINITIONS AND STANDARDS, CHAPTER SPS 382 – DESIGN, CONSTRUCTION, INSTALLATION, SUPERVISION, AND INSPECTION OF PLUMBING, AND CHAPTER SPS 384 – PLUMBING PRODUCTS, AND LOCAL CODE IF MORE STRINGENT FOR MATERIALS AND INSTALLATION OF THE WORK OF THIS SECTION.

**INFORMATION FROM 31 23 23 – FILL**

**SUBSOIL MATERIALS**

**SUBSOIL TYPE S1:**  
EXCAVATED AND RE-USED MATERIAL.  
GRADED.  
FREE OF LUMPS LARGER THAN THREE (3) INCHES, ROCKS LARGER THAN TWO (2) INCHES, AND DEBRIS.  
CONTRACTOR SHALL PROVIDE 40 LB SAMPLE OF EXISTING SITE MATERIAL TO LABORATORY FOR SOIL CLASSIFICATION ANALYSIS CONFORMING TO ASTM D2487.

**SUBSOIL TYPE S2:**  
IMPORTED BORROW.  
GRADED.  
FREE OF LUMPS LARGER THAN THREE (3) INCHES, ROCKS LARGER THAN TWO (2) INCHES, AND DEBRIS.  
IMPORTED SUBSOIL AND BORROW SHALL BE SIMILAR IN COMPOSITION WHEN COMPARED TO EXISTING SITE SUBSOIL.  
CONTRACTOR SHALL PROVIDE 40 LB SAMPLE OF PROPOSED IMPORTED BORROW MATERIAL TO LABORATORY FOR SOIL CLASSIFICATION ANALYSIS CONFORMING TO ASTM D2487.

**AGGREGATES MATERIALS**

STRUCTURAL FILL, COURSE AGGREGATE (GRAVEL): CRUSHED GRAVEL: FREE OF ORGANIC MATTER AND DEBRIS; GRADED IN ACCORDANCE WITH: WISDOT 3/4-INCH GRADATION OR WISDOT 1-1/4-INCH GRADATION.

RECYCLED CONCRETE STRUCTURAL FILL: CRUSHED CONCRETE; FREE OF FROM WOOD, STEEL, ROOTS, BARK OR OTHER EXTRANEIOUS MATERIAL; GRADED IN ACCORDANCE WITH: MATCH REQUIREMENTS FOR STRUCTURAL FILL.

RECYCLED CONCRETE STRUCTURAL FILL: CRUSHED ASPHALTIC CONCRETE; FREE OF FROM WOOD, STEEL, ROOTS, BARK OR OTHER EXTRANEIOUS MATERIAL; GRADED IN ACCORDANCE WITH: MATCH REQUIREMENTS FOR STRUCTURAL FILL.

STONE: CRUSHED STONE; FREE OF CLAY, SHALE, ORGANIC MATTER; GRADED IN ACCORDANCE WITH: WISDOT OPEN-GRADED GRADATION.

3/4-INCH STONE CHIPS: CRUSHED STONE; FREE OF CLAY, SHALE, ORGANIC MATTER; GRADED IN ACCORDANCE WITH THE FOLLOWING LIMITS:

SIZE	PERCENT PASSING
1-INCH	100
3/4-INCH	90 – 100
3/8-INCH	20 – 55
NO. 4	0 – 10
NO. 8	0 – 5

3/8-INCH STONE CHIPS: CRUSHED STONE; FREE OF CLAY, SHALE, ORGANIC MATTER; GRADED IN ACCORDANCE WITH THE FOLLOWING LIMITS:

SIZE	PERCENT PASSING
1/2-INCH	100
3/8-INCH	85 – 100
NO. 4	10 – 30
NO. 8	0 – 10
NO. 16	0 – 5

PEA GRAVEL: FRACTURED, WASHED, FREE OF CLAY, SHALE, ORGANIC MATTER; GRADED IN ACCORDANCE WITH THE FOLLOWING LIMITS:  
MINIMUM SIZE: 1/4-INCH.  
MAXIMUM SIZE: 3/8-INCH.

GRANULAR FILL:  
WISDOT GRANULAR BACKFILL, GRADE 1.

BEDDING SAND / FINE AGGREGATE: UNWASHED BANK-RUN SAND OR REJECTED CONCRETE SAND; APPROXIMATELY SIX (6) PERCENT FINE CLAY OR LOAM PARTICLES BUT FREE OF SILT AND CLAY OR LOAM LUMPS CONSISTING OF DURABLE PARTICLES RANGING IN SIZE FROM FINE TO COARSE IN UNIFORM COMBINATIONS; MAXIMUM MOISTURE CONTENT SHALL BE 10 PERCENT, GRADED WITHIN FOLLOWING LIMITS:

SIZE	PERCENT PASSING
1-INCH	100
NO. 16	45 – 80
NO. 200	2 – 10

**INFORMATION FROM 31 10 00 – SITE CLEARING**

WORK SHALL COMPLY WITH:

STATE OF WISCONSIN DEPARTMENT OF TRANSPORTATION (WISDOT): STANDARD SPECIFICATIONS FOR HIGHWAY AND STRUCTURE CONSTRUCTION, CURRENT EDITION.  
[HTTP://ROADWAYSSTANDARDS.DOT.WI.GOV/STANDARDS/STNDSPEC/INDEX.HTM](http://roadwaysstandards.dot.wi.gov/standards/STNDSPEC/INDEX.HTM)

STATE OF WISCONSIN DEPARTMENT OF NATURAL RESOURCES (WDNR): CONSTRUCTION SITE EROSION & SEDIMENT CONTROL.  
[HTTP://DNR.WI.GOV/Topic/STORMWATER/](http://dnr.wi.gov/Topic/STORMWATER/)

U.S. ENVIRONMENTAL PROTECTION AGENCY (USEPA): DEVELOPING YOUR STORMWATER POLLUTION PREVENTION PLAN, A GUIDE FOR CONSTRUCTION SITES.  
[HTTP://CFPUB.EPA.GOV/NPDES/STORMWATER/SWPPP.CFM](http://cfpub.epa.gov/npdes/stormwater/swmpp.cfm)

**INFORMATION FROM 31 22 00 – GRADING**

WORK SHALL COMPLY WITH:

STATE OF WISCONSIN DEPARTMENT OF TRANSPORTATION (WISDOT): STANDARD SPECIFICATIONS FOR HIGHWAY AND STRUCTURE CONSTRUCTION, CURRENT EDITION.  
STATE OF WISCONSIN DOT STANDARD SPECIFICATIONS

**MATERIALS**

TOPSOIL AS SPECIFIED IN SECTION 31 23 23 – FILL.

SUBSOIL FILL AS SPECIFIED IN SECTION 31 23 23 – FILL.

AGGREGATE FILL AS SPECIFIED IN SECTION 31 23 23 – FILL.

**SCHEDULES**

AGGREGATE FILL:  
MAXIMUM SEVEN (7) –INCH LOOSE LIFTS.  
COMPACT EACH LIFT TO MINIMUM 95 PERCENT OF MODIFIED PROCTOR DENSITY.

SUBSOIL FILL:  
MAXIMUM 12-INCH LOOSE LIFTS.  
COMPACT EACH LIFT TO MINIMUM 95 PERCENT OF MODIFIED PROCTOR DENSITY.

TOPSOIL FILL:  
FILL TYPE: MAXIMUM 12-INCH LOOSE LIFTS.  
COMPACT EACH LIFT TO MINIMUM 85 PERCENT OF MODIFIED PROCTOR DENSITY.

**INFORMATION FROM 31 23 16.3 – TRENCHING**

**PIPE INSULATION**

EXTRUDED POLYSTYRENE BOARD TO ASTM C578, TYPE V, RIGID, CLOSED CELL TYPE, WITH INTEGRAL HIGH DENSITY SKIN.  
THERMAL RESISTANCE: TYPICAL 5 YEAR AGED VALUE OF R-5 PER 1 INCH OF THICKNESS PER ASTM C518.  
BOARD SIZE: 24 X 96 X 2-INCH THICK. SQUARE EDGES.  
COMPRESSIVE STRENGTH: MINIMUM 100 PSI PER ASTM D1621.  
WATER ABSORPTION: 0.7 PERCENT BY VOLUME MAXIMUM PER ASTM D2842.  
INSULATION SHALL BE:  
DOW CHEMICAL COMPANY STYROFOAM™ HIGLOAD 100; DOW CHEMICAL STYROFOAM HIGLOAD 100 INSULATION OR APPROVED EQUAL.

**BEDDING AND BACKFILL MATERIALS**  
A. WATER MAIN BEDDING: BEDDING SAND AS DEFINED UNDER SECTION 31 23 23 – FILL ON DRAWINGS  
B. SEWER BEDDING (18-INCHES IN DIAMETER AND LESS): 3/8" STONE CHIPS AS DEFINED UNDER SECTION 31 23 23 – FILL ON DRAWINGS  
C. SEWER BEDDING (GREATER THAN 18-INCHES IN DIAMETER): 3/4" STONE CHIPS AS DEFINED UNDER SECTION 31 23 23 – FILL ON DRAWINGS  
D. CRUSHED GRAVEL BACKFILL: STRUCTURAL FILL AS DEFINED UNDER SECTION 31 23 23 – FILL ON DRAWINGS  
E. SITE EXCAVATED MATERIAL (SPOIL) BACKFILL: TYPE S1 AS DEFINED UNDER SECTION 31 23 23 – FILL ON DRAWINGS.  
F. IMPORTED SUBSOIL MATERIAL BACKFILL: TYPE S2 AS DEFINED UNDER SECTION 31 23 23 – FILL ON DRAWINGS

**INFORMATION FROM 31 25 13 – EROSION AND SEDIMENT CONTROLS**

**REFERENCES**

STATE OF WISCONSIN DEPARTMENT OF NATURAL RESOURCES (WDNR): STORM WATER CONSTRUCTION TECHNICAL STANDARDS, MODELS AND BEST MANAGEMENT PRACTICES (BMP'S):  
[WDNR STORM WATER CONSTRUCTION TECHNICAL STANDARDS WEBSITE](http://dnr-storm-water-construction-technical-standards-website)

STORM WATER POST-CONSTRUCTION TECHNICAL STANDARDS:  
[WDNR STORM WATER POST-CONSTRUCTION TECHNICAL STANDARDS WEBSITE](http://dnr-storm-water-post-construction-technical-standards-website)

STATE OF WISCONSIN DEPARTMENT OF TRANSPORTATION (WISDOT): STANDARD SPECIFICATIONS FOR HIGHWAY AND STRUCTURE CONSTRUCTION, CURRENT EDITION.

EROSION CONTROL PRODUCT ACCEPTABILITY LISTS FOR MULTI-MODAL APPLICATIONS. (PAL)

**INFORMATION FROM 32 12 16 – ASPHALT PAVING**

**ASPHALT PAVING MIX**

RECYCLED ASPHALT PAVEMENT (RAP) MAY BE USED.  
CONTRACTOR MAY USE UP TO 25 PERCENT RAP FOR BASE, BINDER, AND INTERMEDIATE COURSE MIXTURES.

**ASPHALT MATERIALS**

TACK COAT: SS-1, IN ACCORDANCE WITH WISDOT SECTION 455.

**SOURCE QUALITY CONTROL AND TESTS**

PERFORM ASPHALTIC CONCRETE TESTING IN ACCORDANCE WITH WISDOT SECTION 460.

**INFORMATION FROM 32 13 13 – CONCRETE PAVING**

**REINFORCEMENT**

EPOXY-COATED JOINT DOWEL BARS: ASTM A775; WITH ASTM A615, GRADE 60, SMOOTH STEEL BARS. CUT BARS TRUE TO LENGTH WITH ENDS FLUSH AND FREE OF BURRS.

**CONCRETE MIX- BY PERFORMANCE CRITERIA**

PROVIDE CONCRETE TO THE FOLLOWING CRITERIA:  
COMPRESSIVE STRENGTH: 4,000 PSI AT 28 DAYS.  
SLUMP: 4 INCHES.  
AIR ENTRAINED: 6 ± 1 PERCENT.

**INFORMATION FROM 33 41 00 – SITE STORM SEWER SYSTEM**

WORK SHALL COMPLY WITH:

STATE OF WISCONSIN ADMINISTRATIVE CODE, DEPARTMENT OF SAFETY AND PROFESSIONAL SERVICES, CHAPTER SPS 381 – DEFINITIONS AND STANDARDS, CHAPTER SPS 382 – DESIGN, CONSTRUCTION, INSTALLATION, SUPERVISION, AND INSPECTION OF PLUMBING, AND CHAPTER SPS 384 – PLUMBING PRODUCTS.

**TRACER WIRE MATERIALS**

MARK ALL NON-CONDUCTIVE LATERAL PIPES WITH A LOCATING WIRE SYSTEM.

LOCATING WIRE SYSTEM CONSISTS OF THE FOLLOWING:  
TRACER WIRE: 45-MIL SOLID COPPER, NO. 12 HMW-PE YELLOW JACKET COATING. INSTALL TO ENABLE ELECTRONIC LOCATING OF UNDERGROUND UTILITY.

TRACER WIRE LOCATING BOX: 2-1/2-INCH DIAMETER, MINIMUM, ABS PIPE WITH 2 POINT TERMINAL BOX AND CAST IRON COVER.  
MANUFACTURER: VALCO, INC., MODEL C.P. MINI BOX, OR AN APPROVED EQUAL.



275 West Wisconsin Avenue  
Suite 300  
Milwaukee, WI 53203-3318  
414 / 259 1500

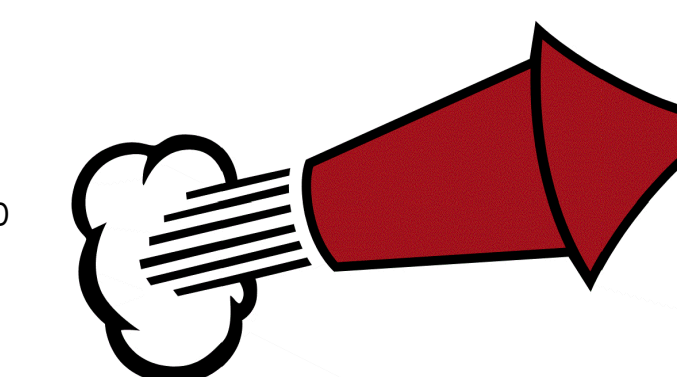

**PROJECT TITLE:**

SOUTH MILWAUKEE HIGH SCHOOL  
ATHLETIC FIELD IMPROVEMENTS

801 15TH AVENUE  
SOUTH MILWAUKEE, WI 53172

**ISSUE:**

NO. DATE REVISIONS BY

CONSTRUCTION DOCUMENTS

**PROJECT INFORMATION:**

PROJECT NUMBER: 2021-0492  
DATE: 10-14-2022  
DRAWN BY: MDS  
CHECKED BY: BRL  
APPROVED BY: JFP  
SCALE: AS SHOWN

**SHEET TITLE:**

CONSTRUCTION NOTES

**SHEET NUMBER:**

C900

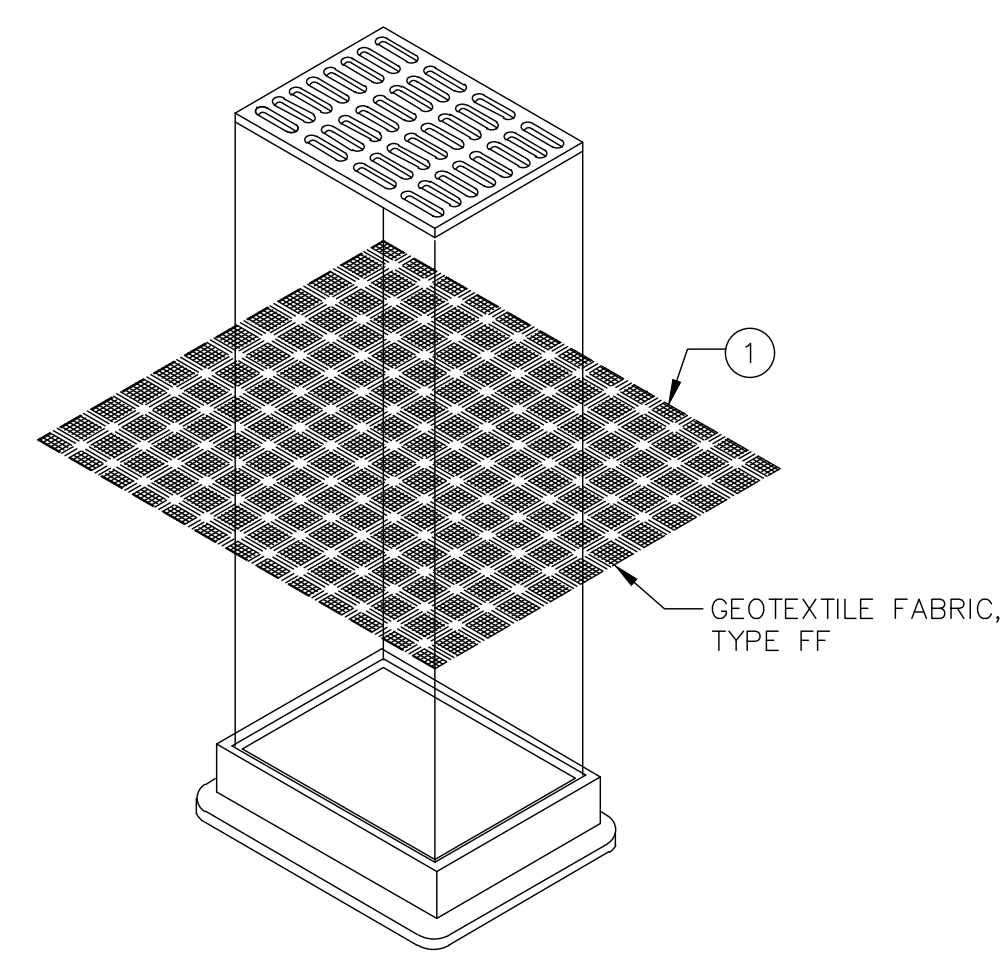

**03** INLET PROTECTION, TYPE B  
(WITHOUT CURB BOX)  
SCALE N.T.S.

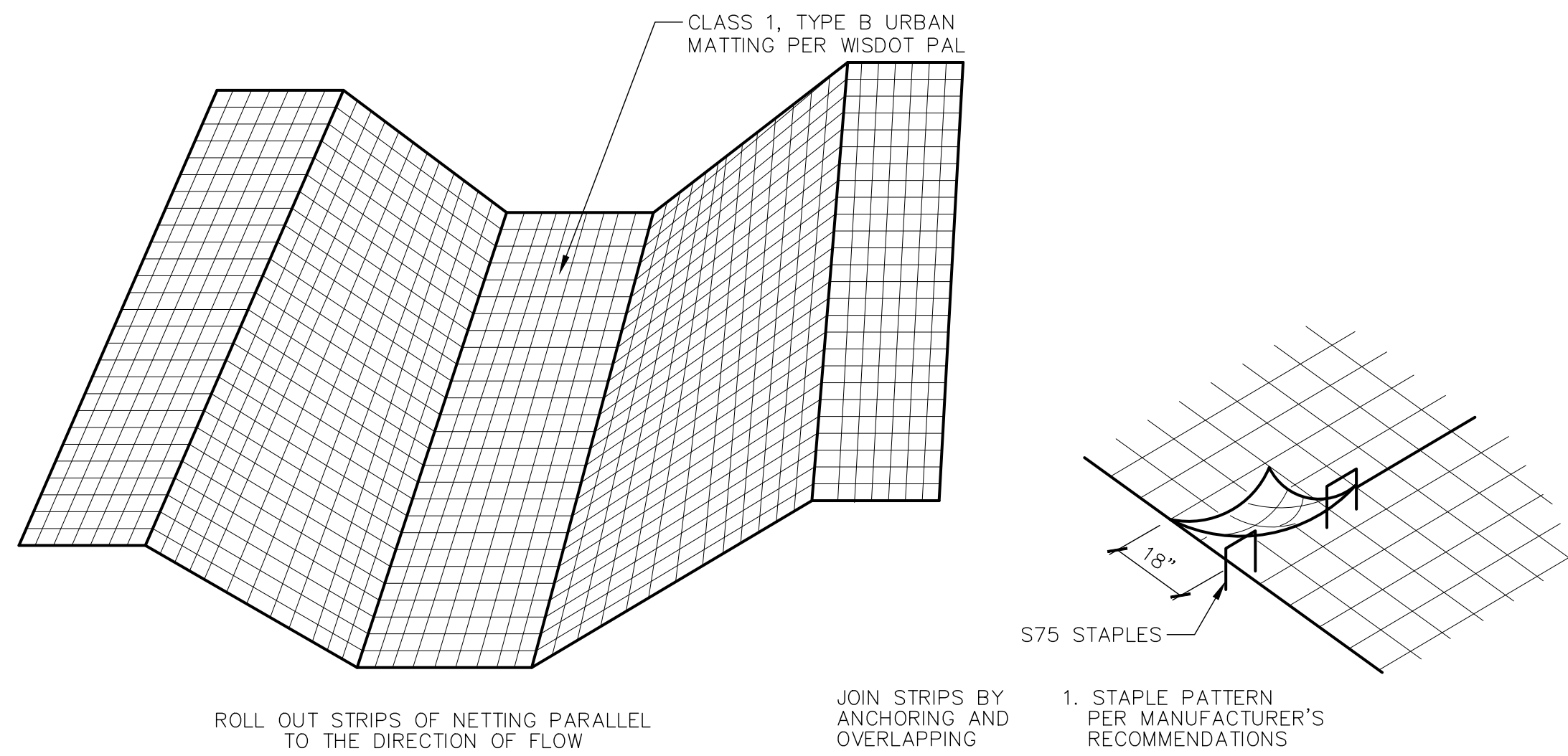

**06** EROSION MATTING  
SCALE N.T.S.

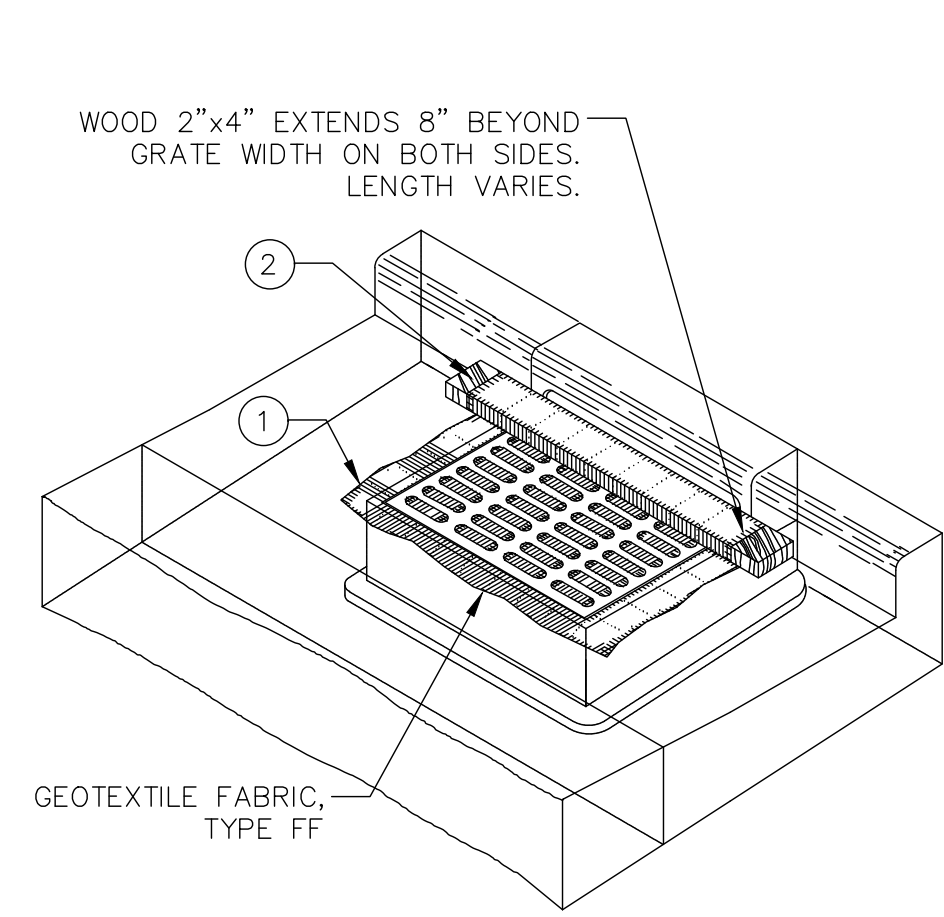

**04** INLET PROTECTION, TYPE C  
(WITH CURB BOX)  
SCALE N.T.S.

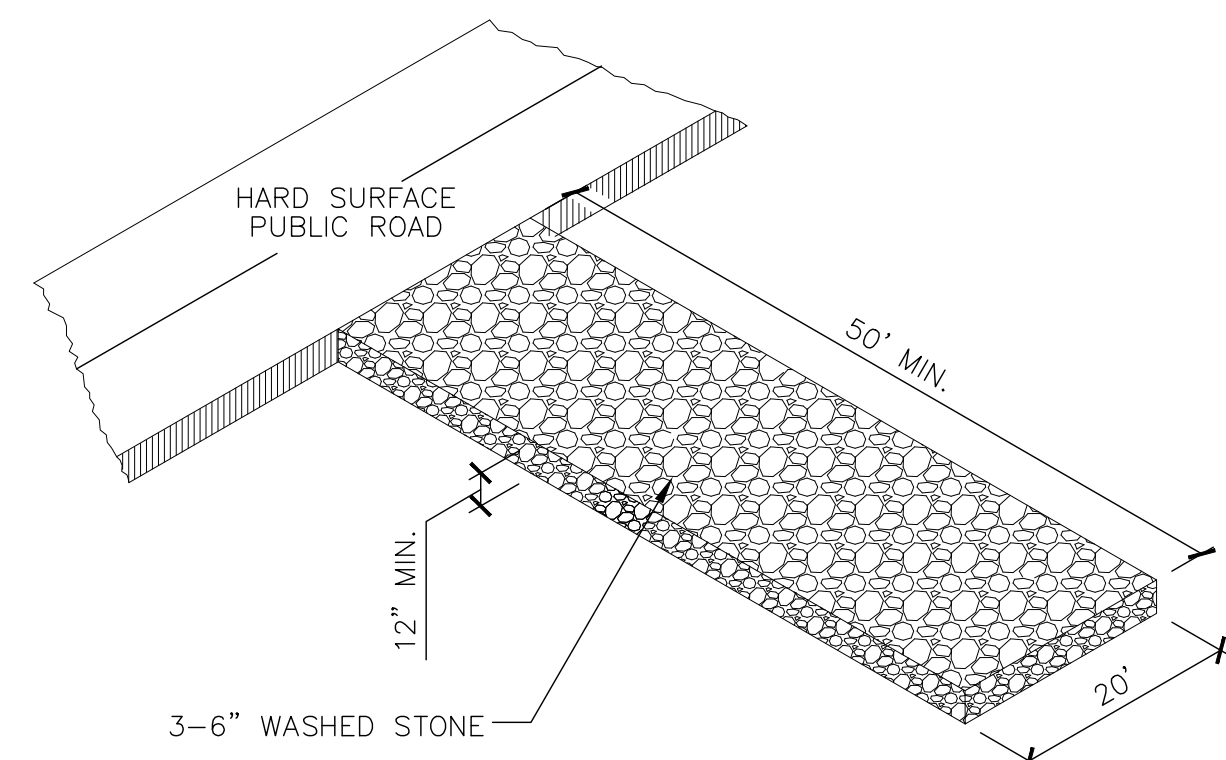

**07** STONE CONSTRUCTION ENTRANCE  
SCALE N.T.S.

- ④ SILT FENCE TO EXTEND ACROSS THE TOP OF THE PIPE.
- ⑤ CONSTRUCT SILT FENCE FROM A CONTINUOUS ROLL IF POSSIBLE BY CUTTING LENGTHS TO AVOID JOINTS. IF A JOINT IS NECESSARY USE ONE OF THE FOLLOWING TWO METHODS: A) OVERLAP THE END POSTS AND TWIST, OR ROTATE, AT LEAST 180 DEGREES, B) HOOK THE END OF EACH SILT FENCE LENGTH.

NOTE: ADDITIONAL POST DEPTH OR TIE BACKS MAY BE REQUIRED IN UNSTABLE SOILS

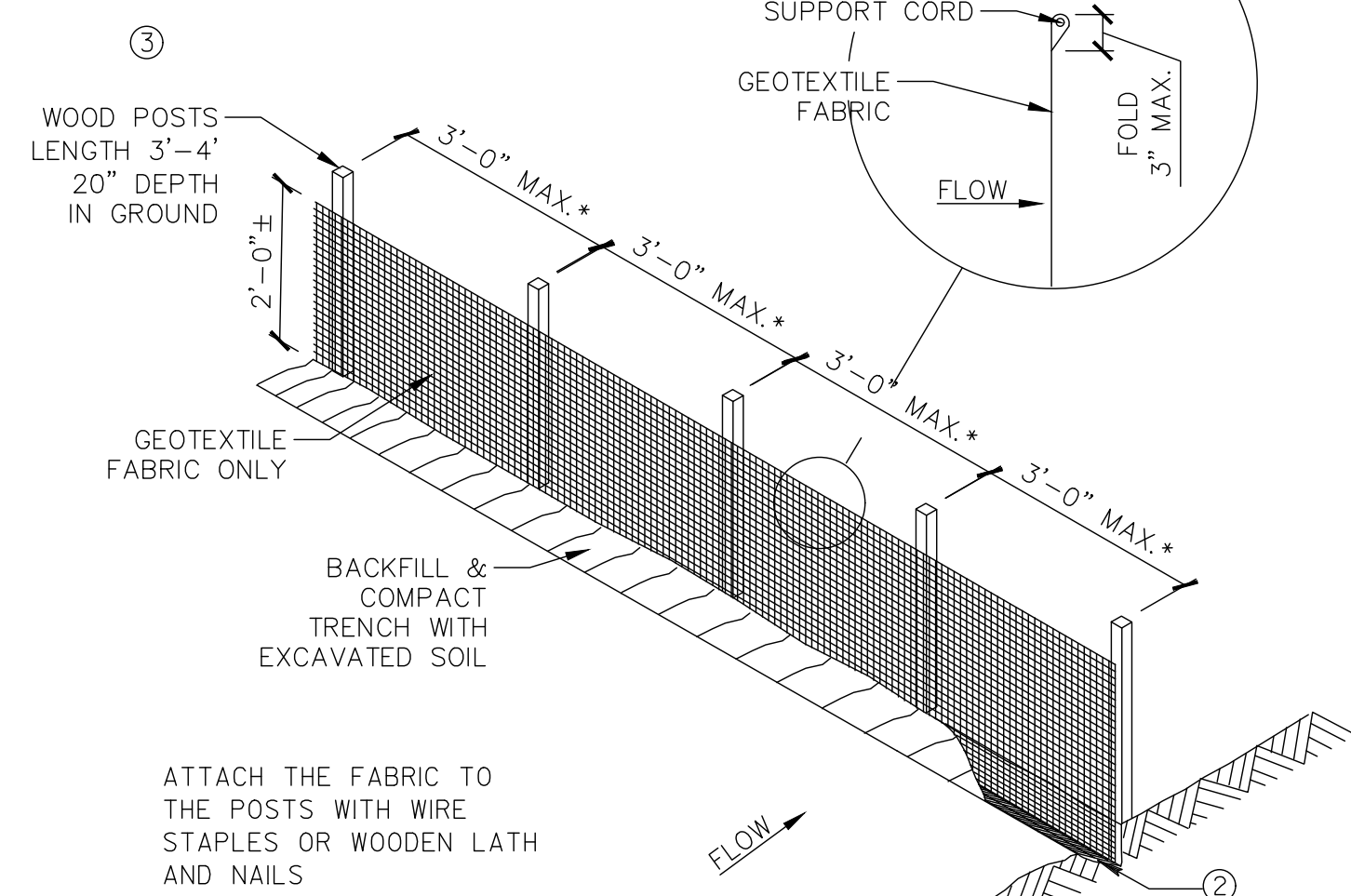

\*NOTE: 8'-0" POST SPACING ALLOWED IF A WOVEN GEOTEXTILE FABRIC IS USED.

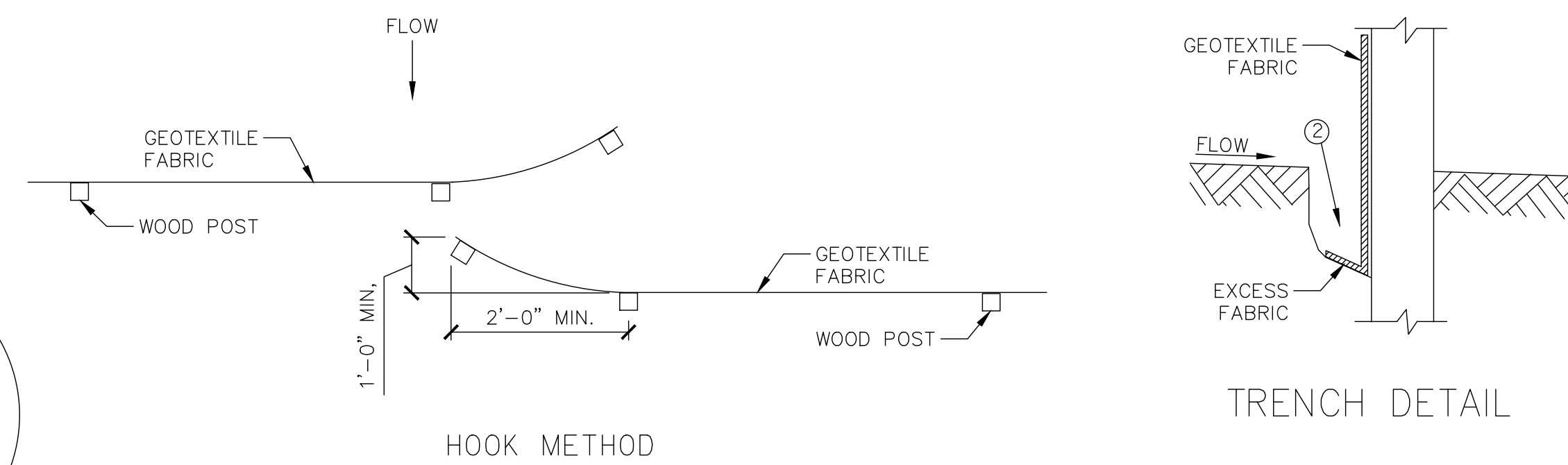

JOINING TWO LENGTHS OF SILT FENCE ⑤

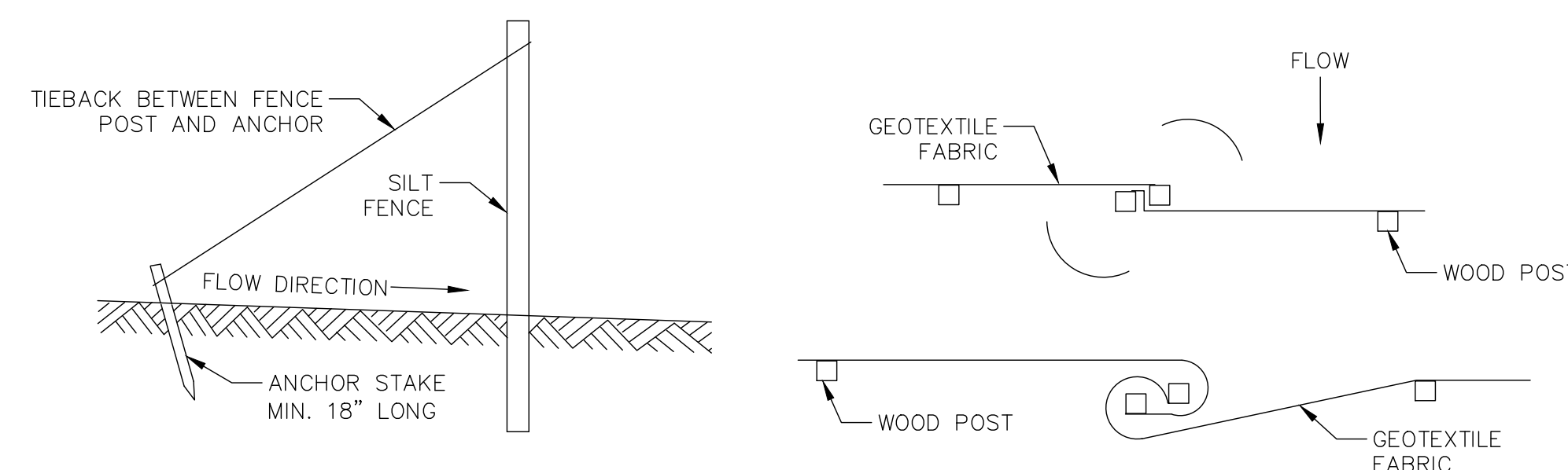

**1** SILT FENCE

**05** SILT FENCE  
SCALE N.T.S.



PROJECT TITLE:  
SOUTH MILWAUKEE HIGH SCHOOL  
ATHLETIC FIELD IMPROVEMENTS

801 15TH AVENUE  
SOUTH MILWAUKEE, WI 53172

NO.	DATE	REVISIONS	BY	ISSUE:

CONSTRUCTION DOCUMENTS

PROJECT INFORMATION:

PROJECT NUMBER: 2021-0492  
DATE: 10-14-2022  
DRAWN BY: MDS  
CHECKED BY: BRL  
APPROVED BY: JFP  
SCALE: AS SHOWN

SHEET TITLE:

CONSTRUCTION DETAILS

SHEET NUMBER:

**GENERAL NOTES**

1. ALL INLETS SHALL BE 48" CONCRETE STRUCTURES OR APPROVED ADS/NYLOPLAST STRUCTURES UNLESS OTHERWISE SPECIFIED ON PLANS
2. 10' LENGTHS OF 4" DRAIN TILE SHALL BE INCLUDED AT EACH STRUCTURE

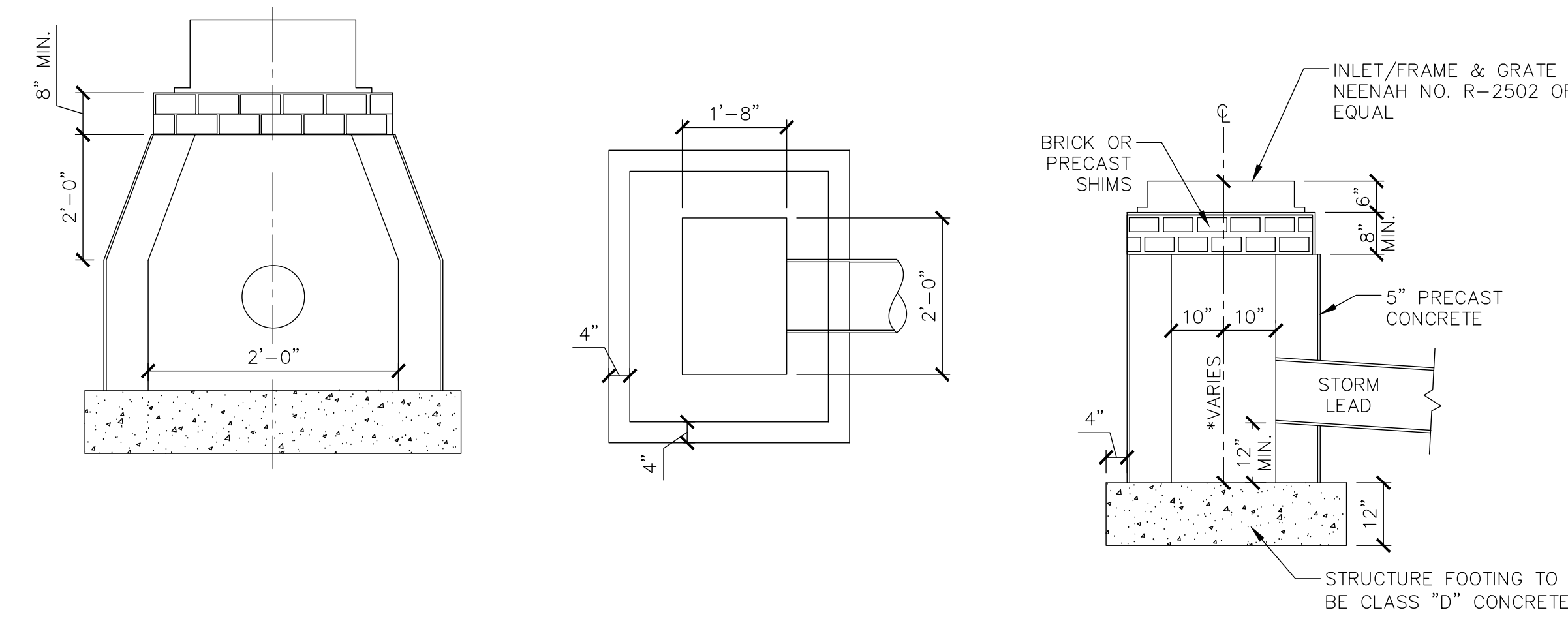

**02 CATCH BASIN**

SCALE

N.T.S.

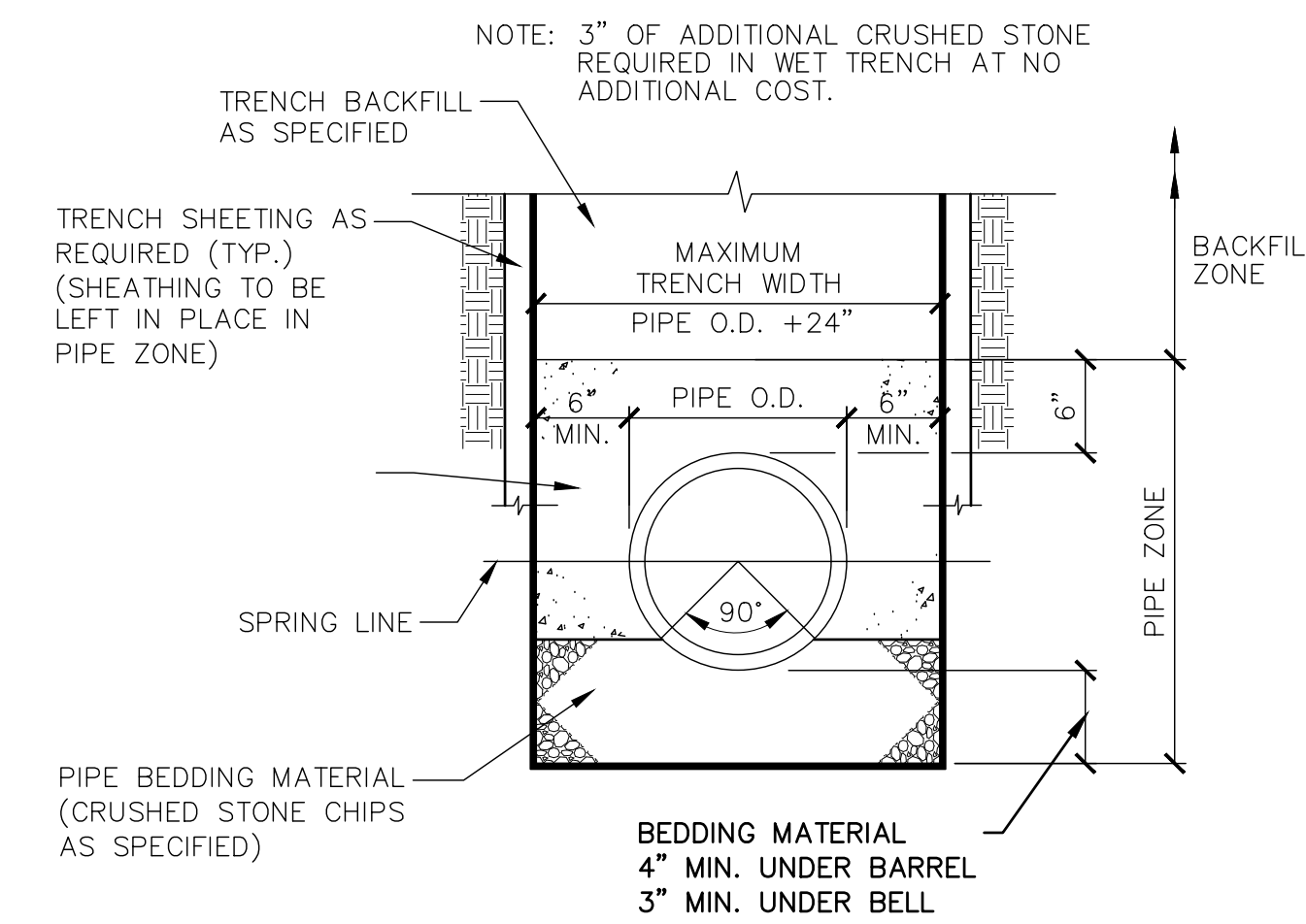

**04 CLASS "C" BEDDING DETAIL FOR RIGID SEWER**

SCALE

N.T.S.

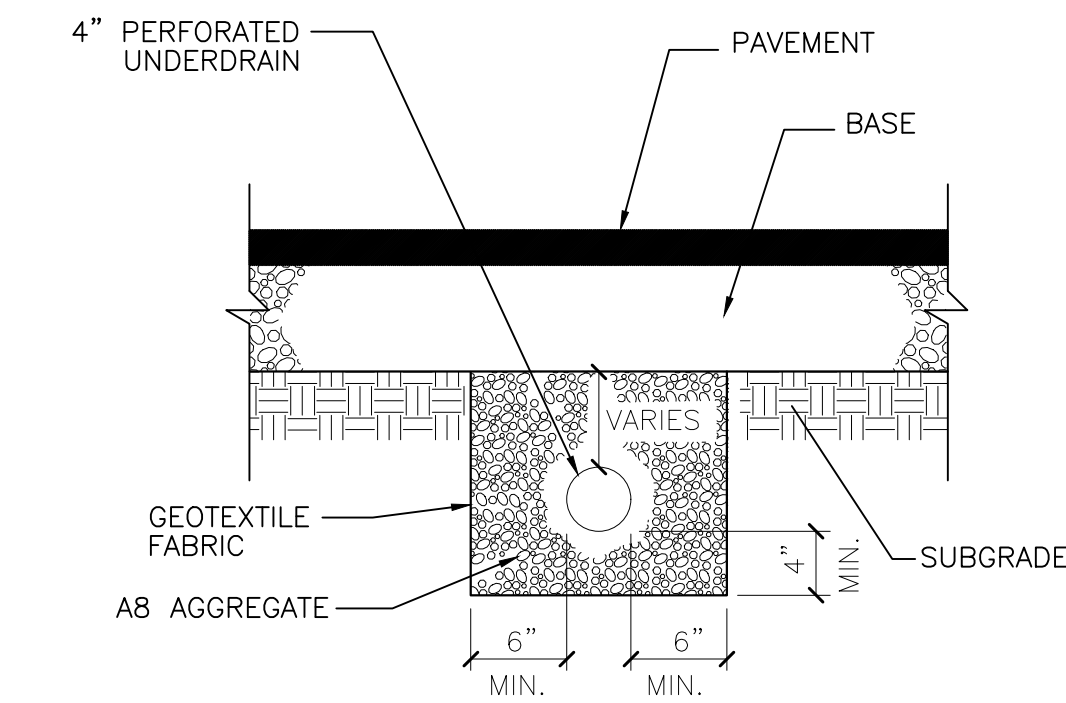

**05 UNDERDRAIN**

SCALE

N.T.S.

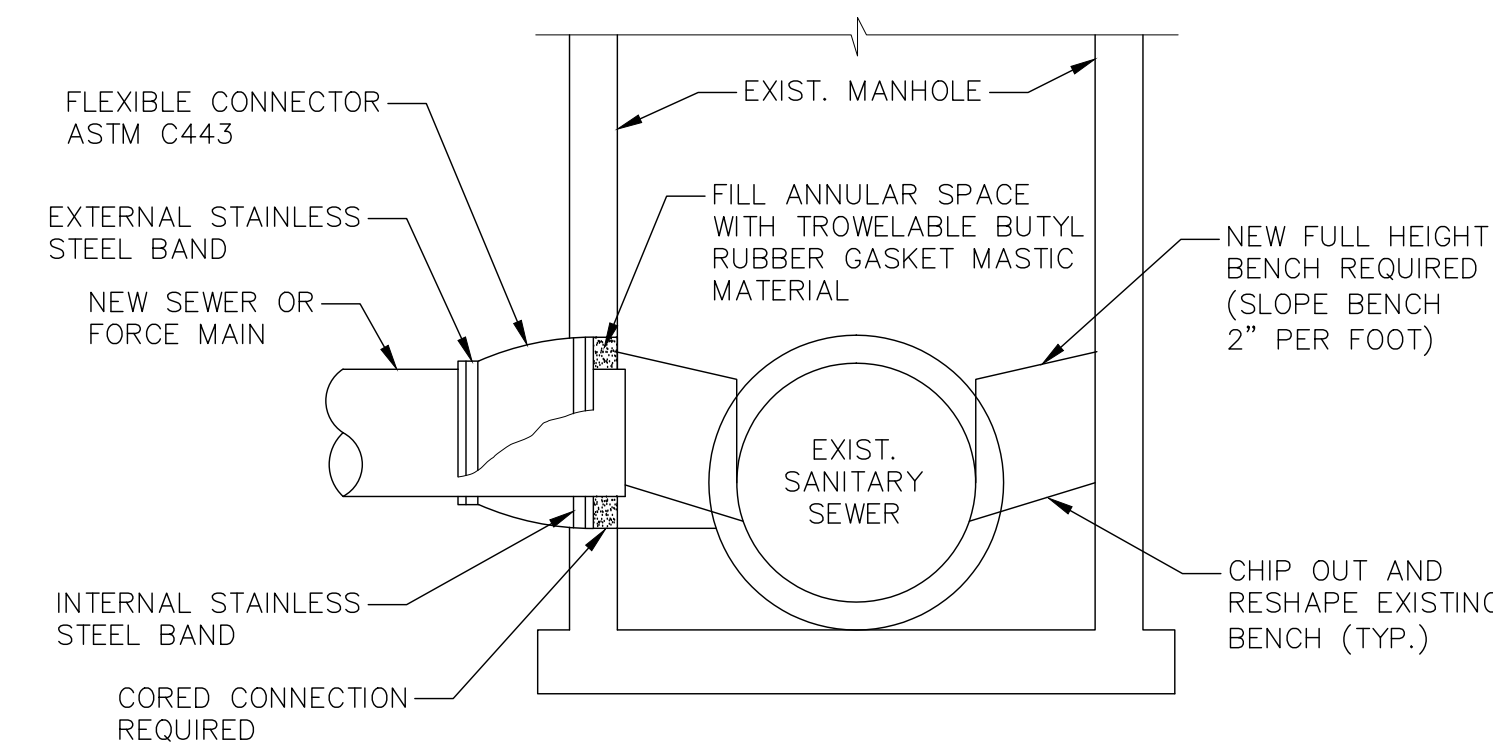

**06 NEW CONNECTION TO EXISTING MANHOLE**

SCALE

N.T.S.

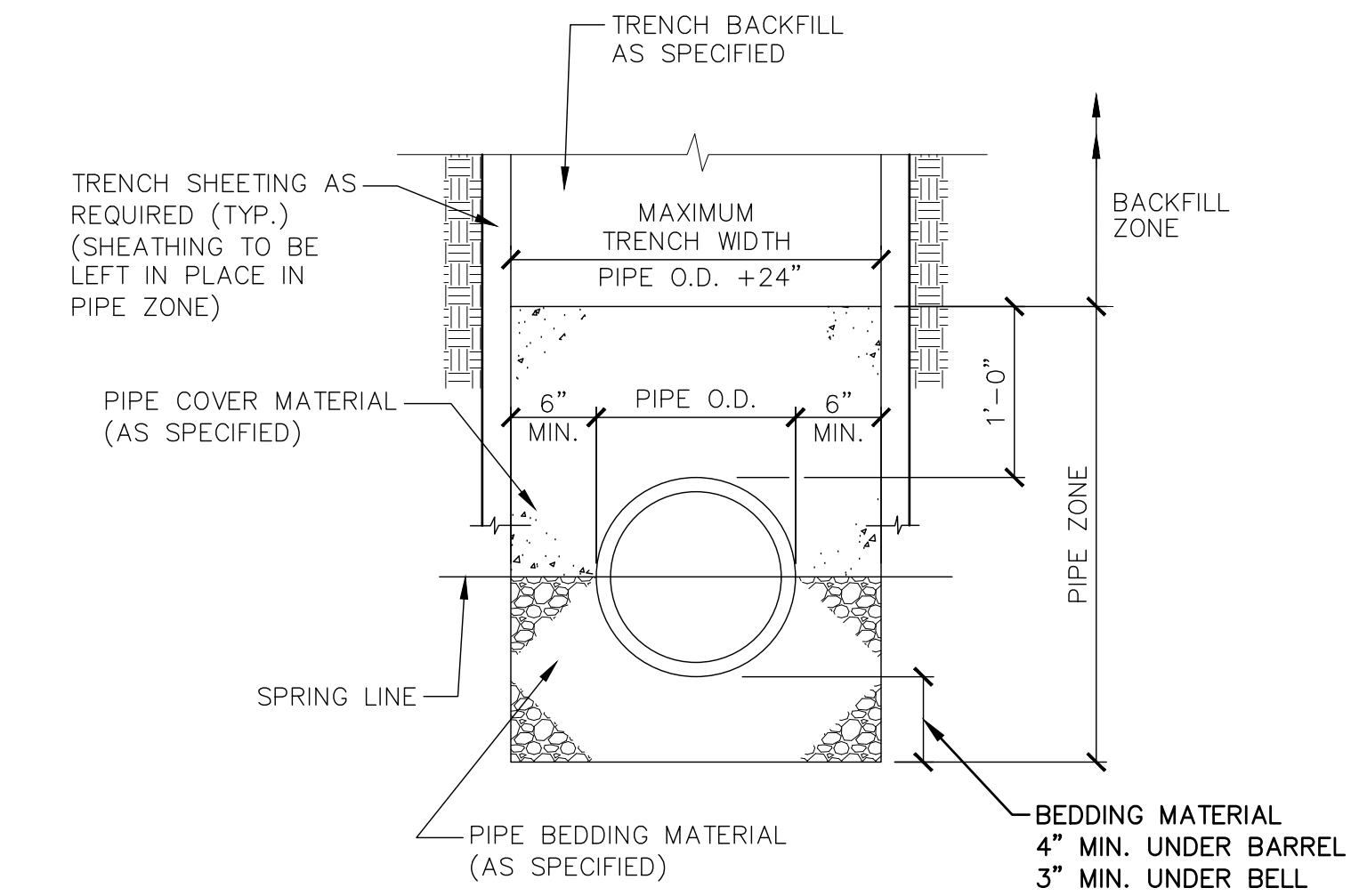

**03 CLASS "B" BEDDING DETAIL FOR FLEXIBLE SEWER**

SCALE

N.T.S.

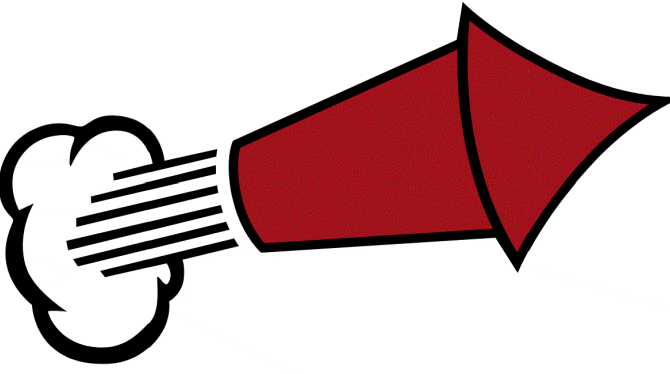

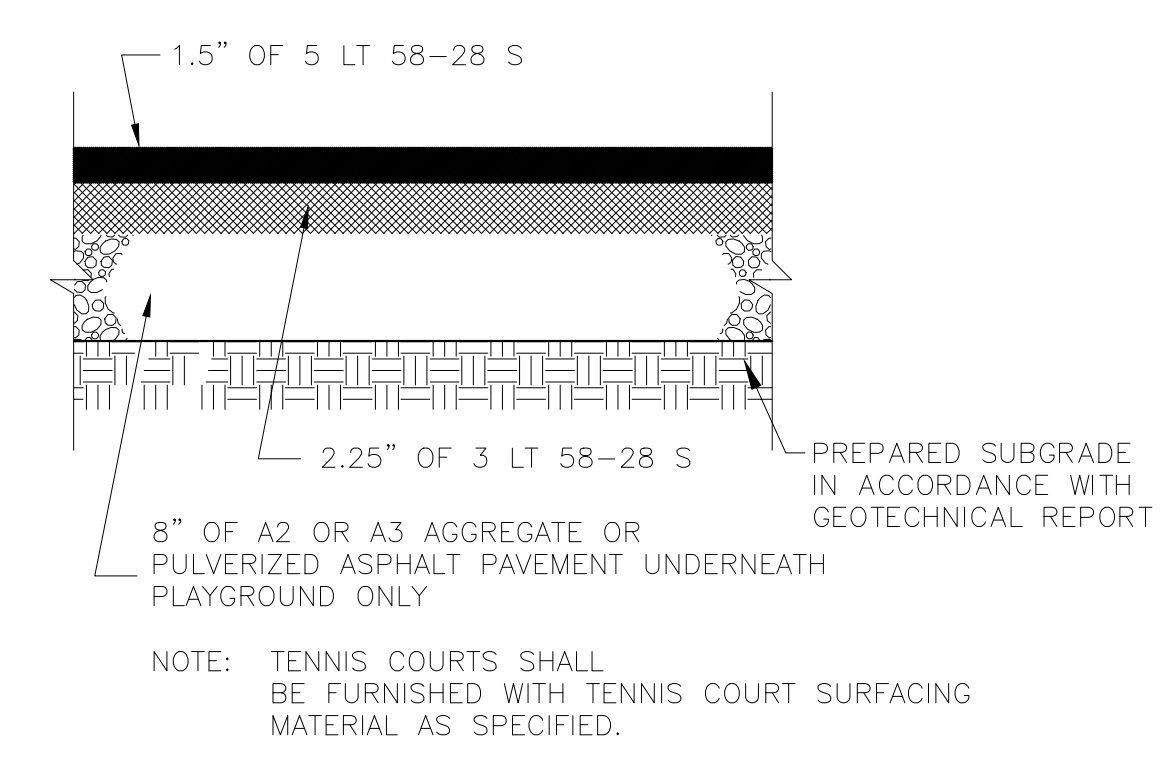
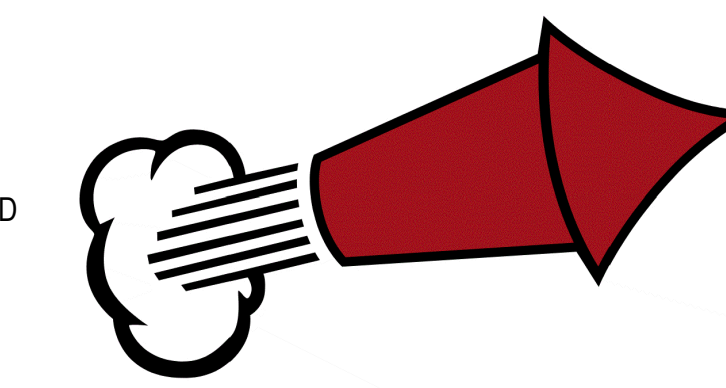

**01 ASPHALT PAVEMENT**  
SCALE N.T.S.

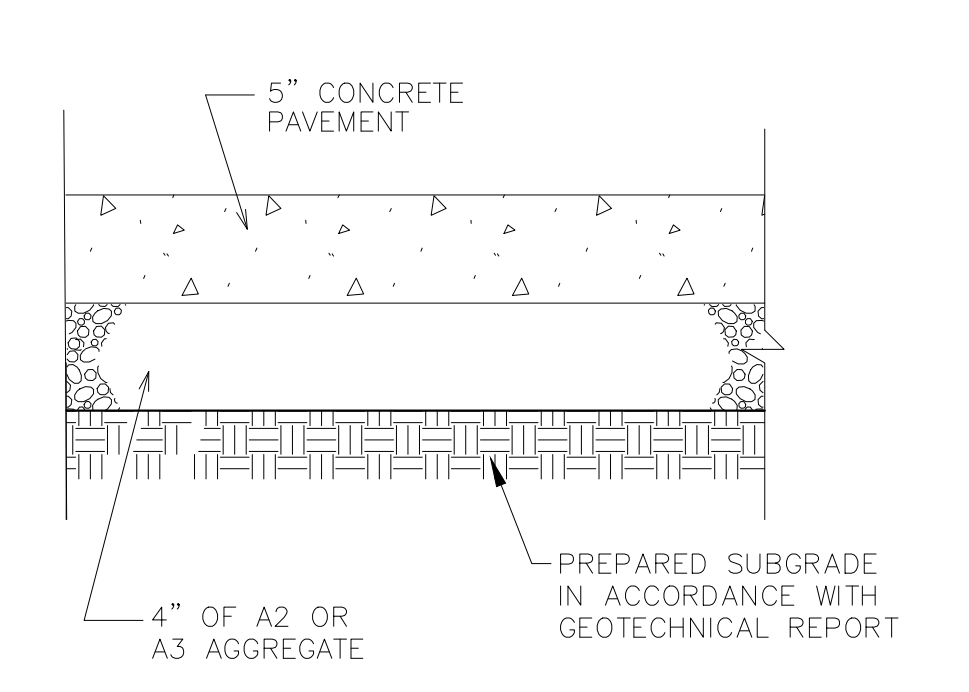

**02 CONCRETE SIDEWALK**  
SCALE N.T.S.

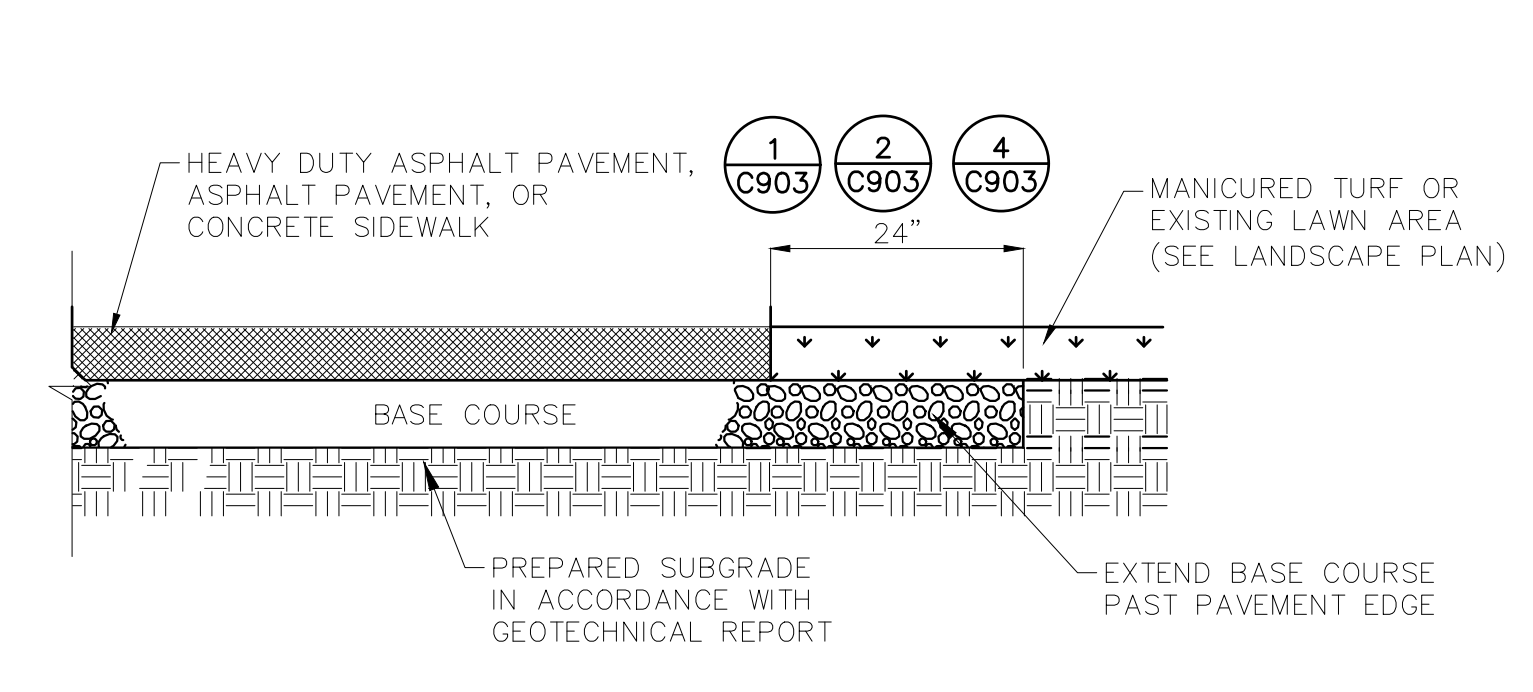

**03 PAVEMENT EDGE CONDITION**  
SCALE N.T.S.

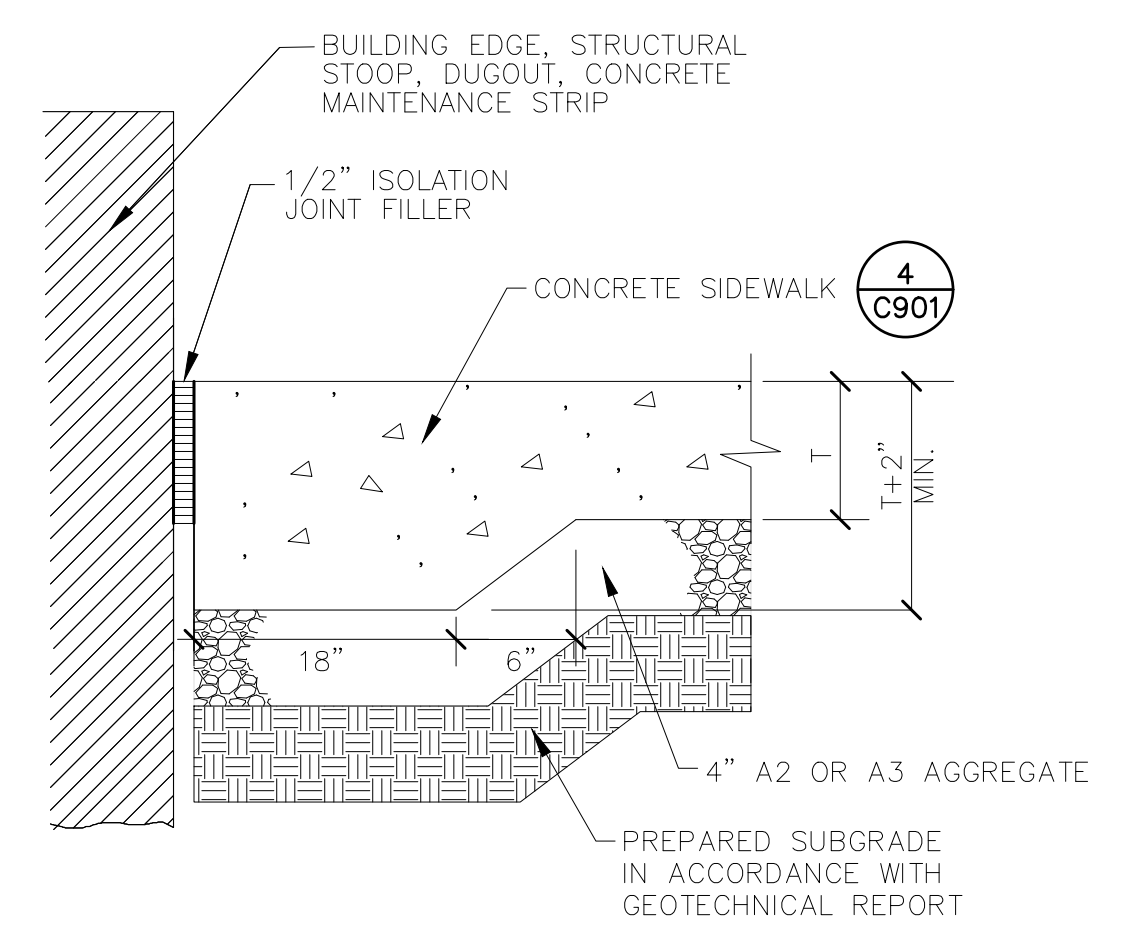

**08 ISOLATION JOINT**  
SCALE N.T.S.

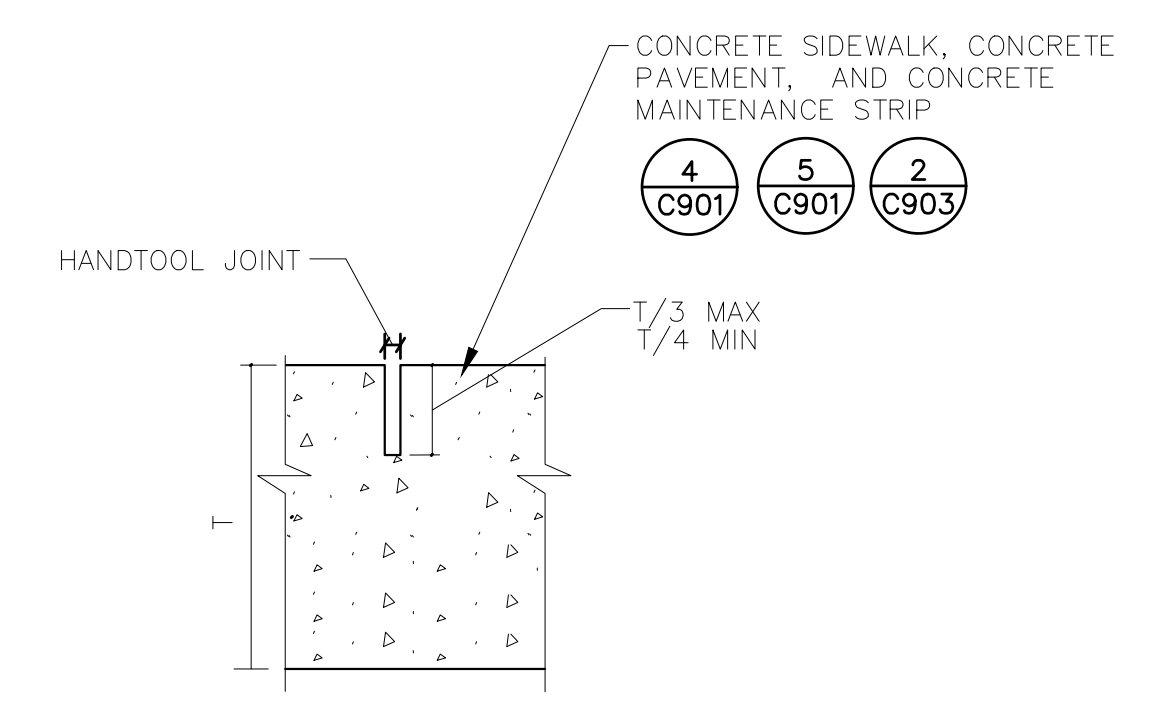

**09 CONTRACTION JOINT**  
SCALE N.T.S.

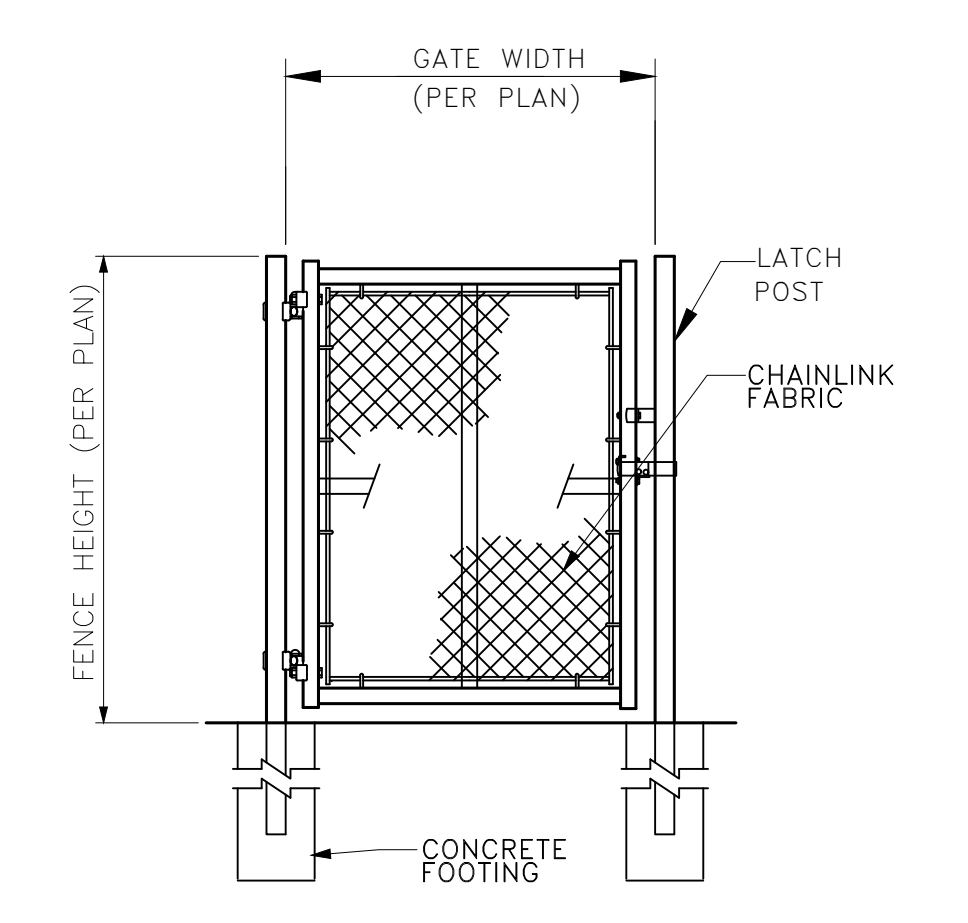

**14 SINGLE SWING GATE DETAIL**  
SCALE N.T.S.

PROJECT TITLE:  
SOUTH MILWAUKEE HIGH SCHOOL  
ATHLETIC FIELD IMPROVEMENTS

801 15TH AVENUE  
SOUTH MILWAUKEE, WI 53172

NO.	DATE	REVISIONS	BY	ISSUE:

CONSTRUCTION DOCUMENTS

PROJECT INFORMATION:

PROJECT NUMBER:	2021-0492
DATE:	10-14-2022
DRAWN BY:	MDS
CHECKED BY:	BRL
APPROVED BY:	JFP
SCALE:	AS SHOWN

SHEET TITLE:  
CONSTRUCTION DETAILS

SHEET NUMBER:





PROJECT TITLE:  
SOUTH MILWAUKEE HIGH SCHOOL  
ATHLETIC FIELD IMPROVEMENTS

801 15TH AVENUE  
SOUTH MILWAUKEE, WI 53172

NO.	DATE	REVISIONS	BY	ISSUE:

CONSTRUCTION DOCUMENTS

PROJECT INFORMATION:

PROJECT NUMBER: 2021-0492  
DATE: 10-14-2022  
DRAWN BY: MDS  
CHECKED BY: BRL  
APPROVED BY: JFP  
SCALE: AS SHOWN

SHEET TITLE:

CONSTRUCTION DETAILS

SHEET NUMBER:

# C905

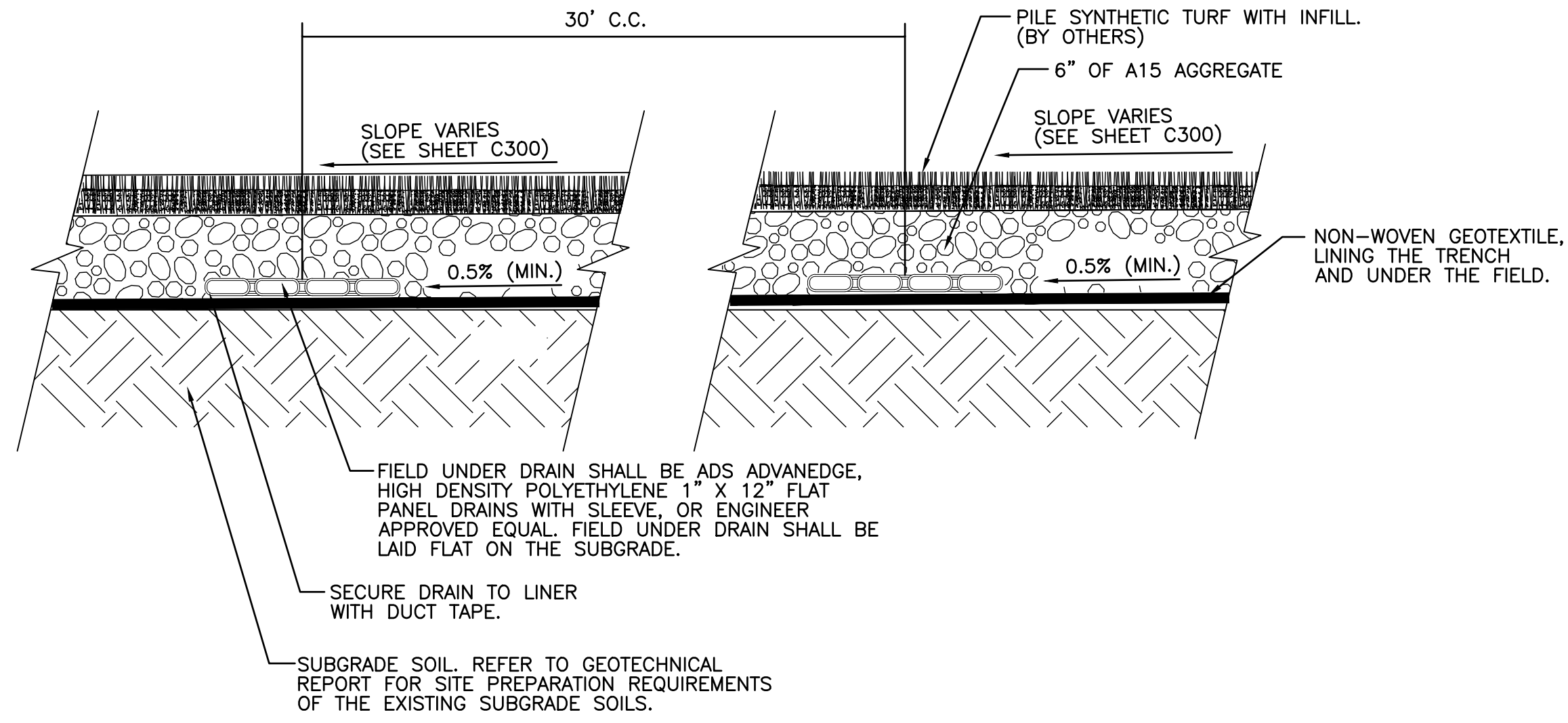

**1 SYNTHETIC TURF CROSS SECTION**  
N.T.S.

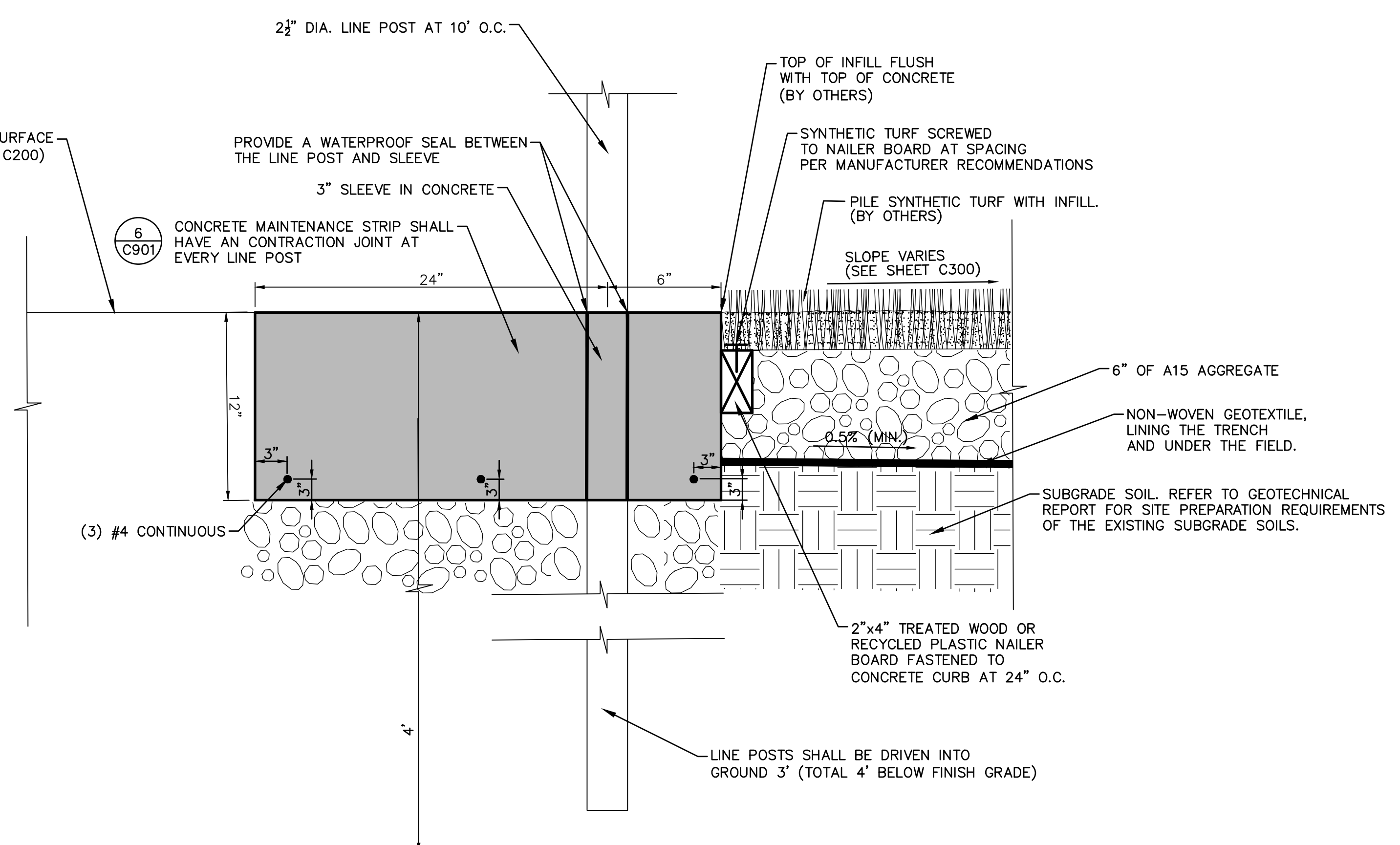

**2 TURF EDGE**  
N.T.S.

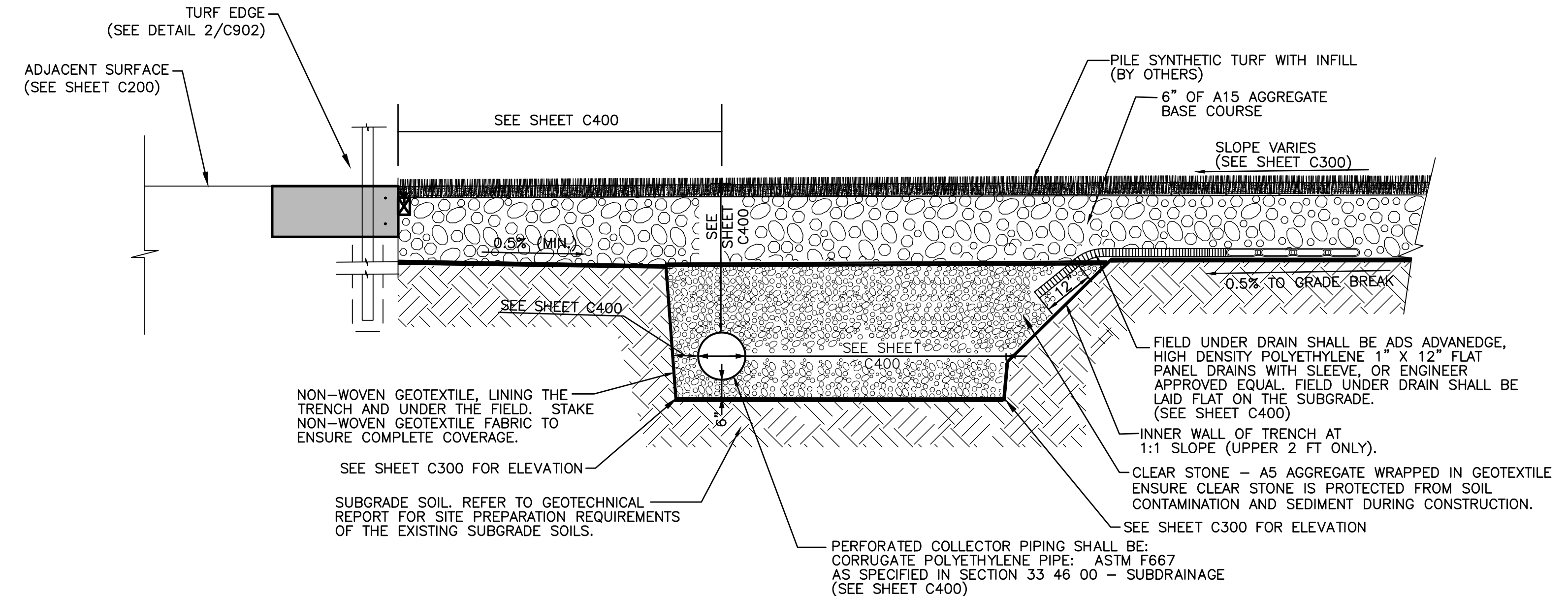

**3 SYNTHETIC TURF COLLECTOR PIPE**  
N.T.S.