



# Recommendations

For the Future of Milwaukee's Downtown Lakefront

# Committee Report



## Recommendations:

1. The redevelopment of the Downtown Transit Center
2. The reconfiguration of the Lincoln Memorial Drive/Michigan Street Intersection
3. The improvement of O'Donnell Park
4. The reconfiguration of the Lake Interchange
5. The installation of a bicycle/pedestrian lane to and over the Hoan Bridge
6. Increased accessibility and connectivity

# Long-Range Lakefront Committee

## Preamble

We, the Long-Range Lakefront Planning Committee, do hereby accept and present to the Milwaukee County Board of Supervisors the following recommendations regarding the site and use of the Downtown Transit Center and O'Donnell Park and Parking Structure for long range planning for the development of the lakefront.



Brian Taffora, Director, Economic Development, Milwaukee County

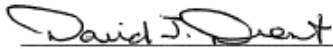

David Drent, Executive Director, War Memorial



Daniel Keegan, Director, Milwaukee Art Museum

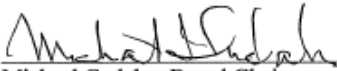

Michael Cudahy, Board Chairman, Discovery World



Gerry Broderick, Supervisor, 3<sup>rd</sup> District, Milwaukee County



Erbert Johnson, President, CEO, North Milwaukee State Bank

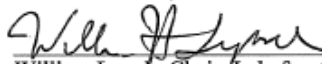

William Lynch, Chair, Lakefront Development Advisory Commission



Molly Gallagher, Board President, Betty Brinn Children's Museum



Rocky Marcoux, Commissioner, Department of City Development

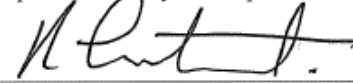

Robert Greenstreet, Professor, Dean, University of Wisconsin - Milwaukee



Donald W. Layden, Jr., Quatles & Brady, LLP, Milwaukee World Festival, Inc.



Nik Kovac, Alderman, 3<sup>rd</sup> District, City of Milwaukee

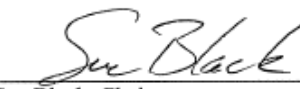

Sue Black, Chair Director, Department of Parks, Recreation and Culture, Milwaukee County



## Executive Summary

After meeting for four months, gathering all necessary background information and considering a wide range of options for the development of the lakefront from Van Buren Street east to Lake Michigan and from Veteran's Park south to the Interstate 794 Interchange, specifically including the Downtown Transit Center, O'Donnell Park and other assets such as parkland and lakebed grant properties, the Committee recommends the following:

### **Recommendations:**

1. **The redevelopment of the Downtown Transit Center** site into a multi-story, high-value use more appropriate to its location at the lakefront.
2. **The installation of a bicycle/pedestrian lane to and over the Hoan Bridge**, connecting Downtown to southern Milwaukee for all modes of transportation.
3. **The reconfiguration of the Lincoln Memorial Drive/Michigan Street intersection** to provide an efficient and safe means of pedestrian conveyance, maintaining a balance with motorized transportation, and creating a revitalized front door to the city of Milwaukee.
4. **The reconfiguration of the Lake Interchange** ramps to free up valuable space for development and increase connectivity from Downtown and the Third Ward to the lakefront.
5. **The continuation of O'Donnell Park** in its current function in the short-term, while considering redevelopment options long-term.
6. **Increased accessibility** to and along the lakefront for all modes of transportation and greater connectivity to the City.

This Committee also recommends the development of a lakefront master plan to aid in the implementation of these recommendations and other areas some Committee members felt were important. This document should include a more detailed economic development and financial plan for the lakefront. The reduction of the seasonality of the lakefront should be one of the goals of the implementation of the master plan, creating a lakefront that draws visitors throughout the year.

With redevelopment, new businesses would be attracted to the area, which would draw new patrons to the lakefront. This redevelopment should also include a vision for parks and public spaces to create an attractive, innovative lakefront that improves the connectivity of Downtown and the lakefront. Through these recommendations, Milwaukee's lakefront will become a fantastic, world-renowned front door to the city, county, and state.

*In planning for the future of the lakefront, we have a tremendous opportunity to do something spectacular for the state of Wisconsin, for Milwaukee County and for the city of Milwaukee – but, most importantly, for our citizens and the visitors to this fantastic resource. The 1989 Lakefront Master Plan stated that this area “is considered to be the most heavily used recreational land in Wisconsin”.*

*Let's get this done right and with a sense of urgency and pride.*

*-Sue Black*

# LONG-RANGE LAKEFRONT PLANNING COMMITTEE

## *Vision / Cooperation*

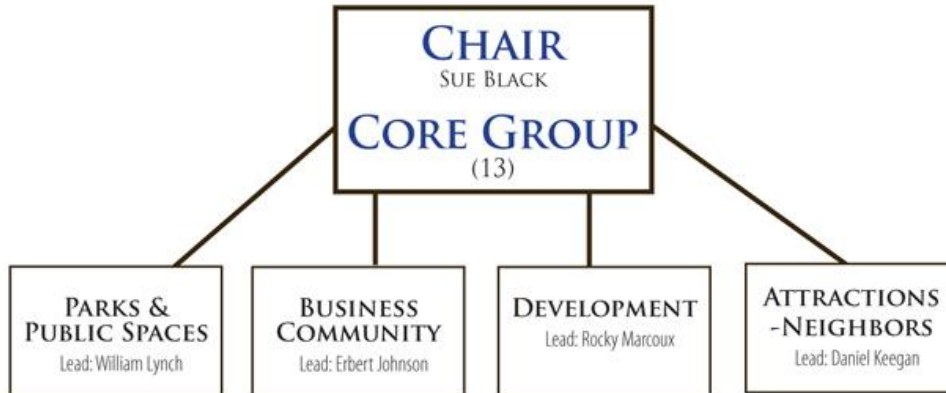

### APPOINTMENTS/MEMBERS

Sue Black	Director, Parks, Recreation and Culture, Milwaukee County
Brain Taffora	Director, Economic Development, Milwaukee County
David Drent	Executive Director, War Memorial, Inc.
Daniel Keegan	Director, Milwaukee Art Museum
Michael Cudahy	Board Member Discovery World
Gerry Broderick	Supervisor, 3rd District, Milwaukee County
Erbert Johnson	President/CEO, North Milwaukee State Bank, Business Community Chair,
William Lynch	Lakefront Development Advisory Commission
Molly Gallagher	Betty Brinn Children's Museum
Rocky Marcoux	Commissioner, Dept. of City Development
Robert Greenstreet	Professor, Dean, UWM
Donald W. Layden, Jr.	Quaries & Brady, LLP, Milwaukee World Festival, Inc.
Nik Kovac	Alderman, 3rd District, City of Milwaukee

1 By Supervisors Jurisk and Broderick

### A RESOLUTION

6 Creating the Long Range Lakefront Planning Committee to develop a vision for the  
7 lakefront from Veterans Park south to the Interstate 794 interchange, and from Van  
8 Buren east to Lake Michigan and planning for O'Donnell Park and the Downtown  
9 Transit Center.

12 WHEREAS, since the failure of a decorative panel on the O'Donnell Park parking  
13 structure in June of 2010, much discussion has occurred within the community over the  
14 future of O'Donnell Park; and

16 WHEREAS, because of the physical connection of O'Donnell Park and location  
17 on the southwest corner of Michigan Street and Lincoln Memorial Drive, alternative uses  
18 for the Downtown Transit Center site have also generated discussion; and

20 WHEREAS, in addition, the Milwaukee Common Council and Mayor approved a  
21 vision to the Downtown Area Comprehensive Plan (Plan) in October of 2010, which  
22 includes recommendations for improvements to the lakefront from Van Buren Street  
23 east to Lake Michigan and specifically at the Downtown Transit Center, O'Donnell Park  
24 and other assets including parkland and lakebed grant properties; and

26 WHEREAS, while many of the City of Milwaukee Plan's recommendations have  
27 been echoed by various community stakeholders, other stakeholders such as  
28 Milwaukee County, desire a greater discussion about the future of the lakefront,  
29 particularly as the Plan relates to the Downtown Transit Center and O'Donnell Park; and

31 WHEREAS, establishment of a long range, lakefront planning committee would  
32 provide an open forum for representatives of lakefront stakeholders to create a common  
33 vision for the future of the lakefront; now, therefore,

34  
35 BE IT RESOLVED, the Milwaukee County Board of Supervisors does hereby  
36 create the Long Range Lakefront Planning Committee that will develop a common  
37 vision for the lakefront from Veterans Park south to the Interstate 794 interchange, and  
38 from Van Buren east to Lake Michigan; and

39  
40 BE IT FURTHER RESOLVED, the Long Range Lakefront Planning Committee  
41 shall consider alternative uses of the Downtown Transit Center and O'Donnell Park  
42 among other future uses of the lakefront and preservation of green space; and

43  
44 BE IT FURTHER RESOLVED, that the Long Range Lakefront Planning  
45 Committee will be comprised of members from the following organizations/agencies as  
46 follows:

- 47 • Six government officials to be appointed as follows: (1) by the Mayor of  
48 the City of Milwaukee, Commissioner of the Department of City  
49 Development, or designee, and a representative of the UWM School of  
50 Architecture and Urban Planning; (2) by the Common Council President; a  
51 member of the Milwaukee Common Council; (3) by the County Executive;  
52 Director of the Parks Department (or designee); and Director of Economic  
53 Development; and (4) by the County Board Chairman, a member of the  
54 County Board.
- 55 • Six members of the public to be appointed as follows: (1) by the County  
56 Executive, a representative of the War Memorial Center, a representative  
57 of the Milwaukee Art Museum and a representative of Discovery World;  
58 (2) by the County Board Chairman; a representative of the business  
59 community, the chairman of the Lakefront Development Advisory  
60 Commission, and a representative of the Betty Brinn Children's Museum;  
61 (3) by the Mayor of the City of Milwaukee; a representative of Summerfest

62 ; and

63  
64  
65  
66 BE IT FURTHER RESOLVED, that the Long Range Lakefront Planning  
67 Committee shall provide the Milwaukee County Board of Supervisors and the  
68 Milwaukee Common Council with a final report by December of 2012 that shall include  
69 recommendations regarding: (1) site and use of O'Donnell Park and the Downtown  
70 Transit Center and (2) the structure for long range planning for the economic  
71 development of the lakefront (as defined above), including a vision for current and future  
72 stakeholders as well as a long range financial/development implementation plan to  
73 realize the agreed upon vision; and

74  
75 BE IT FURTHER RESOLVED, that the Long Range Lakefront Planning  
76 Committee shall provide the Milwaukee County Board of Supervisors and the  
77 Milwaukee Common Council with regular updates as to the Committee's progress; and

78  
79 BE IT FURTHER RESOLVED, that all appointments to the Committee shall  
80 occur within 30 days of adoption of the resolution and that the Parks Director shall serve  
81 as the committee chairperson.

82  
83  
84  
85  
86  
87  
88  
89  
90  
91  
92  
93  
94  
95  
96  
97  
98  
99  
100  
101  
102  
103  
104  
105  
106  
107  
108  
109  
110  
111  
112  
113  
114  
115  
116  
117  
118  
119  
120  
121  
122  
123  
124  
125  
126  
127  
128  
129  
130  
131  
132  
133  
134  
135  
136  
137  
138  
139  
140  
141  
142  
143  
144  
145  
146  
147  
148  
149  
150  
151  
152  
153  
154  
155  
156  
157  
158  
159  
160  
161  
162  
163  
164  
165  
166  
167  
168  
169  
170  
171  
172  
173  
174  
175  
176  
177  
178  
179  
180  
181  
182  
183  
184  
185  
186  
187  
188  
189  
190  
191  
192  
193  
194  
195  
196  
197  
198  
199  
200  
201  
202  
203  
204  
205  
206  
207  
208  
209  
210  
211  
212  
213  
214  
215  
216  
217  
218  
219  
220  
221  
222  
223  
224  
225  
226  
227  
228  
229  
230  
231  
232  
233  
234  
235  
236  
237  
238  
239  
240  
241  
242  
243  
244  
245  
246  
247  
248  
249  
250  
251  
252  
253  
254  
255  
256  
257  
258  
259  
260  
261  
262  
263  
264  
265  
266  
267  
268  
269  
270  
271  
272  
273  
274  
275  
276  
277  
278  
279  
280  
281  
282  
283  
284  
285  
286  
287  
288  
289  
290  
291  
292  
293  
294  
295  
296  
297  
298  
299  
300  
301  
302  
303  
304  
305  
306  
307  
308  
309  
310  
311  
312  
313  
314  
315  
316  
317  
318  
319  
320  
321  
322  
323  
324  
325  
326  
327  
328  
329  
330  
331  
332  
333  
334  
335  
336  
337  
338  
339  
340  
341  
342  
343  
344  
345  
346  
347  
348  
349  
350  
351  
352  
353  
354  
355  
356  
357  
358  
359  
360  
361  
362  
363  
364  
365  
366  
367  
368  
369  
370  
371  
372  
373  
374  
375  
376  
377  
378  
379  
380  
381  
382  
383  
384  
385  
386  
387  
388  
389  
390  
391  
392  
393  
394  
395  
396  
397  
398  
399  
400  
401  
402  
403  
404  
405  
406  
407  
408  
409  
410  
411  
412  
413  
414  
415  
416  
417  
418  
419  
420  
421  
422  
423  
424  
425  
426  
427  
428  
429  
430  
431  
432  
433  
434  
435  
436  
437  
438  
439  
440  
441  
442  
443  
444  
445  
446  
447  
448  
449  
450  
451  
452  
453  
454  
455  
456  
457  
458  
459  
460  
461  
462  
463  
464  
465  
466  
467  
468  
469  
470  
471  
472  
473  
474  
475  
476  
477  
478  
479  
480  
481  
482  
483  
484  
485  
486  
487  
488  
489  
490  
491  
492  
493  
494  
495  
496  
497  
498  
499  
500  
501  
502  
503  
504  
505  
506  
507  
508  
509  
510  
511  
512  
513  
514  
515  
516  
517  
518  
519  
520  
521  
522  
523  
524  
525  
526  
527  
528  
529  
530  
531  
532  
533  
534  
535  
536  
537  
538  
539  
540  
541  
542  
543  
544  
545  
546  
547  
548  
549  
550  
551  
552  
553  
554  
555  
556  
557  
558  
559  
560  
561  
562  
563  
564  
565  
566  
567  
568  
569  
570  
571  
572  
573  
574  
575  
576  
577  
578  
579  
580  
581  
582  
583  
584  
585  
586  
587  
588  
589  
590  
591  
592  
593  
594  
595  
596  
597  
598  
599  
600  
601  
602  
603  
604  
605  
606  
607  
608  
609  
610  
611  
612  
613  
614  
615  
616  
617  
618  
619  
620  
621  
622  
623  
624  
625  
626  
627  
628  
629  
630  
631  
632  
633  
634  
635  
636  
637  
638  
639  
640  
641  
642  
643  
644  
645  
646  
647  
648  
649  
650  
651  
652  
653  
654  
655  
656  
657  
658  
659  
660  
661  
662  
663  
664  
665  
666  
667  
668  
669  
670  
671  
672  
673  
674  
675  
676  
677  
678  
679  
680  
681  
682  
683  
684  
685  
686  
687  
688  
689  
690  
691  
692  
693  
694  
695  
696  
697  
698  
699  
700  
701  
702  
703  
704  
705  
706  
707  
708  
709  
710  
711  
712  
713  
714  
715  
716  
717  
718  
719  
720  
721  
722  
723  
724  
725  
726  
727  
728  
729  
730  
731  
732  
733  
734  
735  
736  
737  
738  
739  
740  
741  
742  
743  
744  
745  
746  
747  
748  
749  
750  
751  
752  
753  
754  
755  
756  
757  
758  
759  
760  
761  
762  
763  
764  
765  
766  
767  
768  
769  
770  
771  
772  
773  
774  
775  
776  
777  
778  
779  
780  
781  
782  
783  
784  
785  
786  
787  
788  
789  
790  
791  
792  
793  
794  
795  
796  
797  
798  
799  
800  
801  
802  
803  
804  
805  
806  
807  
808  
809  
810  
811  
812  
813  
814  
815  
816  
817  
818  
819  
820  
821  
822  
823  
824  
825  
826  
827  
828  
829  
830  
831  
832  
833  
834  
835  
836  
837  
838  
839  
840  
841  
842  
843  
844  
845  
846  
847  
848  
849  
850  
851  
852  
853  
854  
855  
856  
857  
858  
859  
860  
861  
862  
863  
864  
865  
866  
867  
868  
869  
870  
871  
872  
873  
874  
875  
876  
877  
878  
879  
880  
881  
882  
883  
884  
885  
886  
887  
888  
889  
890  
891  
892  
893  
894  
895  
896  
897  
898  
899  
900  
901  
902  
903  
904  
905  
906  
907  
908  
909  
910  
911  
912  
913  
914  
915  
916  
917  
918  
919  
920  
921  
922  
923  
924  
925  
926  
927  
928  
929  
930  
931  
932  
933  
934  
935  
936  
937  
938  
939  
940  
941  
942  
943  
944  
945  
946  
947  
948  
949  
950  
951  
952  
953  
954  
955  
956  
957  
958  
959  
960  
961  
962  
963  
964  
965  
966  
967  
968  
969  
970  
971  
972  
973  
974  
975  
976  
977  
978  
979  
980  
981  
982  
983  
984  
985  
986  
987  
988  
989  
990  
991  
992  
993  
994  
995  
996  
997  
998  
999  
1000

# Long-Range Lakefront Committee Report



**Milwaukee's World Class Waterfront**

## Downtown Lakefront Land Use

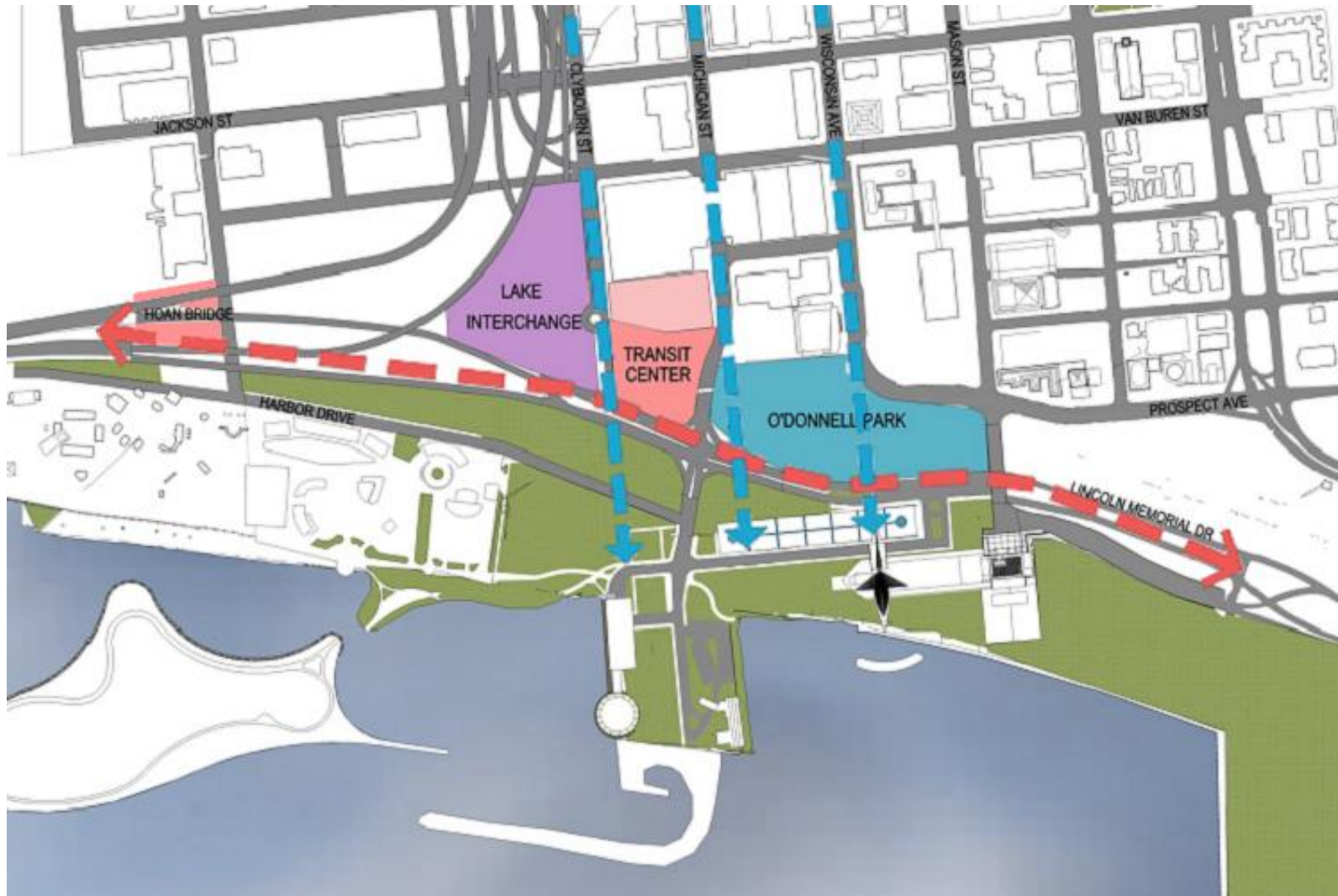

**Areas of consideration include:**

**Transit Center, O'Donnell Park, Lakefront Interchange, and Hoan Bridge**

# 1. The redevelopment of the Downtown Transit Center Site

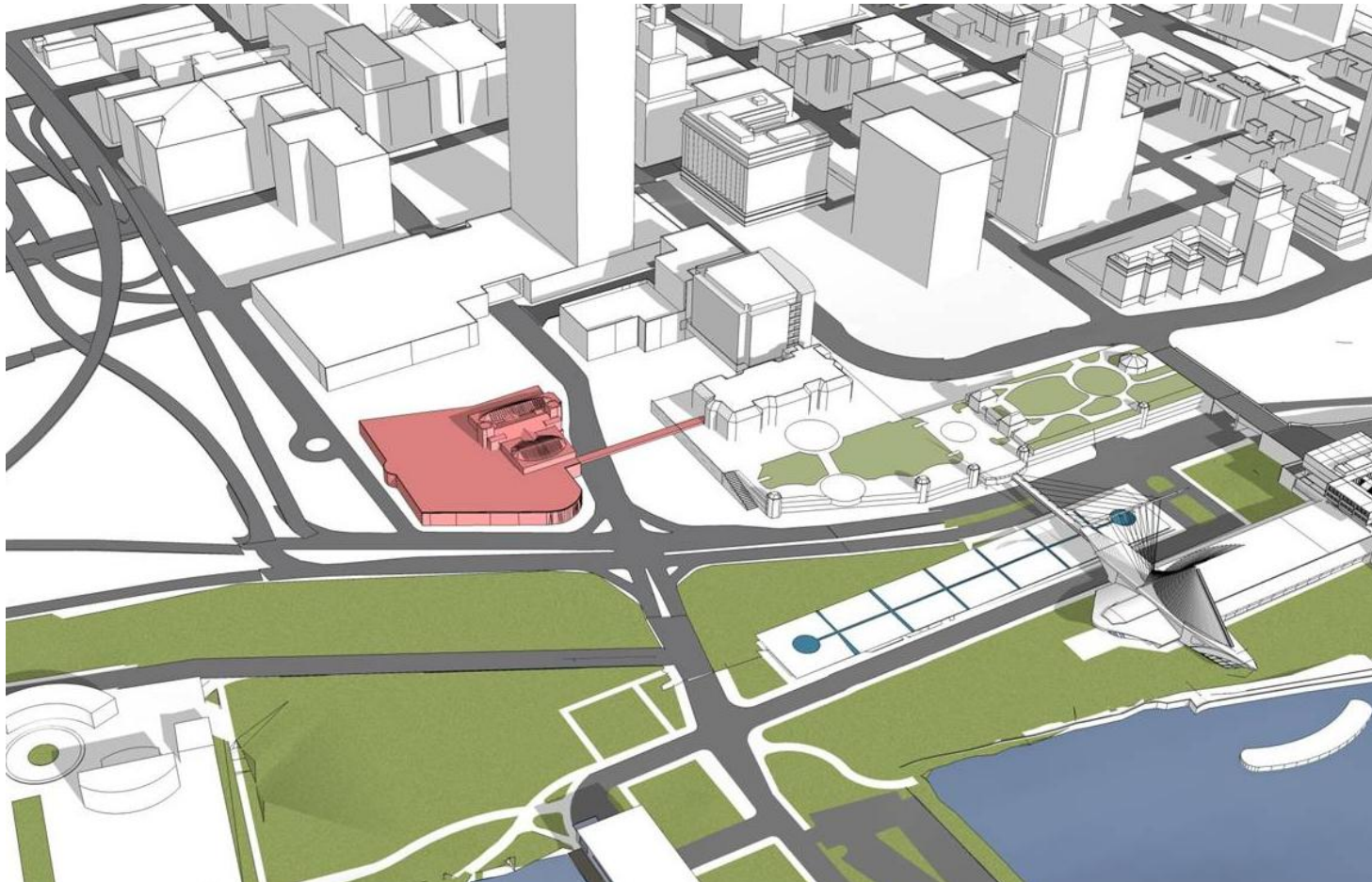

**CURRENT**



# 1. The redevelopment of the Downtown Transit Center Site

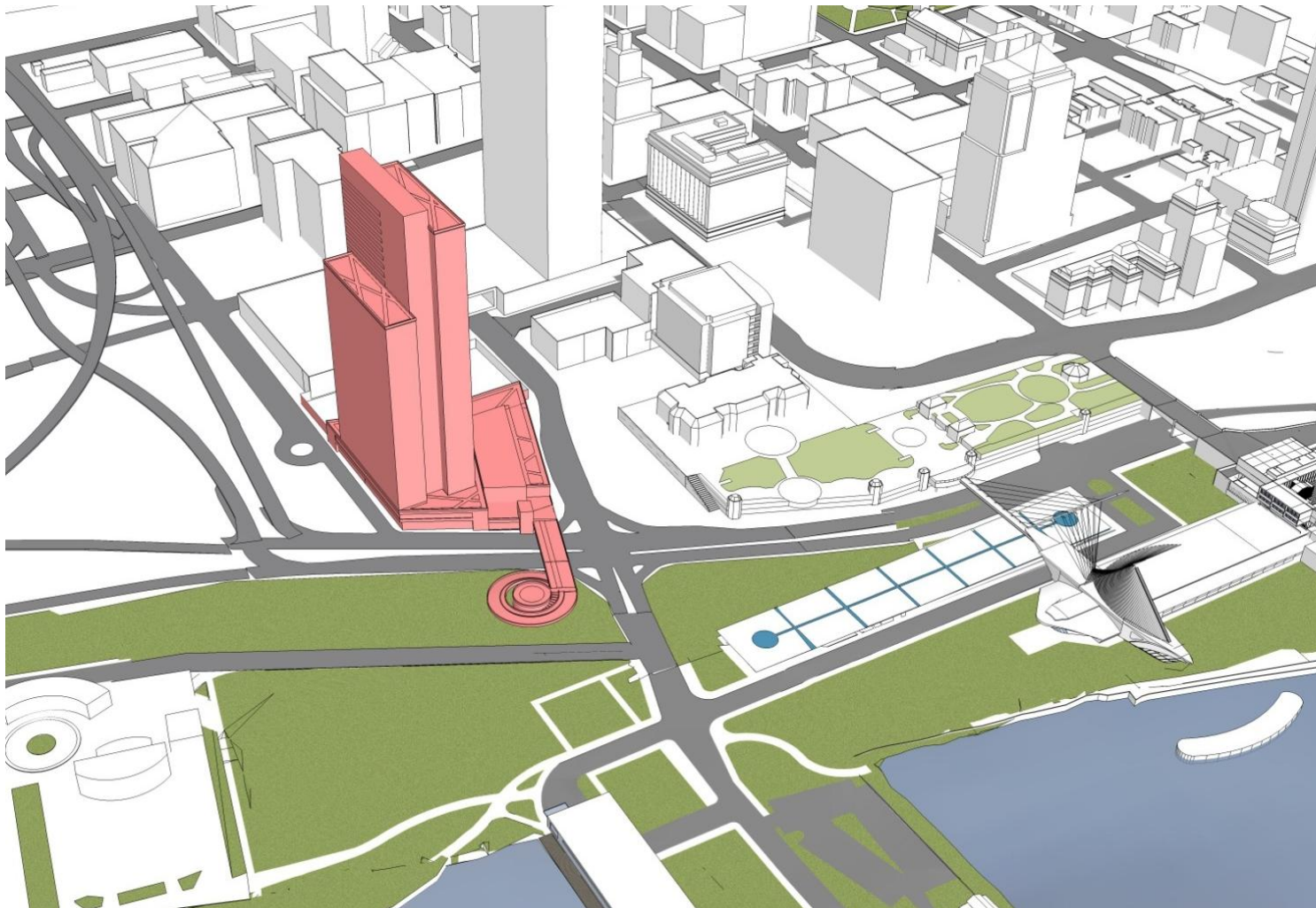

**FUTURE**

## 2. The reconfiguration of the Lincoln Memorial Drive/Michigan Street Intersection

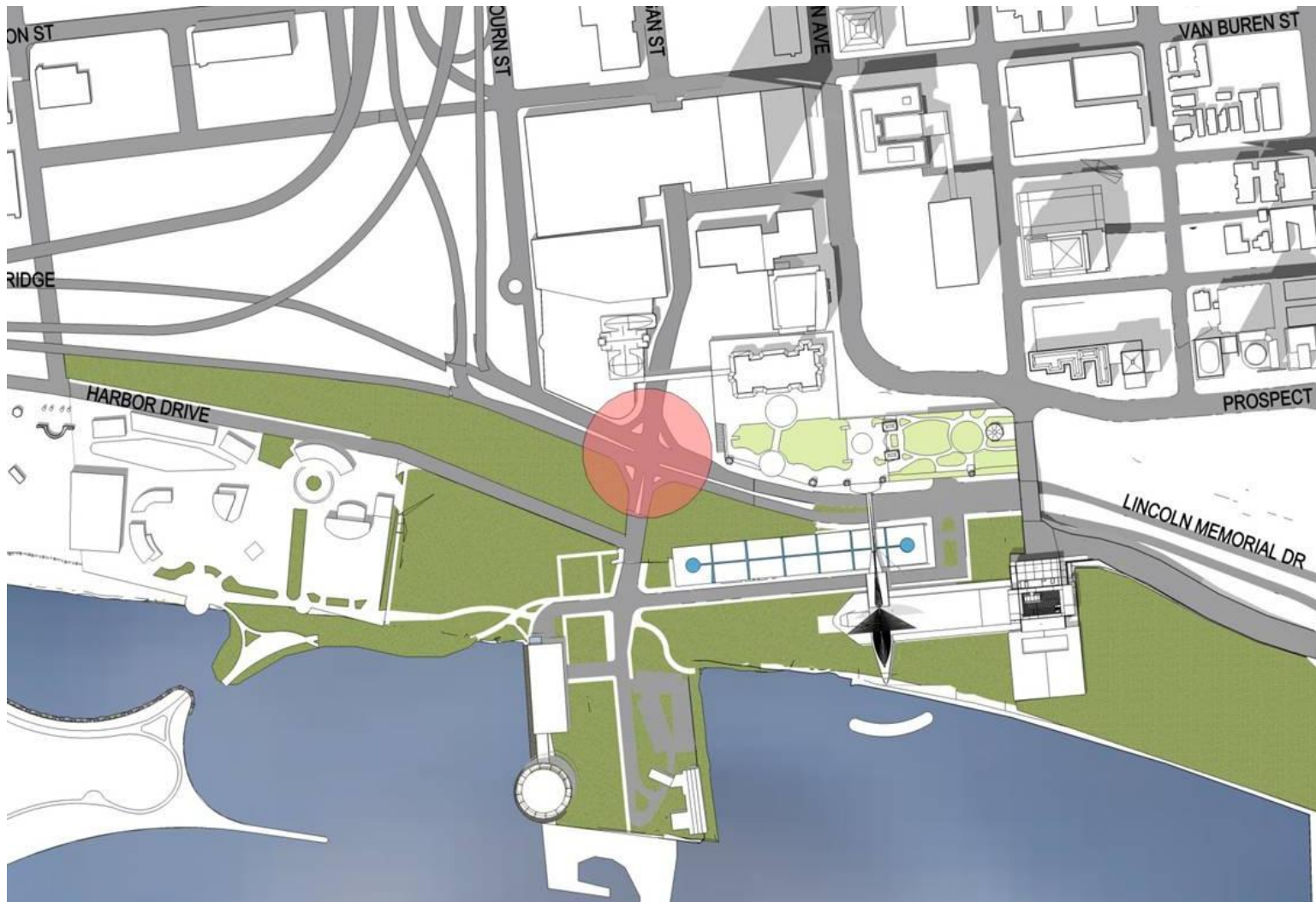

**CURRENT**

## 2. The reconfiguration of the Lincoln Memorial Drive/Michigan Street Intersection

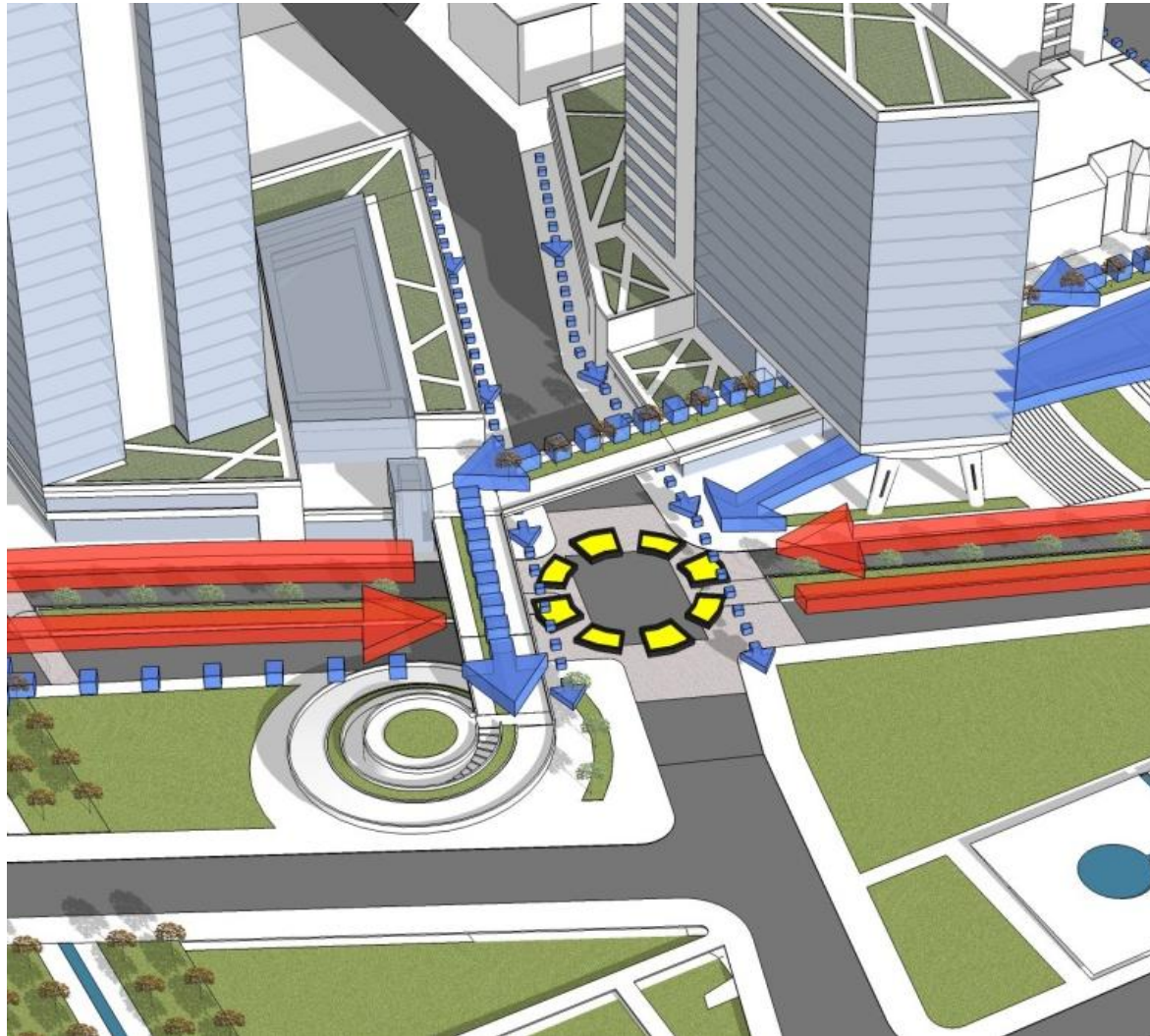

**CIRCULATION DIAGRAM**

### 3. The Improvement of O'Donnell Park

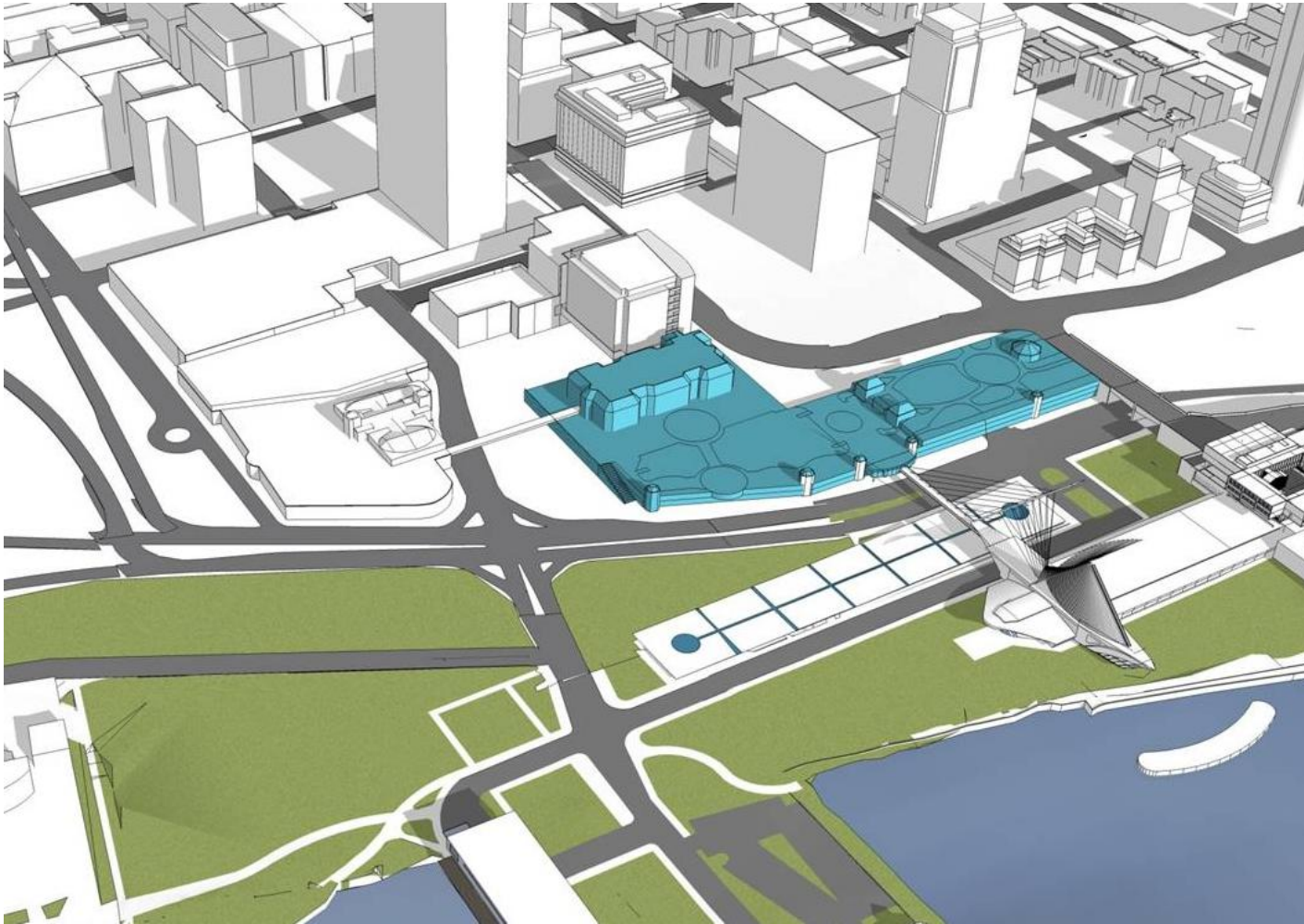

**CURRENT**

### 3. The Improvement of O'Donnell Park

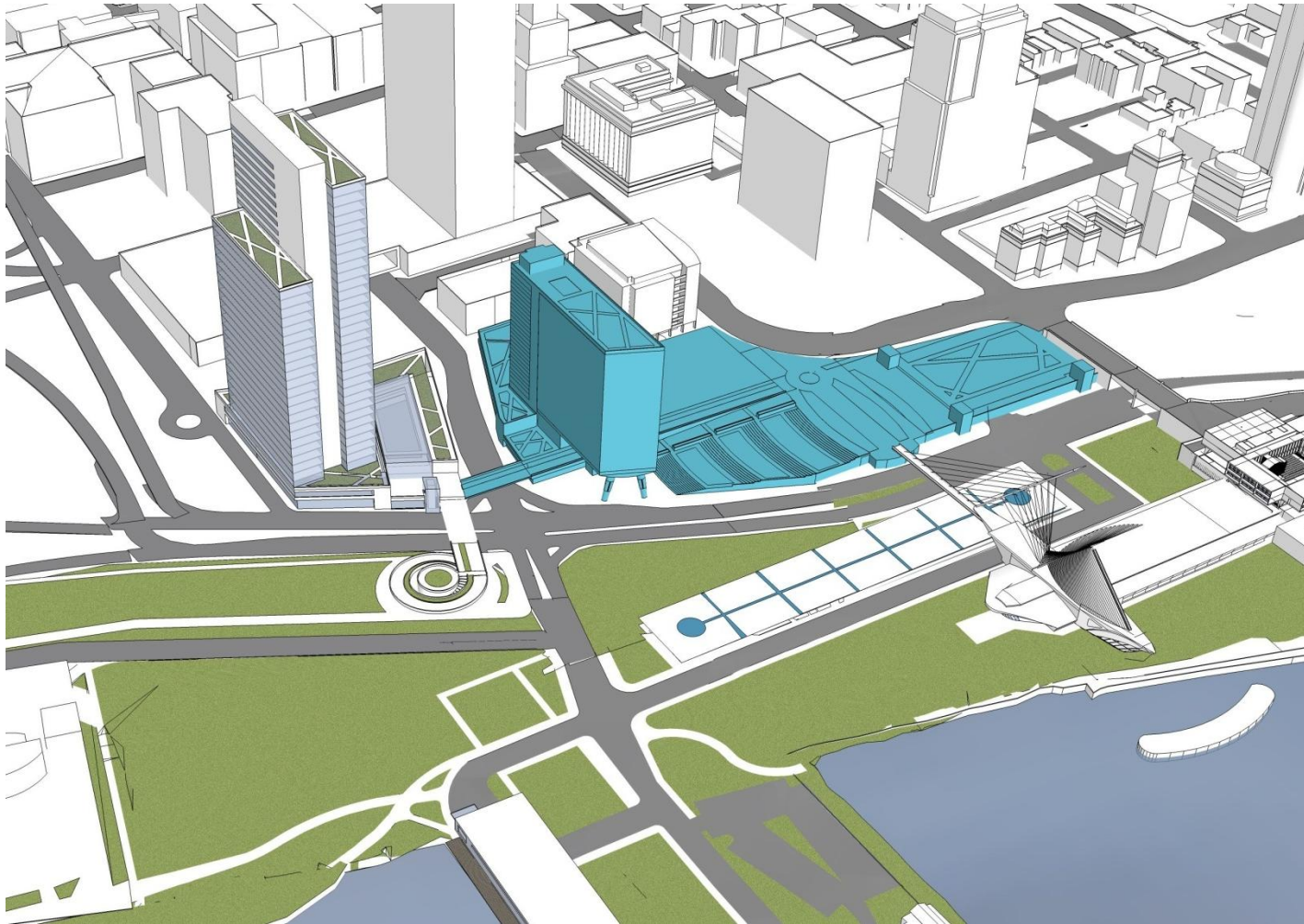

**FUTURE**

## 4. The reconfiguration of the Lake Interchange



**CURRENT**

#### 4. The reconfiguration of the Lake Interchange



**FUTURE**

#### 4. The reconfiguration of the Lake Interchange

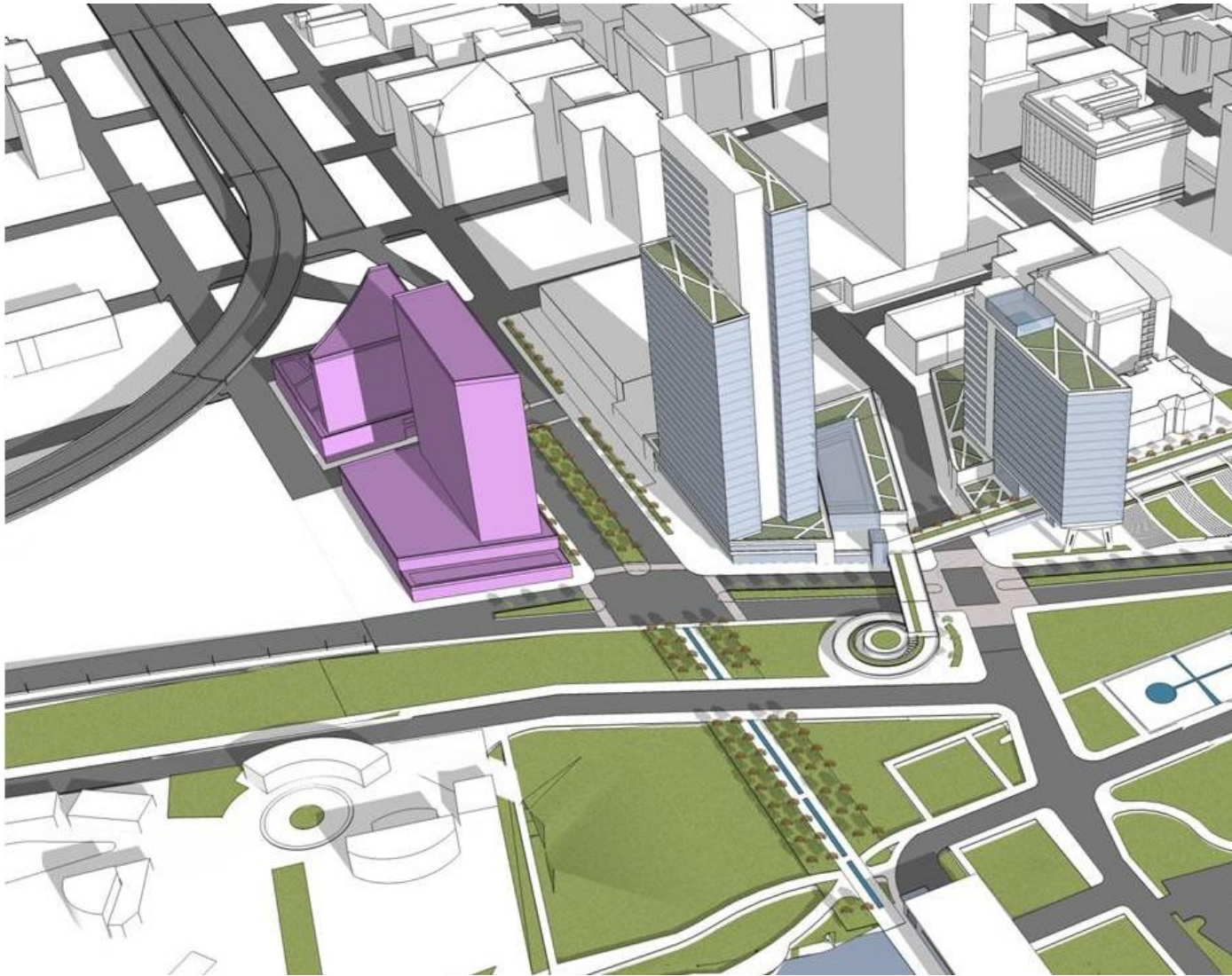

**FUTURE Development Site**



## 5. The installation of a bicycle/pedestrian lane to the Hoan Bridge

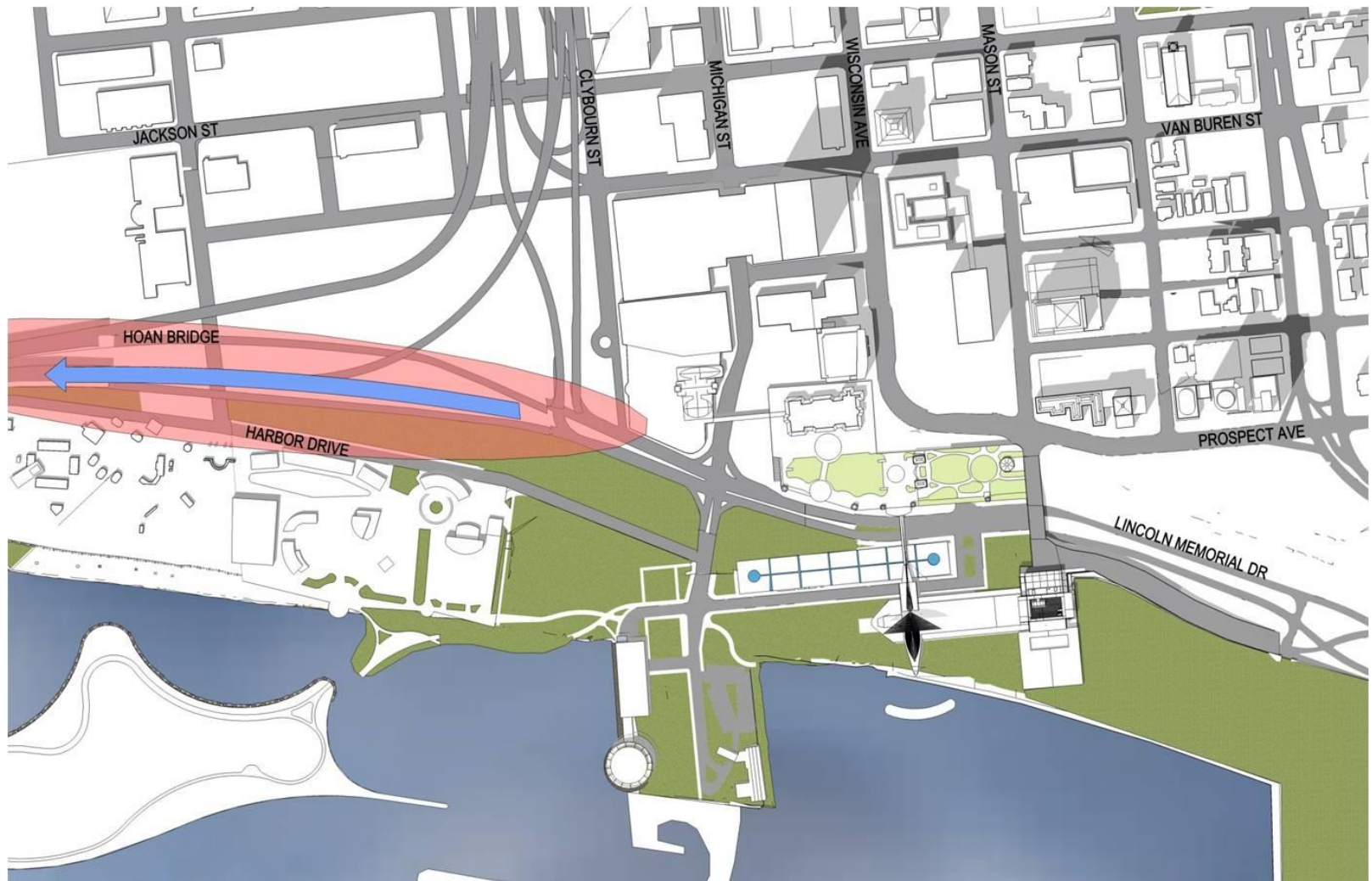

**CURRENT**

## 5. The installation of a bicycle/pedestrian lane to the Hoan Bridge

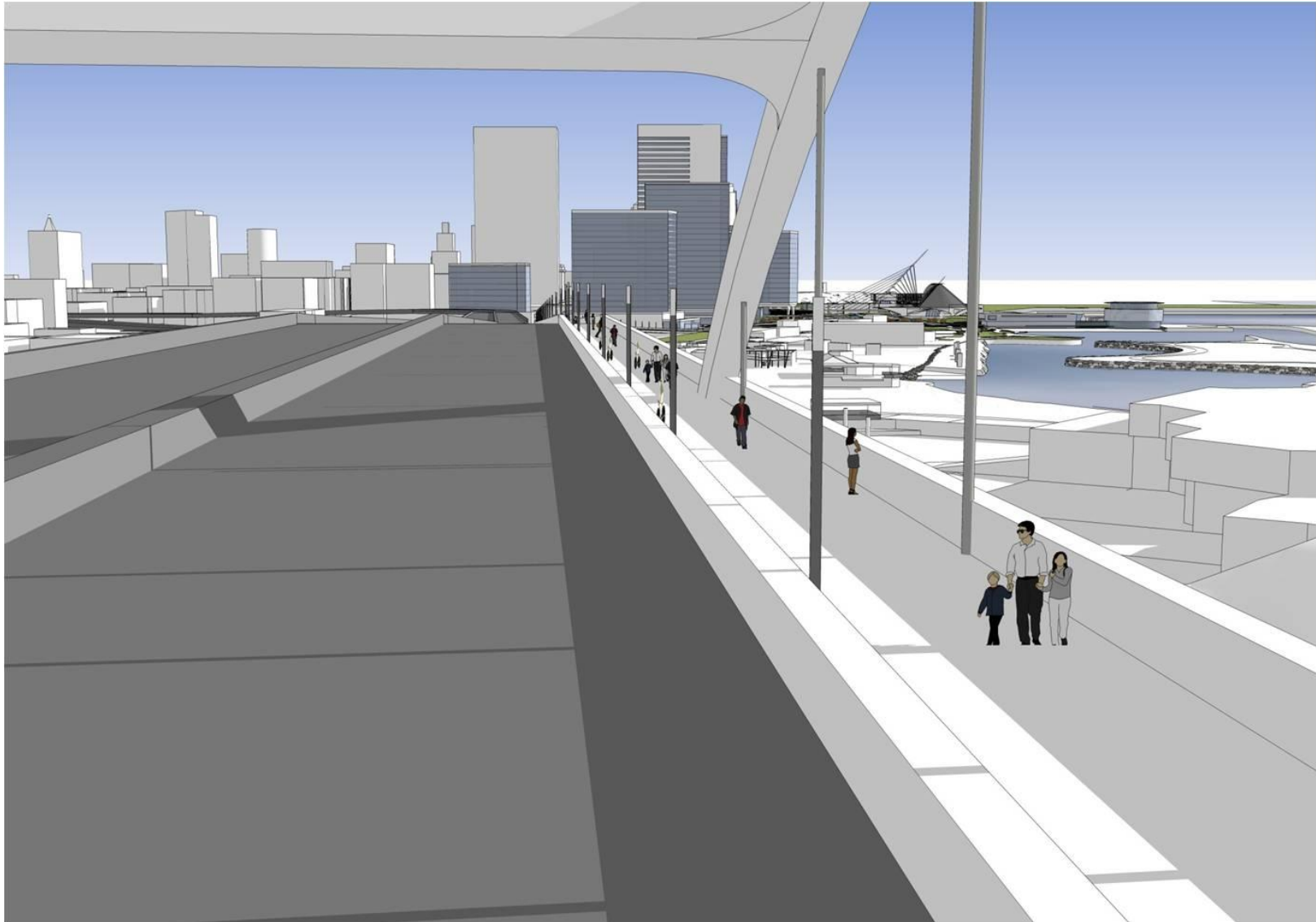

**FUTURE**

## 6. Increased accessibility and connectivity

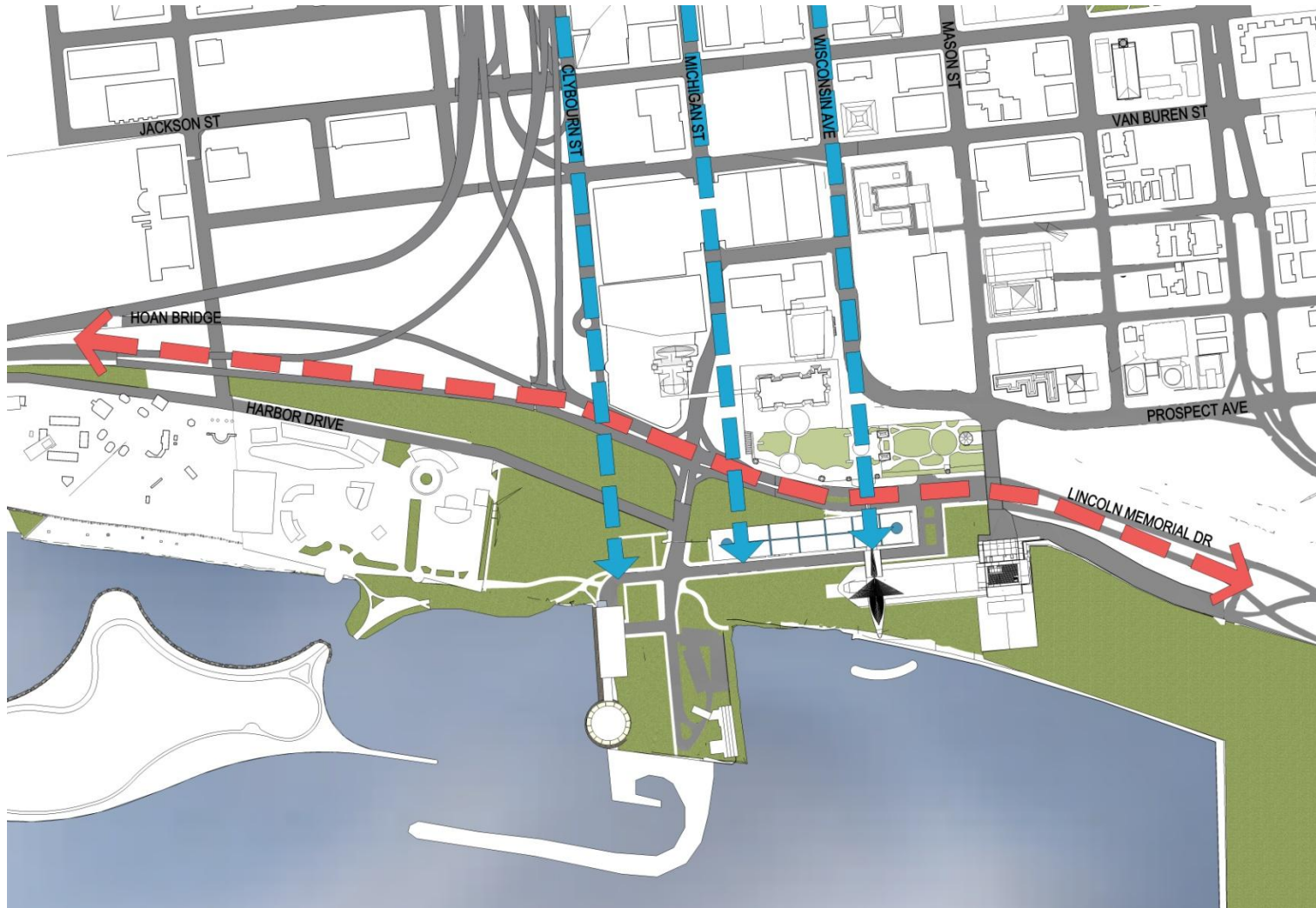

Access is achieved through visual and physical connections

## 6. Increased accessibility and connectivity

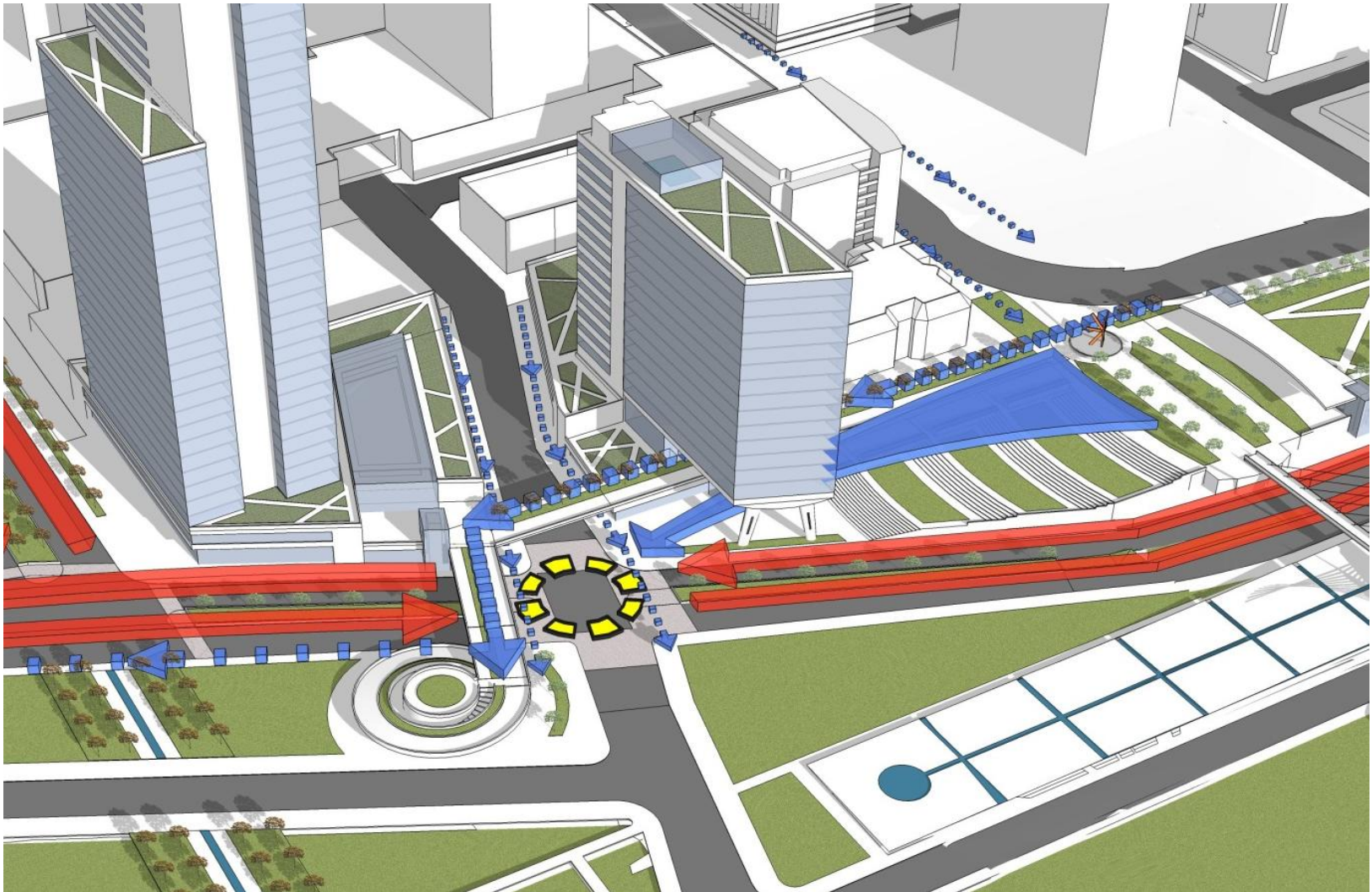

**MILWAUKEE DOWNTOWN LAKEFRONT - CURRENT**



**MILWAUKEE DOWNTOWN LAKEFRONT - FUTURE**



**MILWAUKEE DOWNTOWN LAKEFRONT - CURRENT**



**MILWAUKEE DOWNTOWN LAKEFRONT - FUTURE**







**LONG RANGE LAKEFRONT COMMITTEE**

THE ENHANCEMENT OF MILWAUKEE'S MOST VALUABLE PROPERTY

# WE'RE TOGETHER ON THIS ONE



THE  
GOVERNOR

THE  
COUNTY  
EXECUTIVE

THE  
MAYOR

**WORKING TOGETHER... WE'RE GOING TO MAKE  
MILWAUKEE'S LAKEFRONT SPECTACULAR!**