

DUPLICATE

TOWNSHIP 7 NORTH, RANGE 22 EAST, FOURTH PRINCIPAL MERIDIAN, WISCONSIN.
SURVEY OF TWO ISLANDS

Latitude 43°58'57" N
Longitude 87°55'56" W
T.M.D. 77

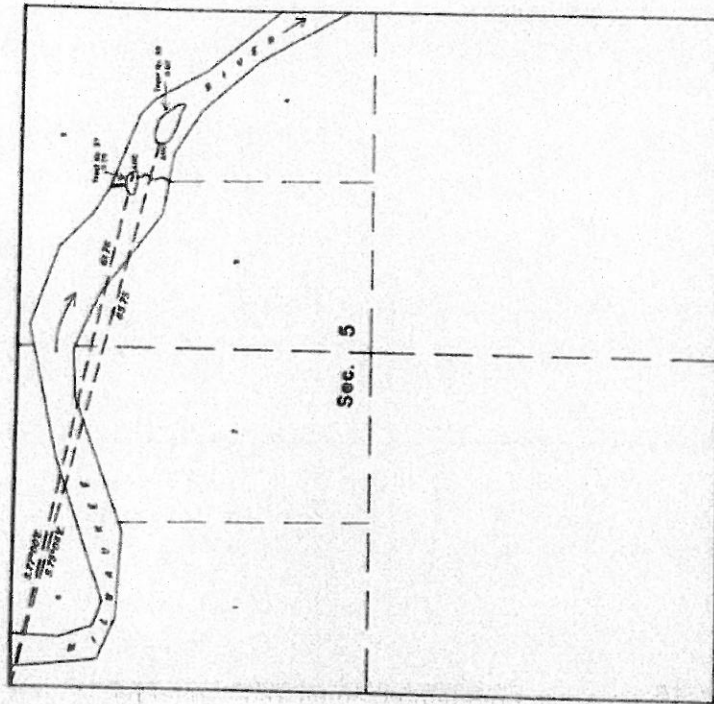

A history of surveys is contained in the field note record.

This plat represents the survey of two islands in the 4th Principal Meridian, Range 22 E., T. 7 N., R. 22 E., 4th Principal Meridian, Wisconsin.

Except as indicated hereon, the bearings and areas are as shown on the plat dated July 21, 1935.

Survey executed by Stephen D. Douglas, Cadastral Surveyor, beginning August 25, 1934 and completed September 10, 1934, through a special instruction for State No. 152, Wisconsin, dated and approved August 27, 1934.

UNITED STATES DEPARTMENT OF THE INTERIOR
BUREAU OF LAND MANAGEMENT
Springfield, Virginia March 13, 1935

This plat is strictly conformable to the approved field notes, and the survey, having been correctly executed in accordance with the requirements of law and the regulations of this Bureau, is hereby accepted.

For the Director

Stephen D. Douglas
Chief Cadastral Surveyor
Eastern States

